

# SUITE

Design by Jordi Vilardell & Meritxell Vidal.

# VIBIA

## Reference

**6040.**

## Application

Wall Lamps

## Installation type

Surface

## Description

Suite is a wall lamp that boasts different functions, where matter and light are integrated in a single body. Suite houses a stand as well as LED lighting. Designed by Jordi Vilardell & Meritxell Vidal. Available in two finishes: dark brown and white.

## Diffuser

Shiny opal triplex blown-glass diffuser

## Materials

Body: Aluminum  
Diffuser: Polycarbonate  
Base: Steel

## Finish



**6040-14** Matt dark-brown lacquer (RAL 8019)



**6040-93** Matt white lacquer (RAL 9016)

## Sketch

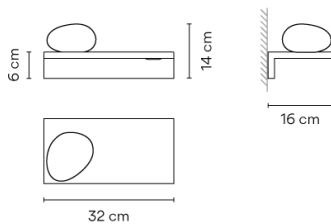

## Electrical characteristics

1 x LED 4,5W 350mA

Total 4.5 W



**Led** 2700K CRI >80 490 lm 109 lm/W

**Fixture:** 310 lm 69 lm/W

**Driver included:** CV - Contant Voltage 350 mA 220-240V 50Hz

**Electronic dimming** NO DIM

## Physical characteristics

1 Box / 0.29 x 0.38 x 0.38 m. / Vol. 0.0211 m<sup>3</sup> /

Gross weight 2.4 kg. / Net weight 2.2 kg.

## Installation and assembly

Please, see the installation manual

## Light distribution

### General lighting

Lamp for general lighting that equally distributes the light in all directions.

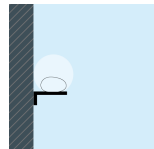

## Photometric data

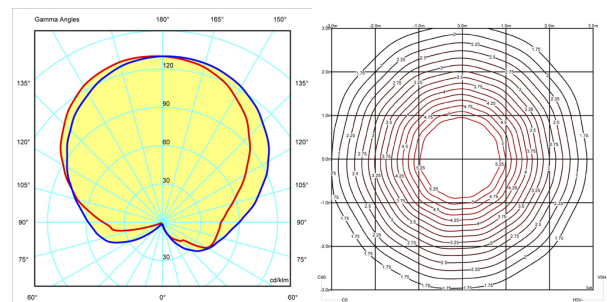

## Certificates

