

PALMA

Design by Antoni Arola.

VIBIA

Reference

3734.

Application

Hanging lamps

Installation type

Surface

Description

Nature takes control of the space. With the pendant lamps the interior ambience takes on a life of its own with the possibility of integrating plants with the lighting compositions.

Diffuser

Mat opal triplex blown-glass diffuser

Materials

Profile: Aluminum

Diffuser: Blown-glass

Flowerpot: PMMA (thermoplastic polymer)

Finish



3734-18 Matt graphite lacquer (ADAPTA RF 9913 WX)



3734-93 Matt white lacquer (RAL 9016)

Sketch

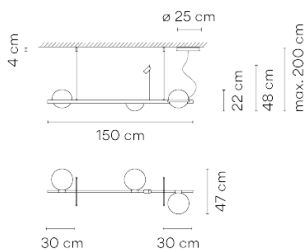

Led 2700K CRI >90 1829 lm 84 lm/W

Fixture: 1301.84 lm 51.54 lm/W

Driver included: CC - Constant Current 500 mA 110-240V 50/60Hz

Electronic dimming DALI 1-10V PUSH

Technical characteristics

- Plants not included

Physical characteristics

1 Box / 0.00 x 0.00 x 0.00 m. / Vol. 0.1790 m³ /

Gross weight 9.5 kg. / Net weight 6.0 kg.

Installation and assembly

Please, see the installation manual

Light distribution

General lighting

Lamp for general lighting that equally distributes the light in all directions.

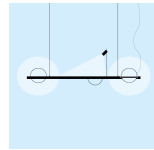

Photometric data

Efficiency : 1

Coordinate system : CG

Total flux : 1301.84 lm

Maximum value : 66.04 cd/klm

Light position : C=0.00 G=1.00

Symmetry on the planes : Asymmetric

Isolux : Isolux (Floor)

Light position :

X=0.00m Y=0.00m Z=2.50m

Certificates



Electrical characteristics

