

## OTTO CEILING

1T6332

LIGHT SOURCE **LED** COLOUR TEMPERATURE **4000K** POWER (SOURCE) **3W** CRI **84** BEAM ANGLE **SP-FL** OPTIC **ZOOM**  
 COLOUR AND FINISH **PLASTER WHITE** POWER SUPPLY **1050mA** DRIVER INCLUDED **NO** INSULATION CLASS **CLASS 3**  
 GLOBAL IP OR HOUSING **IP20** F CLASS **YES**



### CONCEPT

Adjustable LED micro-projector mounted on a base with an optical beam adjustment system.

### MATERIALS

Anodised or white painted aluminium body and painted metallic pole connected together with a balljoint that makes it possible to adjust the spotlight body from 0°-90° on the vertical plane and 330° on the horizontal plane. Blocking equipped with a friction system in the horizontal and vertical plane. Passive heat sink cooling system.

### SOURCE

High Efficiency LED Emitter Ra84.

### OPTIC

Optical beam adjustment system from 14° to 34° composed of a plano-convex lens and an adjustable front ring.

### INSTALLATION

Screw tightening mounting system with a metal base.

### POWER SUPPLY

To be completed with electronic driver. Pre-wired with 300mm of wire. 1050mA

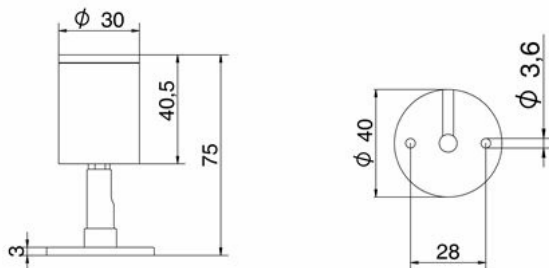

All the measures are expressed in mm

## Photometries

	4000K Ra84	H(m)	D(m)	E <sub>max</sub> (lx)
	Fixture Power 5W		14°	
	Source Flux 397lm	1	0.24	2220
	Fixture Flux 126lm	2	0.49	555
	Efficacy 25lm/W	3	0.73	247
	Imax 2220cd	4	0.98	139
		5	1.22	89

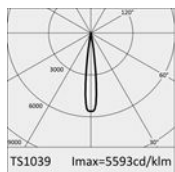

	4000K Ra84	H(m)	D(m)	E <sub>max</sub> (lx)
	Fixture Power 5W		34°	
	Source Flux 397lm	1	0.62	516
	Fixture Flux 151lm	2	1.23	129
	Efficacy 30lm/W	3	1.85	57
	Imax 517cd	4	2.46	32
		5	3.08	21

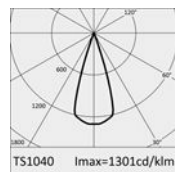

---

## Related Codes

### Electrical

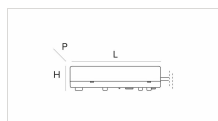

#### **1T6524**

---

##### **Power Supply**

Electronic power supply 42W,  
LxHxP=129x30x42mm, 220-240V-AC  
50-60Hz, 1050mA, IP20. Can drive  
simultaneously up to 12 OTTO 1x.  
OTTO Semi-Recessed: driver's size  
is bigger than the cutout hole  
needed by the luminaire.

---

## Accessory Codes

### Installation



#### **1T6528**

---

##### **Canopy**

Canopy for electrical connection Ø  
40mm H 18mm. Plaster white.