

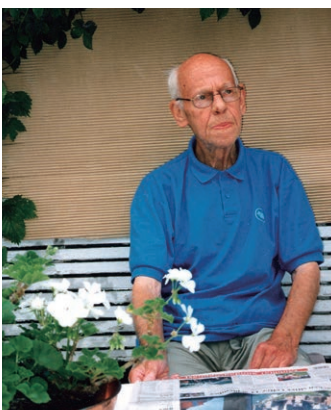

## JAKOBSSON LAMP

JAKOBSSON LAMP brings out the full potential of ingredients of pine wood and has lit up Scandinavian living for a long time as a representative of Swedish designer, Hans -Agne Jakobsson. The soft light casted through the pine wood shades is reminiscent of a bonfire.



*Designer*

### HANS-AGNE JAKOBSSON

Hans-Agne Jakobsson (1919-2009), a Swedish interior and furniture designer, born in Gotland, Sweden, is known for his glare-free lighting fixtures inspired by the idea of “Organic Modern” of Poul Henningsen and Alvar Aalto. He started designing at the age of 18 and later, he graduated as an architect in Göteborg. He began as an assistant to Carl Malmsten and Werner West known as the master of interior design. After he gained experience as a designer in several companies including General Motors, he founded his own lighting company “Hans-Agne Jakobsson AB” in Markaryd and started manufacturing light fixtures and furniture with his own design.

# JAKOBSSON LAMP



FE205:  $\phi$ 540

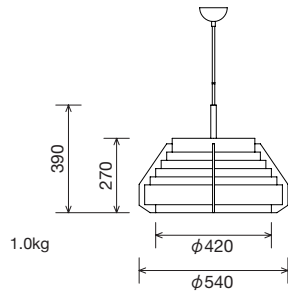

SUSPENSION

**CE** 220V-240V  
FE205  $\phi$ 540  
E27 LED White bulb 13Wx1

**PS E** 100V  
323F-217  $\phi$ 540  
E26 LED White bulb 13Wx1



FE206:  $\phi$ 440

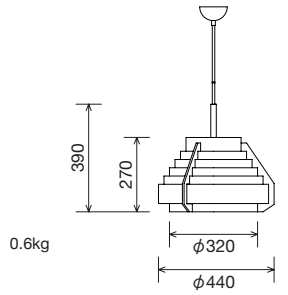

SUSPENSION

**CE** 220V-240V  
FE206  $\phi$ 440  
E27 LED White bulb 13Wx1

**PS E** 100V  
323F-218  $\phi$ 440  
E26 LED White bulb 13Wx1



SE169:  $\phi$ 360

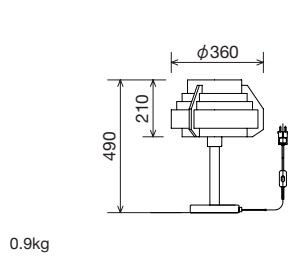

TABLE

**CE** 220V-240V  
SE169  $\phi$ 360  
E27 LED White bulb 13Wx1

**PS E** 100V  
323S7339  $\phi$ 360  
E26 LED White bulb 13Wx1



SE170:  $\phi$ 260

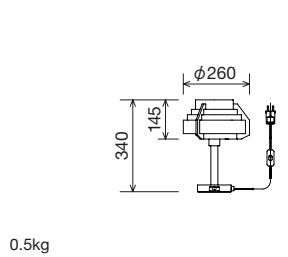

TABLE

**CE** 220V-240V  
SE170  $\phi$ 260  
E14 LED White bulb 6Wx1

**PS E** 100V  
323S2904  $\phi$ 260  
E17 LED White bulb 6Wx1



SE168

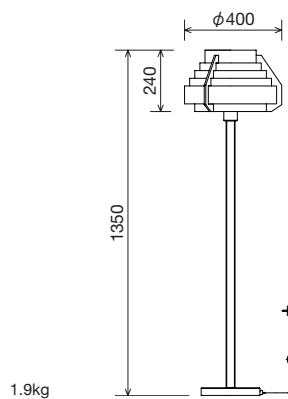

FLOOR

**CE** 220V-240V  
SE168  
E27 LED White bulb 13Wx1

**PS E** 100V  
323S7338  
E26 LED White bulb 13Wx1