

BREMERHAVEN LED m1200, HT

3800 lm, 30 W, PC Tropol® (fracture proof), wide beam

Item Number: 596 480 44 84

LED

IP 65 IP 66 IP 67 IP 68 1m CE   IK 09 PC

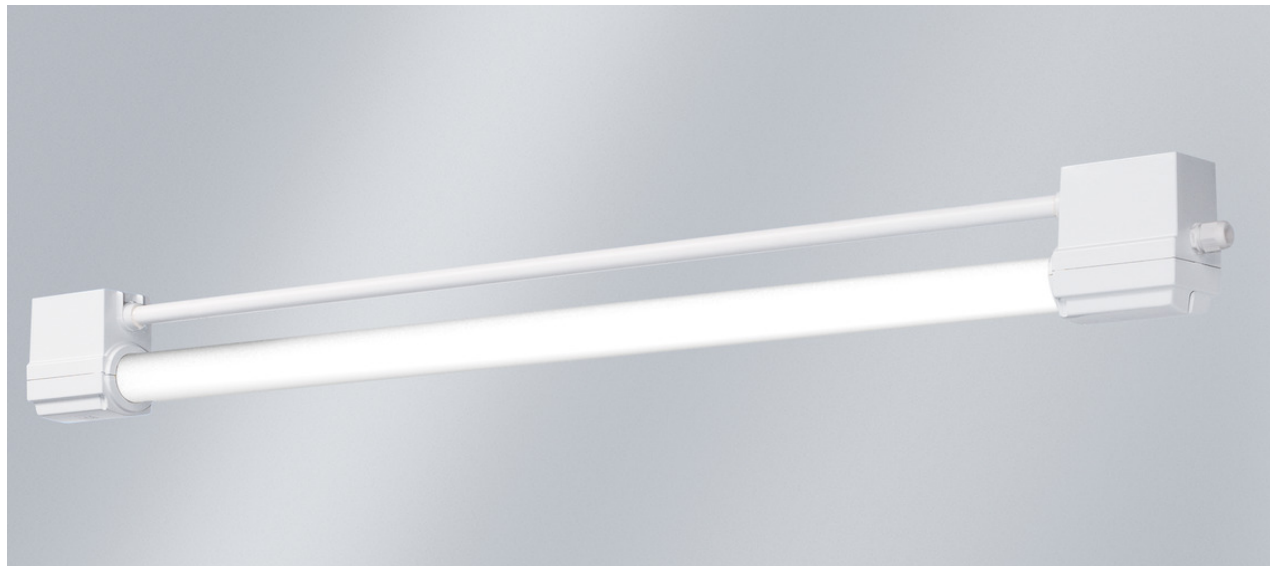

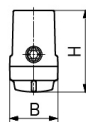

Illustration may differ

 wide beam

DIMENSIONS



L	1.432 mm
B	77 mm
H	129 mm
a	1.005 mm
max. Weight	2,0 kg

DESCRIPTION

Polymer luminaire with LED lamps. Useable in industrial applications with demanding ambient conditions. Suitable for production facilities and suppliers in the food and beverages industry. **Heat-resistant (high temperature (HT)) version suitable for temperatures up to +60 °C, highly heat-resistant (very high-temperature (VHT)) version suitable for temperatures up to +90 °C.** Weatherproof luminaire housing made of thermosetting polymer. Useable for indoor and outdoor areas according to protection rating IP 65, IP 66, IP 67 and IP 68, 1 m. Thermally separated lamp chamber and driver chamber. Short sealing system consisting of age-resistant, form-retaining silicone/synthetic rubber. Protection tube 38 mm made of PC Tropol® (fracture proof). Luminaire ready for mounting and installation. Two M20 cable glands on face side. Single or row mounting (HT version only). Ceiling installation using two polymer stirrup clamps, variable mounting distance.

Version HT

With built-in driver 230 V AC/DC and 4 x 1.5 mm² through wiring.

BREMERHAVEN LED m1200, HT

3800 lm, 30 W, PC Tropol® (fracture proof), wide beam

Item Number: 596 480 44 84

CHARACTERISTICS

Version	m1200, HT	Housing material	polymer
Lamp	LED	Colour housing	White
Number of lamps	1-lamp	Cover	protection tube
Luminous flux lamp	3800 lm	Material of the cover	PC Tropol® (fracture proof)
LOR	95 %	Light distribution	wide beam
Luminous flux luminaire	3629 lm	Adjustability	not adjustable
max. System power	30 W	UGR Value (4H8H)*	25
Luminaire efficacy	121 lm/W	Protection class	II
Colour temperature	White, 840/4000 K, Ra > 80	IP-rating	IP66, IP67, IP68 1m, IP65
Colour consistency (McAdam ellipse)	SDCM3	Impact strength	IK09
Lamp service life	L80 B50 > 100,000 h at +60°C	Manufacturer warranty	5 years
Ambient temperature	-25°C to +60°C	Installation type	ceiling mounting, suspension system, Surface mounting, single mounting, wall mounting, row mounting
Type of gear	driver Industry, No dim function, 230 V - 240 V AC/DC, 0/ 50/ 60 Hz	Replaceability of control gear	control gear replaceable by professional
Transient protection	2 kV	Replaceability of light unit	Protection tube replaceable by professional
Max. number of luminaires Circuit breaker B16	25		
Max. Number of luminaires Circuit breaker C16	40		
Connection method	cable gland M20		
Through-wiring	4 x 1.5 mm²		
Terminals	4 pole		
Pole identification	L2, L3, N, L1		

* The above mentioned UGR is based on example calculations. The effective value can only be determined with a light calculation.

DIAGRAMS

