

LIGHT SOURCE

LED quantity	1
Power max	6 W – 9 W
Total lumen output (3000K)	314 lm – 388 lm
Efficacy lm/W (3000K)	52 lm/W – 43 lm/W
LOR (3000K)	57% - 52%
CRI	>80 - >90
LED Temperature (K)	2700 K- 3000 K- 3000 K CRI>90- 4000 K- 5000 K
Average operational life	50.000 hours



OPTIC

Material	PMMA
Available optics	3°-10°-30°
Beam direction	djustable +/-60°, Rotating +/-360°
Flux symmetry	Symmetrical
Accessories	-

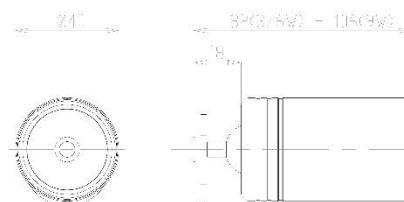

LED FIXTURE

Material	Aluminum
Finish	Aluminum Hard Coat Anodizing (Gray, Black, Titanium, Champagne Gold)
Available finishes	Gray, Black, Titanium, Champagne Gold
IP Rate	IP40
Working Temperature	-20° ÷ +40°
Accessories	-

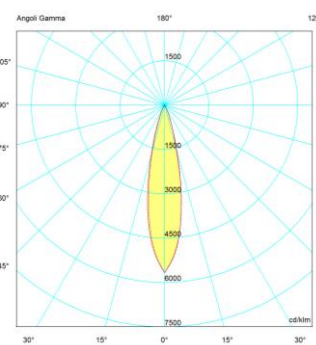

9W

ELECTRICAL FEATURES

Driver	Remote
Dimmable	Push, 1-10V, DALI
For emergency lighting	Upon request
Connection in	In series at 500mA – 700mA
Class	III

MECHANICAL FEATURES

Dimensions (mm)	Ø40 x 82 (106 mm - 9W)
Weight	130 gr (6W) – 140 gr (9W)
Mounting	Wall, Ceiling, Floor
Cut-out (mm)	See notes
Use	Indoor

H(m)	D(m)	E _{max} (lx)	E _{av} (lx)
30°			
1.00	0.40	2193	1354
2.00	0.80	548	339
3.00	1.20	244	150
4.00	1.60	137	85
5.00	2.00	88	54

NOTES

Fixing elements:

