

September 2012

MaxiWoody - Small floodlight with monochromatic LED warm white - spot optic**Product code:**

BB29

Technical description:

Adjustable floodlight for exterior lighting designed for use of monochromatic LED sources, Spot (S) optic. Die-cast aluminium body with liquid acrylic paint finish provided with closing frame. The frame is provided with glass with customised grey serigraphy and silicone in the front to ensure water tightness against water penetration. Suitable slots on the frame allow for downflow of rainwater. Complete with 36 Warm White (3100K) monochromatic LEDs, Spot (S) optics with plastic lense, and built-in electronic ballast. The luminaire is provided with double nickel-plated brass cable clamp (M24x1,5) (suitable for \varnothing 7÷16mm cables) for through wiring. Maxi Woody can be oriented on the vertical plane by means of a bracket with 10°-step graduated scale, with mechanical locks that ensure stable pointing of the light flow. The luminaire is oriented on the horizontal plane by means of a hot galvanised painted plate for ground installation; in addition to ground installation, wall-mounting with fischer screws is possible. The iGuzzini assembly and maintenance protocol simplifies the installation. The decompression valve provides easy access to the optical assembly by eliminating the internal negative pressure. Painting is carried out with acrylic (maximum protection against UV) liquid (maximum protection against weather agents) paint.

Installation:

The fitting can be installed in ground or wall by means of a support bracket fitted with fischer screws.

Dimension:

D 315 mm - L 319 mm - H 358 mm

Colour:

Grey (15)

Mounting:

Ground anchored|U-bracket|Wall arm|Wall surface

Wiring:

Luminaire provided with built-in electronic control gear.

Notes:

Available accessories: visor, barndoors, protection grid and ground anchoring plate.

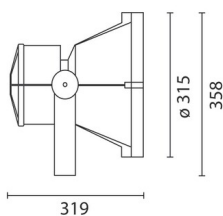

Complies with EN605981 and pertinent regulations

