

PLUXO

10-06-2015

1.0 LED111

LED 13W | 220-240V | 50-60Hz | AC-COB 3-step | phase-cut dim

CE IP20 960° 0,3m P 38° 45°/45° 45°/45°

white texture
silver / grey
black texture

143168W_
143168S_
143168B_

OPTIONAL

2700K | >80CRI | 640lm
3000K | >80CRI | 680lm

2
4

ceiling base dimensions

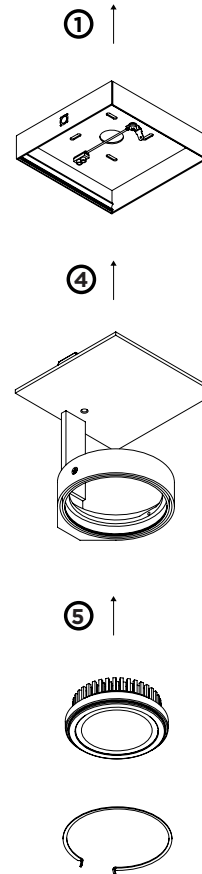
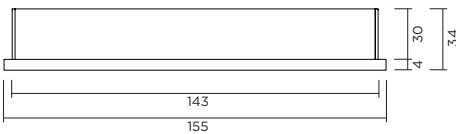
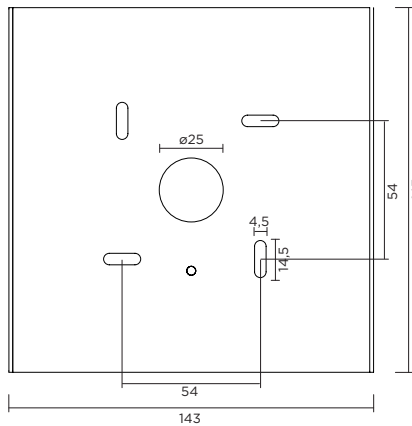

DIMENSIONS

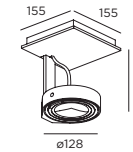

MOUNTING INSTRUCTION

- 1 Mount the ceiling base to the ceiling with screws

POWER CONNECTION

- 2 Connect the earthing wire to the slider on the ceiling base.

PARALLEL CONNECTION

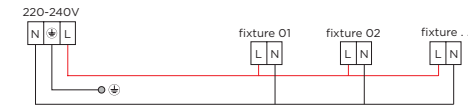

- 3 Connect the LED module
- 4 Click the PLUXO on the ceiling base
- 5 Insert the lamp in lampring and fix with spring



WEVER & DUCRÉ
LIGHTING

www.weverducre.com

INSTALLATION
INSTRUCTIONS