

EYE

07-12-2015

1.0

LED 1/2W | 350-700mA | 3Vf | PCB 3-step | excl. power supply

CE < > IP20 960° C 0,3m

3000K | >80CRI | 90-150lm

white texture
aluminium brushed

302151W4
302151L4

ALWAYS USE
for power supplies see our catalogue

OPTIONAL
recessed housing

90012025

2.0

LED 1/2W | 350-700mA | 3Vf | PCB 3-step | excl. power supply

CE < > IP20 960° C 0,3m

3000K | >80CRI | 90-150lm

white texture
aluminium brushed

302251W4
302251L4

ALWAYS USE
for power supplies see our catalogue

OPTIONAL
recessed housing

90012025

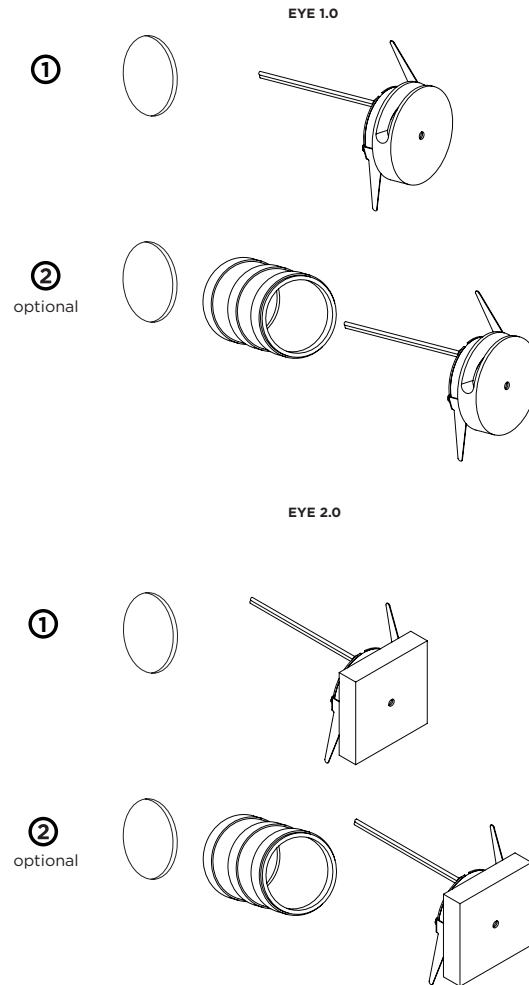

DIMENSIONS



MOUNTING INSTRUCTION

- 1 Make a hole in the wall according to the prescribed dimensions
- 2 OPTIONAL: Insert the EYE in the hole by using a recessed housing*. When using the recessed housing, the recessed dimension and the cut out dimension will be different.



POWER CONNECTION

- 3 Connect wiring to the power supply (for LED) or to terminal block (for PAR16)
interior connection: STANDARD version
exterior connection: WATERPROOF version (only for LED)

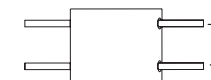

Always use POWER SUPPLY

- 4 Insert the EYE in the hole



WEVER & DUCRÉ
LIGHTING

www.weverducre.com

**INSTALLATION
INSTRUCTIONS**