

CENTRAL

10-Feb.-2017

1.0

LED 6W | 220-240VAC | 50-60Hz | COB 3-step | incl. PS | phase-cut dim

CE \oplus IP20 \varnothing 0.3m \odot ∇ Δ

3000K | >80CRI | 470lm

white texture
aluminium brushed

313374W4
313174L4

2.0

LED 2xLED 3W | 220-240VAC | 50-60Hz | COB 3-step | incl. PS | phase-cut dim

CE \oplus IP20 \varnothing 0.3m \odot ∇ Δ

3000K | >80CRI | 2x290lm

white texture
aluminium brushed

313474W4
313274L4

back plate dimensions

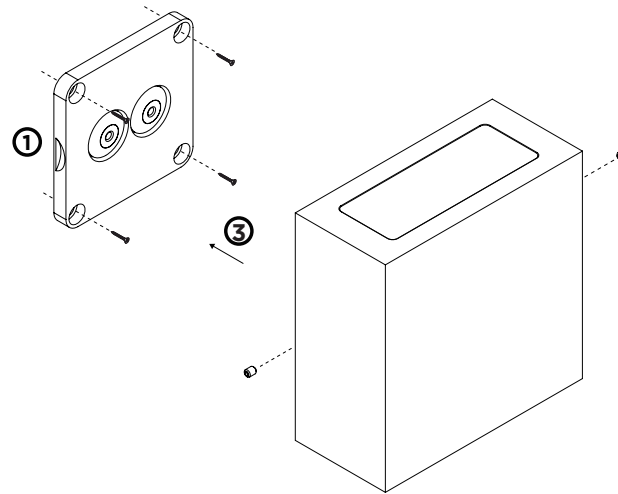
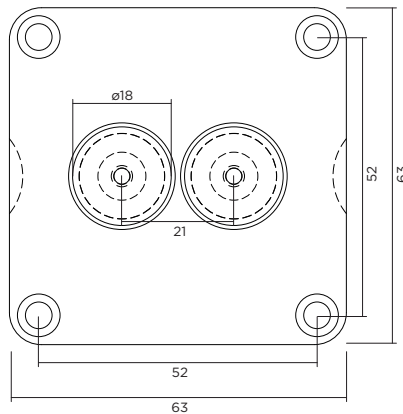

DIMENSIONS

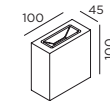

CENTRAL 1.0

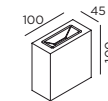

CENTRAL 2.0

MOUNTING INSTRUCTION

- 1 Remove the back plate and fixate it to the wall with screws

POWER CONNECTION

- 2 Connect the power supply.

Interior: STANDARD version

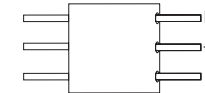

Mounting method of cable through the back plate:

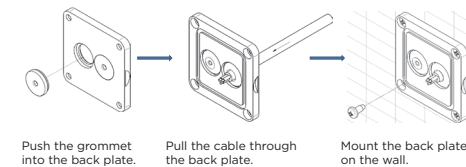

- 3 Fixate the fixture base to the back plate with the side screws



WEVER & DUCRÉ
LIGHTING

www.weverducre.com

Wever & Ducre bvba Kwadestraat 153 bus 2.1 8800 Roeselare

**INSTALLATION
INSTRUCTIONS**

PAGE 1/2

PB19-010-359-00

CENTRAL

10-Feb.-2017

1.0

LED 6W | 220-240VAC | 50-60Hz | COB 3-step | incl. PS | phase-cut dim

CE IP65 0.3m

3000K | >80CRI | 470lm

white texture

dark grey texture

313174W4

313174D4

2.0

LED 2xLED 3W | 220-240VAC | 50-60Hz | COB 3-step | incl. PS | phase-cut dim

CE IP65 0.3m

3000K | >80CRI | 2x290lm

white texture





dark grey texture

313274W4

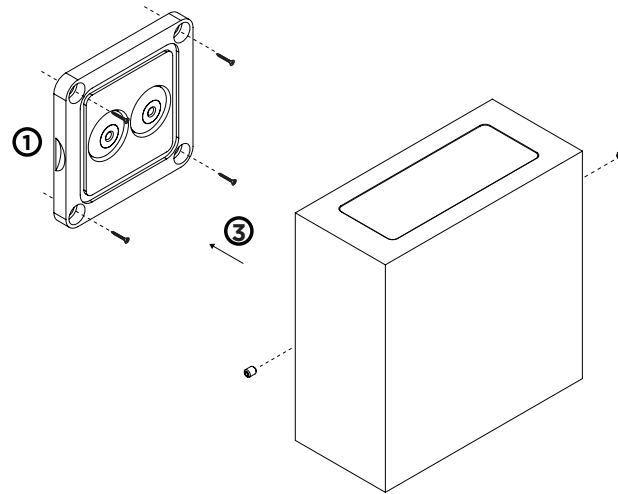
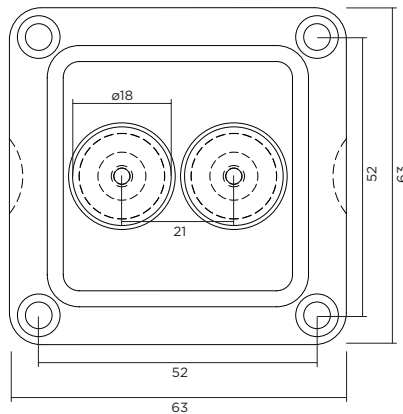
313274D4

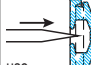
back plate dimensions

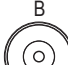
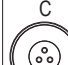
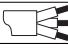
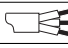

	A	B	C
			
CABLE			
TYPE	ROUND H05RN-F H07RN8-F H07RN-F	ROUND H05RN-F	ROUND
OUTSIDE Ø	min 6.8mm max 8.9mm	min 5mm max 6.8mm	min 1.5mm max 2.6mm
CONDUCTION SECTION	2or3x 0.75mm ² 2or3x 1.0mm ² 2or3x 1.5mm ²	2or3x 0.75mm ² 2x 1.0mm ²	0.75mm ² 1.5mm ²

DIMENSIONS

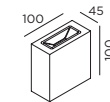

CENTRAL 1.0

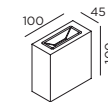

CENTRAL 2.0

MOUNTING INSTRUCTION

- 1 Remove the back plate and fixate it to the wall with screws

POWER CONNECTION

- 2 Connect the power supply.

Interior: STANDARD version

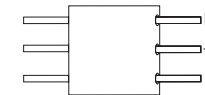

Exterior: WATERPROOF Connection

IP-rated connections for wall fixtures: cable isolation for round cables \varnothing 4.5-7.5 mm, should be in the grommet. For cable use \varnothing 7.0-9.5 mm: replace the grommet with the other grommet in the bag.

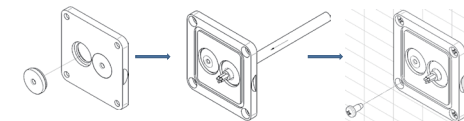

Push the grommet into the back plate.

Pull the cable through the back plate.

Mount the back plate on the wall.

- 3 Fixate the fixture base to the back plate with the side screws



WEVER & DUCRÉ
LIGHTING

www.weverducre.com

Wever & Ducre bvba Kwadestraat 153 bus 2.1 8800 Roeselare

**INSTALLATION
INSTRUCTIONS**

PAGE 2/2