

# BISHOP

17-Nov.-2017

## 4.0

E27 LED max. 25W | E27 | 220-240VAC | 50-60Hz

CE IP20 0.9m

white texture	218100W0
dark grey texture	218100D0
black texture + gold	218100K0

for lamps see our catalogue

## 6.0

E27 LED max. 25W | E27 | 220-240VAC | 50-60Hz

CE IP20 0.9m

white texture	218200W0
dark grey texture	218200D0
black texture + gold	218200K0

for lamps see our catalogue

### ALWAYS USE

CABLE SUSPENSION SET (2m) - Red cable	90015118
CABLE SUSPENSION SET (2m) - Black cable	90015119
CABLE SUSPENSION SET (2m) - White cable	90015120
CABLE SUSPENSION SET (6m) - Red cable	90015126
CABLE SUSPENSION SET (6m) - Black cable	90015127
CABLE SUSPENSION SET (6m) - White cable	90015128

## 8.0

E27 LED max. 25W | E27 | 220-240VAC | 50-60Hz

CE IP20 0.9m

white texture	218300W0
dark grey texture	218300D0
black texture + gold	218300K0

for lamps see our catalogue

### ALWAYS USE

CABLE SUSPENSION SET (2m) - Red cable	90015121
CABLE SUSPENSION SET (2m) - Black cable	90015122
CABLE SUSPENSION SET (2m) - White cable	90015123
CABLE SUSPENSION SET (6m) - Red cable	90015129
CABLE SUSPENSION SET (6m) - Black cable	90015130
CABLE SUSPENSION SET (6m) - White cable	90015131

baldachin dimensions

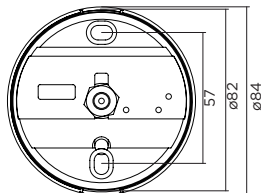

## Parts list of CABLE SUSPENSION SET:

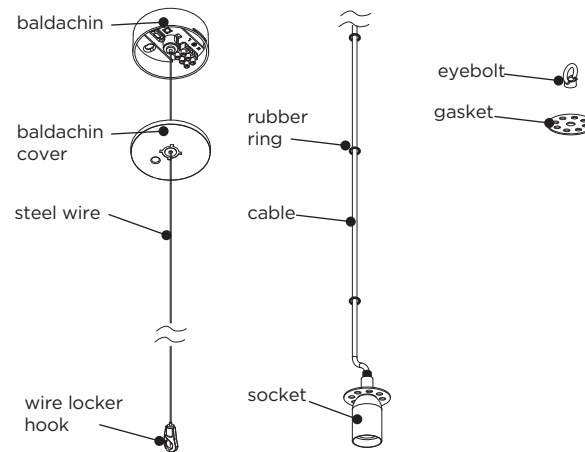

## DIMENSIONS

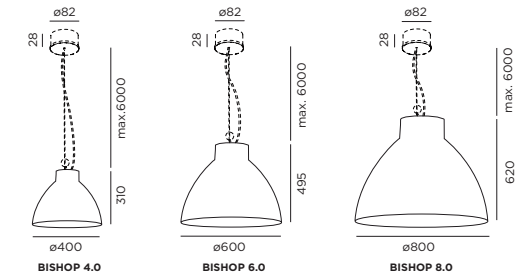

## MOUNTING INSTRUCTION

① Mount the socket at the shade. ( refer to steps: a, b, c, & d )

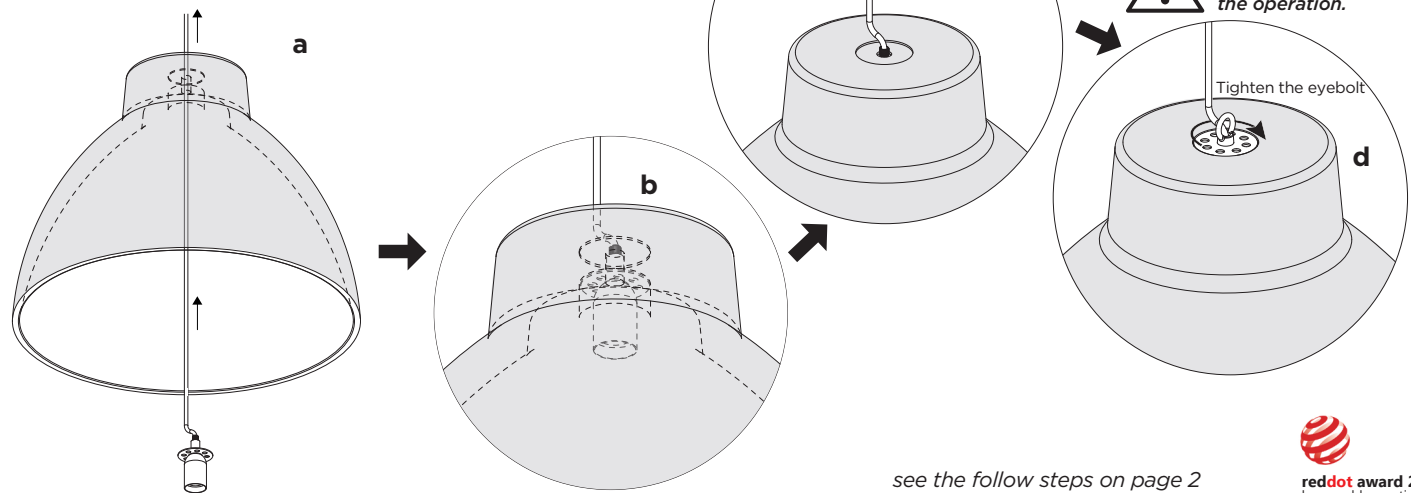

see the follow steps on page 2



# BISHOP

17-Nov.-2017

- ② Fix the baldachin to the ceiling with screws.

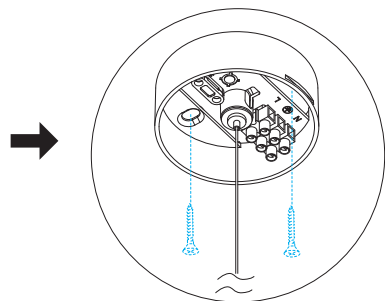

- ③ Loose steel wire from the wire locker hook.

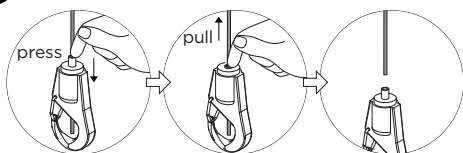

- ⑤ Insert the steel wire back into the wire locker hook. And then hang the hook on the eyebolt.

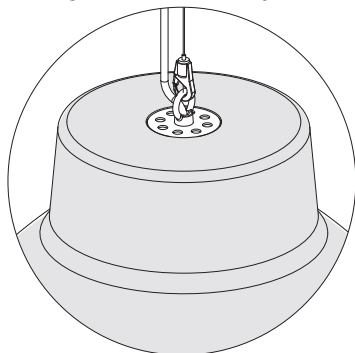

*Note: It is mandatory to fix the cable tightly with the strain relief.*

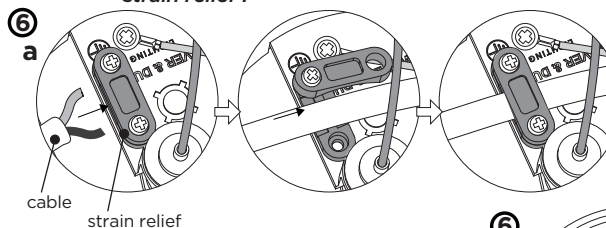

- ④ Let the steel wire through the rubber rings that attached on the cable.

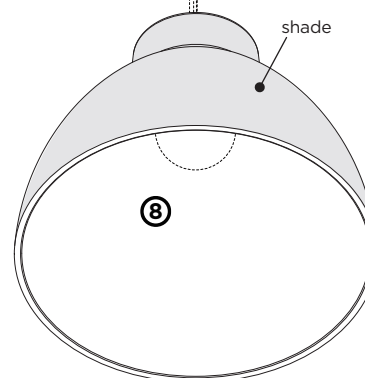
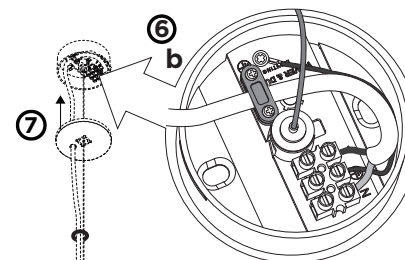
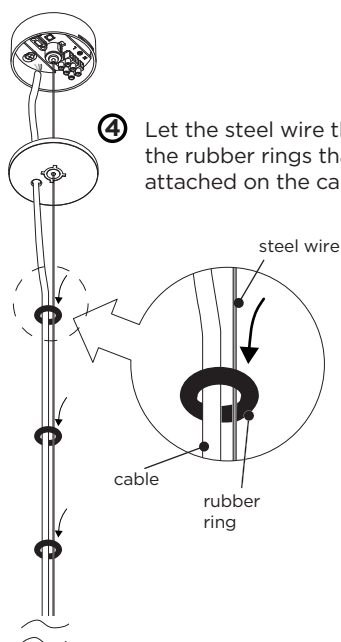

## POWER CONNECTION

- ⑥ Interior: STANDARD connection ( refer to steps: a&b )

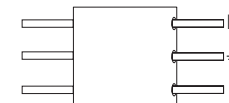

Baldachin earthing connection:



- ⑦ Adjust cable length if necessary and close the baldachin with the cover.

- ⑧ Insert lamp (MAX. 25W), lamp is not included.



**WEVER & DUCRÉ**  
LIGHTING

[www.weverducre.com](http://www.weverducre.com)

Wever & Ducre bvba Kwadestraat 153 bus 2.1 8800 Roeselare

**INSTALLATION  
INSTRUCTIONS**

PAGE 2/2

 **reddot award 2015**  
honourable mention