

JELI floor

15-Feb.-2017

1.0

LED 8W | 220-240VAC | 50-60Hz | PCB 3-step | incl. PS | phase-cut dim

CE IP65 0.3m

3000K | >80CRI | 480lm

black texture
dark brown texture

743163B4

743163Y4

2.0

LED 13W | 220-240VAC | 50-60Hz | PCB 3-step | incl. PS | phase-cut dim

CE IP65 0.3m

3000K | >80CRI | 710lm

black texture
dark brown texture

743143B4

743143Y4

OPTIONAL

black pole including spike L200
dark brown pole including spike L200
black pole including spike L400
dark brown pole including spike L400
black pole including spike L600
dark brown pole including spike L600
black pole including spike L800
dark brown pole including spike L800
ground fix mounting plate_black
ground fix mounting plate_dark brown

910082B0

910082Y0

910084B0

910084Y0

910086B0

910086Y0

910088B0

910088Y0

90019019

90019020

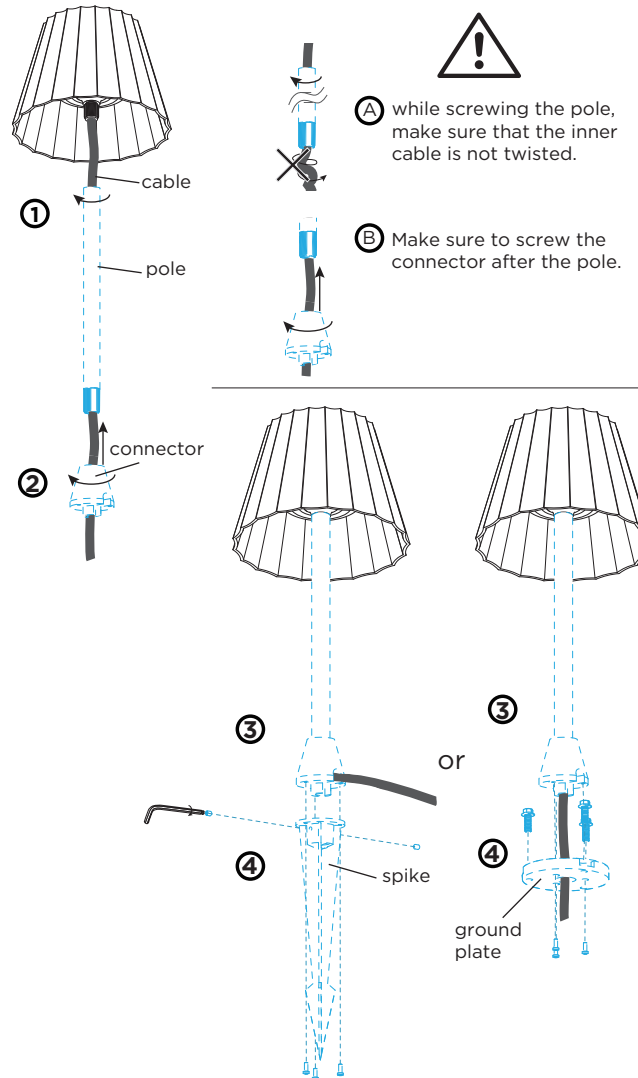

DIMENSIONS

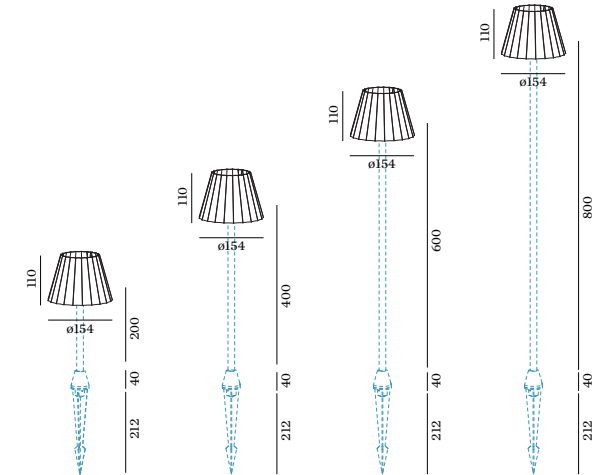

MOUNTING INSTRUCTION

- Let the cable through the pole, then screw the luminaire and the pole together.
- Go on to let the cable through the connector. And screw the pole and the connector together.
- Fix the connector on the spike with 3 screws, and reinforce with 2 allen screws; while the cable through the gap on the connector side.
Or fix the connector on the ground plate with 3 screws.
- Insert the spike into the ground.
Or fix the ground plate on the floor with 3 screws.
- POWER CONNECTION**
Connect the wires with the waterproof connections.

