

## UT PRO 175 GA-69 ON BOARD DIMMER INCLUDED

<b>Number of heads</b>	1
<b>Mounting</b>	Track mounting GA
<b>Lamps description</b>	LED Array 35,3W 3400 lm 4000K CRI 90
<b>Luminaire luminous flux</b>	See reference number
<b>Voltage (V)</b>	120/270
<b>Environment</b>	Indoor
<b>Notes</b>	Screening crosspiece, lenses and honeycomb directly installable on the head of the luminaire without needing any fastening accessory. Installation compatible with honeycomb + lense at the same time.



### OPTICAL

<b>Reflector finish</b>	Borosilicate glass reflector
<b>Aiming</b>	Adjustable
<b>Light distribution symmetry</b>	Symmetric
<b>Beam angle</b>	12° Spot

### UT Pro 175 GA-69 On Board Dimmer Included

designed by FLOS Architectural

Spotlight to be installed in standard 3-phase track with LED light source. 120-270V power supply integrated.< nextline>

### ELECTRICAL

<b>Transformer availability</b>	Included
<b>Transformer mounting</b>	Integral
<b>Transformer type</b>	Electronic dimmable
<b>Emergency</b>	Without
<b>Insulation class</b>	Class I

- 09.7312.40 - 3245lm White
- 09.7312.14 - 3245lm Black

### PHYSICAL

<b>Spot diameter (mm)</b>	75
<b>Construction material</b>	Aluminium

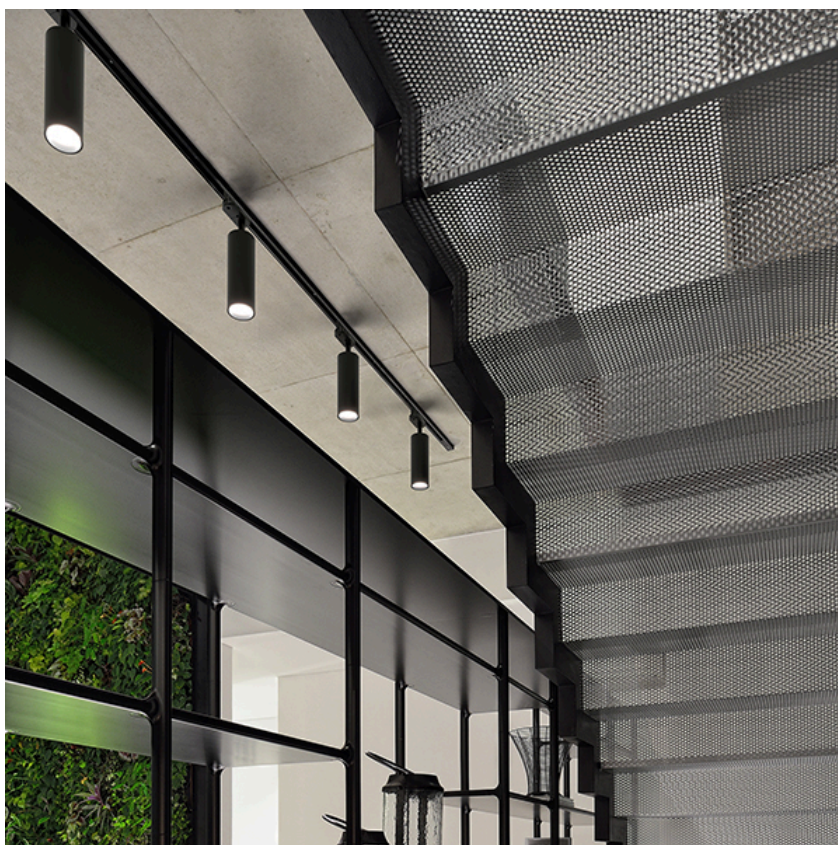
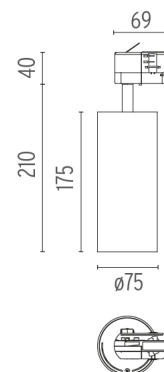

### CERTIFICATIONS

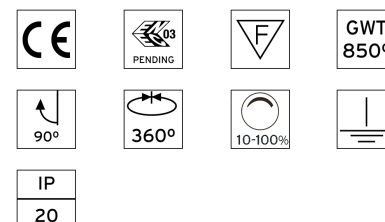

## UT Pro 175 GA-69 On Board Dimmer Included . Accessories

### Optical



● 08.9108.00

**Screening Crosspiece**



○ 08.9109.00

**Elliptical Lens**



○ 08.9110.00

**Flood Lens**



● 08.9107.00

**Honeycomb**



● 08.9111.00

**Snoot Shielding Cone**



### UT Pro 175 GA-69 On Board Dimmer Included

designed by FLOS Architectural

Spotlight to be installed in standard 3-phase track with LED light source. 120-270V power supply integrated.<nextline>

- 09.7312.40 - 3245lm White
- 09.7312.14 - 3245lm Black

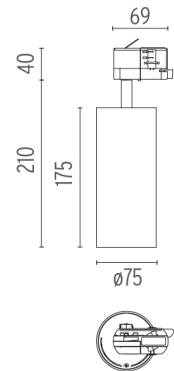

### CERTIFICATIONS



## UT Pro 175 GA-69 On Board Dimmer Included . Lamps



**LED Array**

**Lamp category:**

LED

**Socket:**

Special base

**Lamp type:**

LED Array



**UT Pro 175 GA-69 On Board Dimmer Included**

designed by FLOS Architectural

Spotlight to be installed in standard 3-phase track with LED light source. 120-270V power supply integrated.< nextline>

- 09.7312.40 - 3245lm    White
- 09.7312.14 - 3245lm    Black

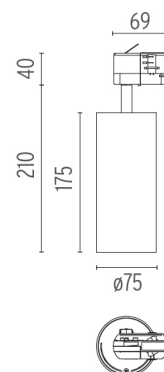

**CERTIFICATIONS**

