

## PURE | SPOT CEILING

<b>Number of heads</b>	1
<b>Mounting</b>	Ceiling surface
<b>Lamps description</b>	LED Array 17,5W 2115 lm 3000K CRI 80
<b>Luminaire luminous flux</b>	Extreme Cut-off. See reference number
<b>Voltage (V)</b>	220/240
<b>Environment</b>	Indoor

### OPTICAL

<b>Light controller description</b>	Protection glass
<b>Reflector finish</b>	Aluminum
<b>Aiming</b>	Adjustable
<b>Light distribution symmetry</b>	Symmetric
<b>Beam angle</b>	40° Flood

### ELECTRICAL

<b>Transformer availability</b>	Included
<b>Transformer mounting</b>	Integral
<b>Transformer type</b>	Electronic
<b>Emergency</b>	Without
<b>Insulation class</b>	Class I

### PHYSICAL

<b>Width (mm)</b>	180
<b>Spot diameter (mm)</b>	86
<b>Construction material</b>	Aluminium
<b>Weight (kg)</b>	1,20



### Pure I Spot Ceiling designed by Knud Holscher

Projector for mounting in ceiling/ wall with LED light source. 220- 240V, 50-60Hz power supply included.

● 09.2576.30A - 1632lm	White
● 09.2576.02A - 1632lm	Grey
● 09.2576.14A - 1632lm	Black

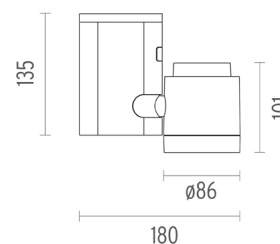

### CERTIFICATIONS



## Pure I Spot Ceiling . Accessories

### Optical



08.8166.14

#### Holding ring



08.8163.68

#### Elliptical lens

Elliptical light distribution lens in 4 mm thick tempered glass.



08.8169.14

#### Honeycomb

"Honeycomb" anti-glare screen: in thin, blackpainted aluminium sheets.



### Pure I Spot Ceiling designed by Knud Holscher

Projector for mounting in ceiling/ wall with LED light source. 220- 240V, 50-60Hz power supply included.

- 09.2576.30A - 1632lm White
- 09.2576.02A - 1632lm Grey
- 09.2576.14A - 1632lm Black

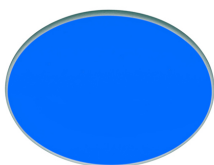

08.8160.64.OD

#### Blue filter

Blue filter

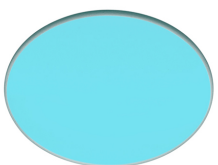

08.8160.65.OD

#### Sky blue filter

Sky blue filter

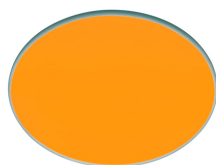

08.8160.66.OD

#### Amber filter

Amber filter

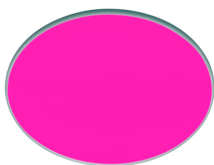
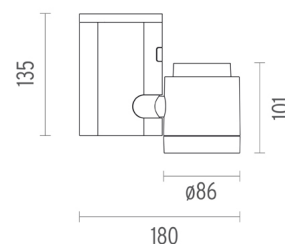

08.8160.67.OD

#### Red filter

Red filter



08.8160.98.OD

#### U.V. filter

U.V. filter



08.8160.68

#### I.R. filter

I.R. filter

### CERTIFICATIONS



## Pure I Spot Ceiling . Accessories



08.8160.69

### Hot Light

Hot Light

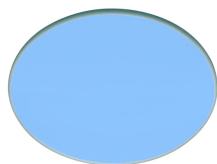

08.8160.CL

### Cold light filter

Cold light filter

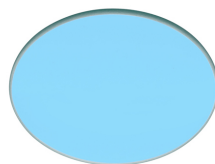

08.8160.DL

### Daylight filter

Daylight filter



### Pure I Spot Ceiling designed by Knud Holscher

Projector for mounting in ceiling/ wall with LED light source. 220- 240V, 50-60Hz power supply included.



08.8160.ND

### Neodimium



08.8175.68

### Flood lens

Flood lens made in press glass.



08.8232.30

08.8232.02

08.8232.14

### Pure I Pro external ring accessory

Pure I Pro external ring accessory. Only for halogen and halide lamps, consult for LED version

- 09.2576.30A - 1632lm White
- 09.2576.02A - 1632lm Grey
- 09.2576.14A - 1632lm Black

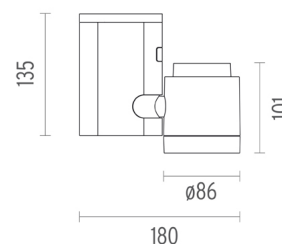

### CERTIFICATIONS



## Pure I Spot Ceiling . Lamps

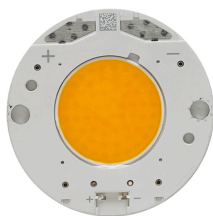

### LED Array

### Lamp category:

LED

### Socket:

Special base

### Lamp type:

LED Array



### Pure I Spot Ceiling

designed by Knud Holscher

Projector for mounting in ceiling/ wall with LED light source. 220- 240V, 50-60Hz power supply included.

●	09.2576.30A - 1632lm	White
●	09.2576.02A - 1632lm	Grey
●	09.2576.14A - 1632lm	Black

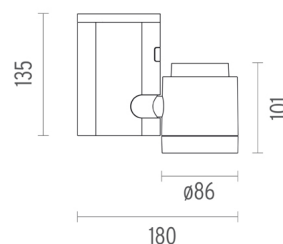

### CERTIFICATIONS

