

FLOS

PURE | SPOT PRO CEILING

Number of heads	1
Mounting	Ceiling surface
Lamps description	Phosphor LED 17W 1400 lm 3000K CRI 98
Luminaire luminous flux	Extreme Cut-off. See reference number
Voltage (V)	220/240
Environment	Indoor

OPTICAL

Reflector finish	Aluminum
Aiming	Adjustable
Light distribution symmetry	Symmetric
Beam angle	20° Spot

ELECTRICAL

Transformer availability	Included
Transformer mounting	Integral
Transformer type	Electronic
Emergency	Without
Insulation class	Class I

PHYSICAL

Width (mm)	180
Spot diameter (mm)	86
Construction material	Aluminium
Weight (kg)	1,40



Pure I Spot Pro Ceiling designed by Knud Holscher

Spotlight to be installed on ceiling/
wall. Electronic transformer 220/240,
50/60Hz for phosphor LED
integrated. LED integrated.

● 09.2470.30C - 488lm	White
● 09.2470.02C - 488lm	Grey
● 09.2470.14C - 488lm	Black

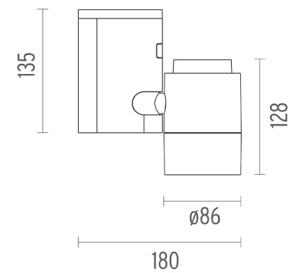

CERTIFICATIONS

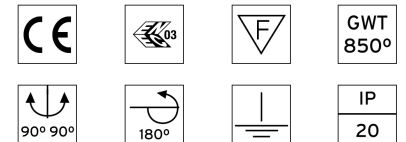

Pure I Spot Pro Ceiling . Accessories

Optical



08.8163.68

Elliptical lens

Elliptical light distribution lens in 4 mm thick tempered glass.

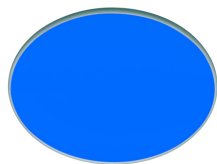

08.8160.64.OD

Blue filter

Blue filter

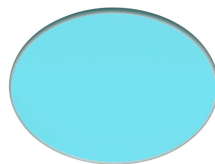

08.8160.65.OD

Sky blue filter

Sky blue filter



Pure I Spot Pro Ceiling designed by Knud Holscher

Spotlight to be installed on ceiling/wall. Electronic transformer 220/240, 50/60Hz for phosphor LED integrated. LED integrated.

- 09.2470.30C - 488lm White
- 09.2470.02C - 488lm Grey
- 09.2470.14C - 488lm Black

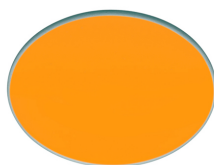

08.8160.66.OD

Amber filter

Amber filter

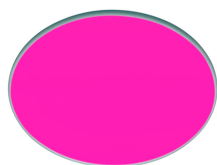

08.8160.67.OD

Red filter

Red filter



08.8160.98.OD

U.V. filter

U.V. filter

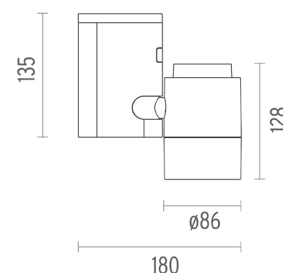

08.8160.68

I.R. filter

I.R. filter



08.8160.69

Hot Light

Hot Light

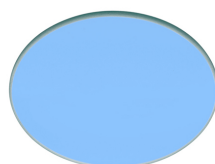

08.8160.CL

Cold light filter

Cold light filter

CERTIFICATIONS

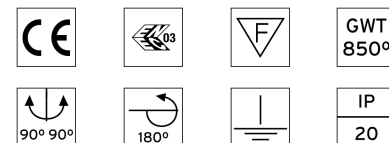

Pure I Spot Pro Ceiling . Accessories

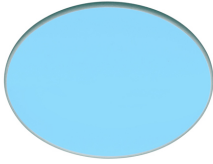

08.8160.DL

Daylight filter

Daylight filter

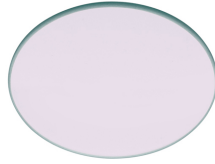

08.8160.ND

Neodymium



08.8175.68

Flood lens

Flood lens made in press glass.



Pure I Spot Pro Ceiling designed by Knud Holscher

Spotlight to be installed on ceiling/wall. Electronic transformer 220/240, 50/60Hz for phosphor LED integrated. LED integrated.

- 09.2470.30C - 488lm White
- 09.2470.02C - 488lm Grey
- 09.2470.14C - 488lm Black



08.8186.14

Honeycomb

Anti-glare grid in aluminium cells with black liquid paint finish.

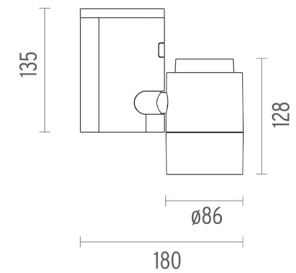

CERTIFICATIONS

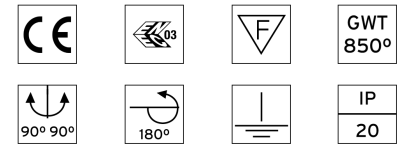

Pure I Spot Pro Ceiling . Lamps



Phosphor LED

Lamp category:
LED

Lamp type:
Phosphor LED



Pure I Spot Pro Ceiling designed by Knud Holscher

Spotlight to be installed on ceiling/
wall. Electronic transformer 220/240,
50/60Hz for phosphor LED
integrated. LED integrated.

- 09.2470.30C - 488lm White
- 09.2470.02C - 488lm Grey
- 09.2470.14C - 488lm Black

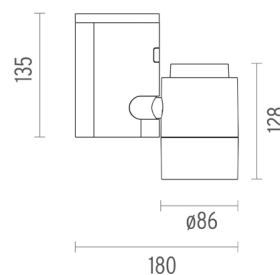

CERTIFICATIONS

