

PURE I SPOT CEILING

Number of heads	1
Mounting	Ceiling surface
Lamps description	Phosphor LED 17W 1400 lm 3000K CRI 98
Luminaire luminous flux	Extreme Cut-off. See reference number
Voltage (V)	220/240
Environment	Indoor



OPTICAL

Light controller description	Protection glass
Reflector finish	Aluminum
Aiming	Adjustable
Light distribution symmetry	Symmetric
Beam angle	46° Flood

Pure I Spot Ceiling designed by Knud Holscher

Spotlight to be installed on ceiling/
wall. Electronic transformer 220/240,
50/60hz for phosphor LED integrated.
LED integrated

ELECTRICAL

Transformer availability	Included
Transformer mounting	Integral
Transformer type	Electronic
Emergency	Without
Insulation class	Class I

● 09.2451.30C - 1035lm	White
● 09.2451.02C - 1035lm	Grey
● 09.2451.14C - 1035lm	Black

PHYSICAL

Width (mm)	180
Spot diameter (mm)	86
Construction material	Aluminium
Weight (kg)	1,20

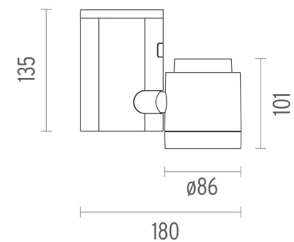

CERTIFICATIONS

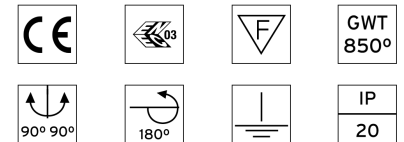

Pure I Spot Ceiling . Accessories

Optical



08.8166.14

Holding ring



08.8163.68

Elliptical lens

Elliptical light distribution lens in 4 mm thick tempered glass.



08.8169.14

Honeycomb

"Honeycomb" anti-glare screen: in thin, blackpainted aluminium sheets.



Pure I Spot Ceiling
designed by Knud Holscher

Spotlight to be installed on ceiling/wall. Electronic transformer 220/240, 50/60hz for phosphor LED integrated. LED integrated

- 09.2451.30C - 1035lm White
- 09.2451.02C - 1035lm Grey
- 09.2451.14C - 1035lm Black

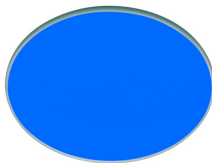

08.8160.64.OD

Blue filter

Blue filter

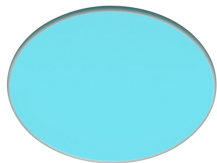

08.8160.65.OD

Sky blue filter

Sky blue filter

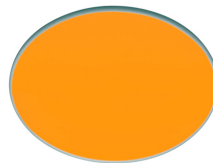

08.8160.66.OD

Amber filter

Amber filter

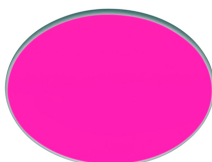
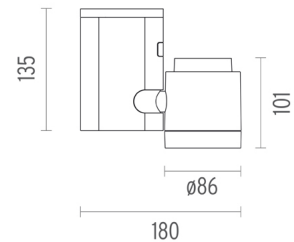

08.8160.67.OD

Red filter

Red filter



08.8160.98.OD

U.V. filter

U.V. filter



08.8160.68

I.R. filter

I.R. filter

CERTIFICATIONS



Pure I Spot Ceiling . Accessories



08.8160.69

Hot Light

Hot Light

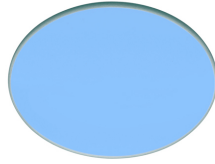

08.8160.CL

Cold light filter

Cold light filter

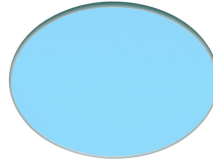

08.8160.DL

Daylight filter

Daylight filter



Pure I Spot Ceiling

designed by Knud Holscher

Spotlight to be installed on ceiling/wall. Electronic transformer 220/240, 50/60hz for phosphor LED integrated. LED integrated

- 09.2451.30C - 1035lm White
- 09.2451.02C - 1035lm Grey
- 09.2451.14C - 1035lm Black



08.8160.ND

Neodimium



○ 08.8175.68

Flood lens

Flood lens made in press glass.



● 08.8232.30

● 08.8232.02

● 08.8232.14

Pure I Pro external ring accessory

Pure I Pro external ring accessory. Only for halogen and halide lamps, consult for LED version

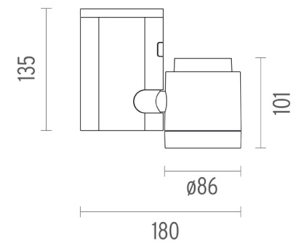

CERTIFICATIONS



Pure I Spot Ceiling . Lamps



Phosphor LED

Lamp category:
LED

Lamp type:
Phosphor LED



Pure I Spot Ceiling designed by Knud Holscher

Spotlight to be installed on ceiling/
wall. Electronic transformer 220/240,
50/60hz for phosphor LED integrated.
LED integrated

- 09.2451.30C - 1035lm White
- 09.2451.02C - 1035lm Grey
- 09.2451.14C - 1035lm Black

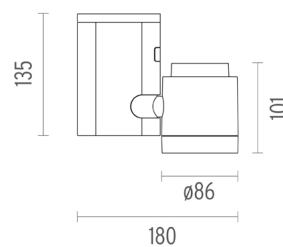

CERTIFICATIONS

