

# FLOS

## PURE | SPOT TRACK

<b>Number of heads</b>	1
<b>Mounting</b>	Track mounting
<b>Lamps description</b>	Power LED 15,7W 1400 lm 3000K CRI 80
<b>Luminaire luminous flux</b>	Extreme Cut-off. See reference number
<b>Voltage (V)</b>	220/240
<b>Environment</b>	Indoor

### OPTICAL

<b>Reflector finish</b>	Aluminum
<b>Aiming</b>	Adjustable
<b>Light distribution symmetry</b>	Symmetric
<b>Beam angle</b>	15° Spot

### ELECTRICAL

<b>Transformer availability</b>	Included
<b>Transformer mounting</b>	Integral
<b>Transformer type</b>	Electronic
<b>Emergency</b>	Without
<b>Insulation class</b>	Class I

### PHYSICAL

<b>Width (mm)</b>	180
<b>Spot diameter (mm)</b>	86
<b>Construction material</b>	Aluminium
<b>Weight (kg)</b>	1,20



### Pure I Spot Track designed by Knud Holscher

Projector for mounting on threephase rail with LED light source. 220-240V, 50-60Hz power supply included.

● 09.2415.30A - 1225lm	White
● 09.2415.02A - 1225lm	Grey
● 09.2415.14A - 1225lm	Black

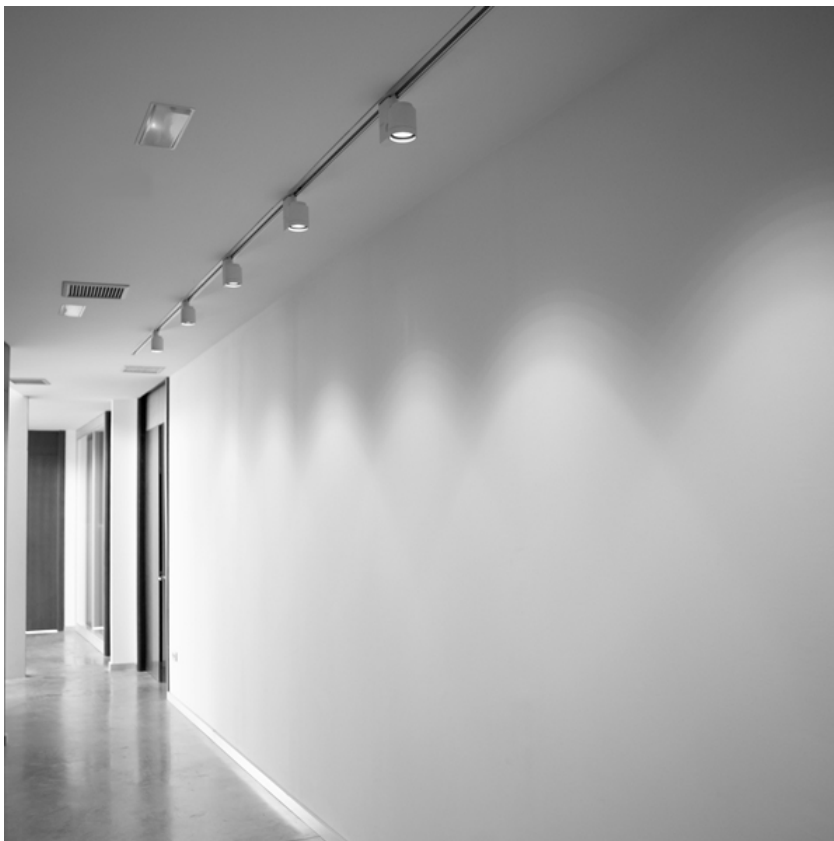
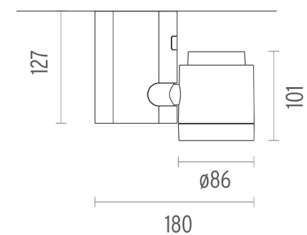

### CERTIFICATIONS

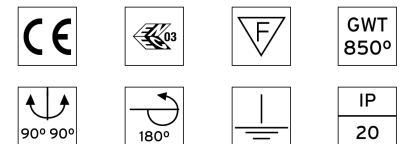

## Pure I Spot Track . Accessories

### Optical



08.8166.14

**Holding ring**



08.8163.68

**Elliptical lens**

Elliptical light distribution lens in 4 mm thick tempered glass.



08.8169.14

**Honeycomb**

"Honeycomb" anti-glare screen: in thin, blackpainted aluminium sheets.



**Pure I Spot Track**  
designed by Knud Holscher

Projector for mounting on threephase rail with LED light source. 220-240V, 50-60Hz power supply included.

- 09.2415.30A - 1225lm White
- 09.2415.02A - 1225lm Grey
- 09.2415.14A - 1225lm Black

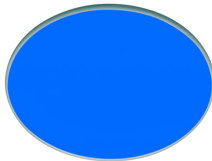

08.8160.64.OD

**Blue filter**

Blue filter

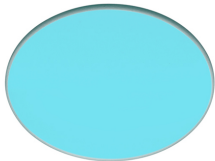

08.8160.65.OD

**Sky blue filter**

Sky blue filter



08.8160.66.OD

**Amber filter**

Amber filter

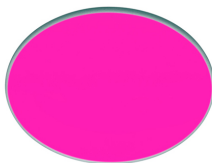
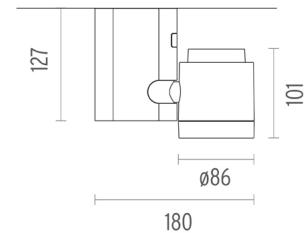

08.8160.67.OD

**Red filter**

Red filter



08.8160.98.OD

**U.V. filter**

U.V. filter



08.8160.68

**I.R. filter**

I.R. filter

### CERTIFICATIONS



## Pure I Spot Track . Accessories



08.8160.69

**Hot Light**

Hot Light

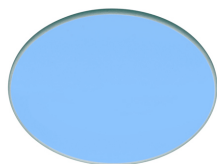

08.8160.CL

**Cold light filter**

Cold light filter

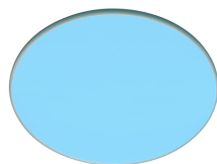

08.8160.DL

**Daylight filter**

Daylight filter



**Pure I Spot Track**  
designed by Knud Holscher

Projector for mounting on threephase rail with LED light source. 220-240V, 50-60Hz power supply included.



08.8160.ND

**Neodimium**



08.8175.68

**Flood lens**

Flood lens made in press glass.



08.8232.30

08.8232.02

08.8232.14

**Pure I Pro external ring accessory**

Pure I Pro external ring accessory. Only for halogen and halide lamps, consult for LED version

- 09.2415.30A - 1225lm White
- 09.2415.02A - 1225lm Grey
- 09.2415.14A - 1225lm Black

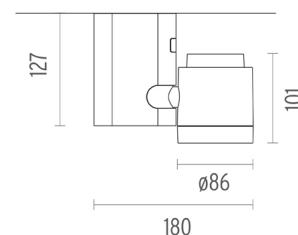

## CERTIFICATIONS



## Pure I Spot Track . Lamps



**Power LED**

**Lamp category:**  
LED

**Socket:**  
Special base

**Lamp type:**  
Power LED



**Pure I Spot Track**  
designed by Knud Holscher

Projector for mounting on threephase rail with LED light source. 220-240V, 50-60Hz power supply included.

- 09.2415.30A - 1225lm White
- 09.2415.02A - 1225lm Grey
- 09.2415.14A - 1225lm Black

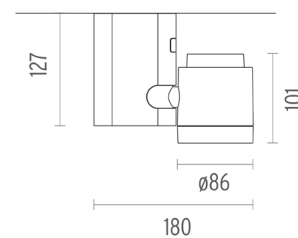

**CERTIFICATIONS**

