

FLOS

PURE I SPOT CEILING

| | |
|--------------------------|--|
| Number of heads | 1 |
| Mounting | Ceiling surface |
| Lamps description | QR-CBC 5I GX5.3 Max 50W or LED QR-CBC 5I GX5.3 7/10W |
| Voltage (V) | 220/240 |
| Environment | Indoor |



OPTICAL

| | |
|-------------------------------------|------------------------------|
| Light controller description | Bare lamps |
| Reflector finish | Aluminum |
| Aiming | Adjustable |
| Light distribution symmetry | Symmetric |
| Beam angle | 10°, 24°, 25°, 36°, 38°, 60° |

Pure I Spot Ceiling designed by Knud Holscher

Spotlight to be installed on ceiling/wall. Electronic transformer integrated 220/240V – 12V, 50/60Hz. Dimmerable from 10% to 100% of full output using built-in potentiometer

ELECTRICAL

| | |
|---------------------------------|------------|
| Transformer availability | Included |
| Transformer mounting | Integral |
| Transformer type | Electronic |
| Emergency | Without |
| Insulation class | Class I |

| | |
|--------------|-------|
| ● 09.1100.30 | White |
| ● 09.1100.02 | Grey |
| ● 09.1100.14 | Black |

PHYSICAL

| | |
|------------------------------|-----------|
| Width (mm) | 180 |
| Spot diameter (mm) | 86 |
| Construction material | Aluminium |
| Weight (kg) | 1,20 |

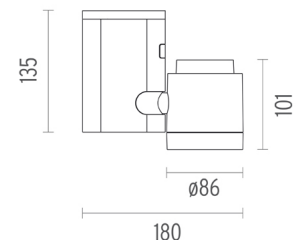

CERTIFICATIONS

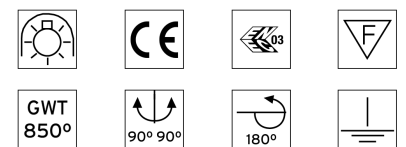

| |
|----|
| IP |
| 20 |

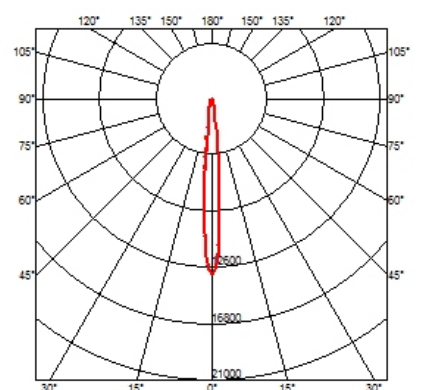

Pure I Spot Ceiling . Accessories

Optical



08.8166.14

Holding ring



08.8163.68

Elliptical lens

Elliptical light distribution lens in 4 mm thick tempered glass.



08.8169.14

Honeycomb

"Honeycomb" anti-glare screen: in thin, blackpainted aluminium sheets.



Pure I Spot Ceiling
designed by Knud Holscher

Spotlight to be installed on ceiling/wall. Electronic transformer integrated 220/240V – 12V, 50/60Hz. Dimmable from 10% to 100% of full output using built-in potentiometer

- 09.1100.30 White
- 09.1100.02 Grey
- 09.1100.14 Black

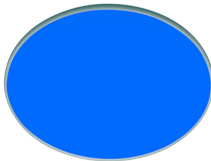

08.8160.64.OD

Blue filter

Blue filter

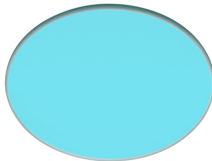

08.8160.65.OD

Sky blue filter

Sky blue filter

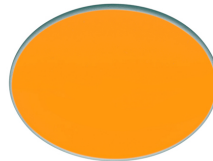

08.8160.66.OD

Amber filter

Amber filter

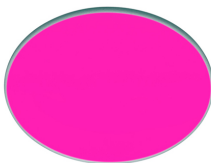
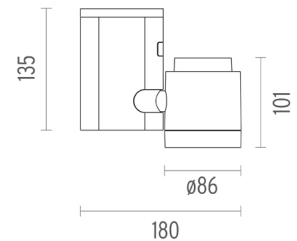

08.8160.67.OD

Red filter

Red filter



08.8160.98.OD

U.V. filter

U.V. filter



08.8160.68

I.R. filter

I.R. filter

CERTIFICATIONS

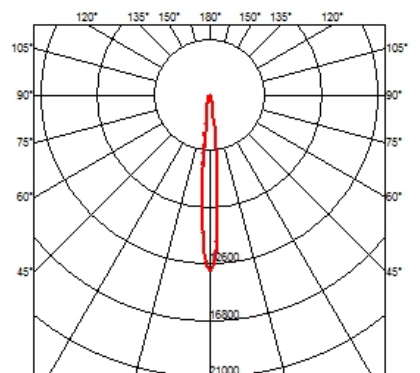
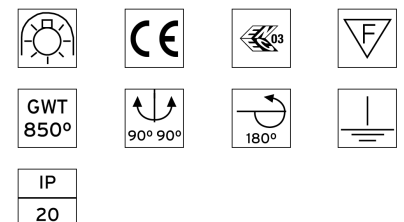

Pure I Spot Ceiling . Accessories



08.8160.69

Hot Light

Hot Light

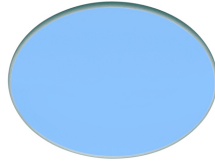

08.8160.CL

Cold light filter

Cold light filter

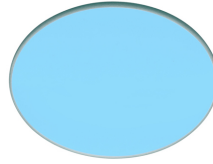

08.8160.DL

Daylight filter

Daylight filter



Pure I Spot Ceiling

designed by Knud Holscher

Spotlight to be installed on ceiling/wall. Electronic transformer integrated 220/240V – 12V, 50/60Hz. Dimmable from 10% to 100% of full output using built-in potentiometer

- 09.1100.30 White
- 09.1100.02 Grey
- 09.1100.14 Black



08.8160.ND

Neodimium



○ 08.8175.68

Flood lens

Flood lens made in press glass.



● 08.8232.30

● 08.8232.02

● 08.8232.14

Pure I Pro external ring accessory

Pure I Pro external ring accessory. Only for halogen and halide lamps, consult for LED version

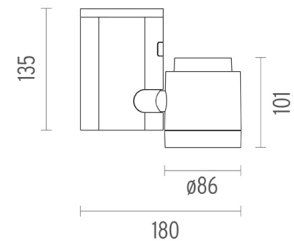

CERTIFICATIONS

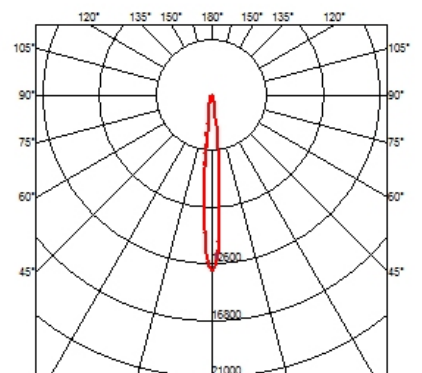

Pure I Spot Ceiling . Lamps



60.6392
QR-CBC 5I
Lamp Watt:
 20 W
Lamp category:
 Halogen low voltage
Socket:
 GX5.3
Lamp angle:
 10 °
Color temperature (K):
 3000 °K
Catalog reference:
 60.6392
Lamp type:
 QR-CBC 5I



60.6359
QR-CBC 5I
Lamp Watt:
 50 W
Lamp category:
 Halogen low voltage
Socket:
 GX5.3
Lamp angle:
 24 °
Color temperature (K):
 3000 °K
Catalog reference:
 60.6359
Lamp type:
 QR-CBC 5I



60.6360
QR-CBC 5I
Lamp Watt:
 50 W
Lamp category:
 Halogen low voltage
Socket:
 GX5.3
Lamp angle:
 38 °
Color temperature (K):
 3000 °K
Catalog reference:
 60.6360
Lamp type:
 QR-CBC 5I



Pure I Spot Ceiling designed by Knud Holscher

Spotlight to be installed on ceiling/wall. Electronic transformer integrated 220/240V – 12V, 50/60Hz. Dimmable from 10% to 100% of full output using built-in potentiometer

| | |
|--------------|-------|
| ● 09.1100.30 | White |
| ● 09.1100.02 | Grey |
| ● 09.1100.14 | Black |

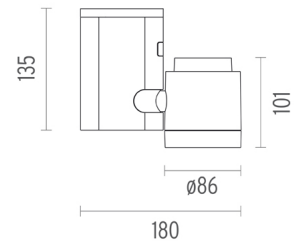

60.6361
QR-CBC 5I
Lamp Watt:
 50 W
Lamp category:
 Halogen low voltage
Socket:
 GX5.3
Lamp angle:
 60 °
Color temperature (K):
 3000 °K
Catalog reference:
 60.6361
Lamp type:
 QR-CBC 5I



60.6393
QR-CBC 5I
Lamp Watt:
 20 W
Lamp category:
 Halogen low voltage
Socket:
 GX5.3
Lamp angle:
 24 °
Color temperature (K):
 3000 °K
Catalog reference:
 60.6393
Lamp type:
 QR-CBC 5I



60.6394
QR-CBC 5I
Lamp Watt:
 20 W
Lamp category:
 Halogen low voltage
Socket:
 GX5.3
Lamp angle:
 38 °
Color temperature (K):
 3000 °K
Catalog reference:
 60.6394
Lamp type:
 QR-CBC 5I

CERTIFICATIONS

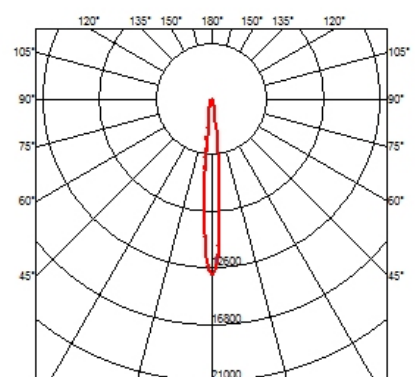
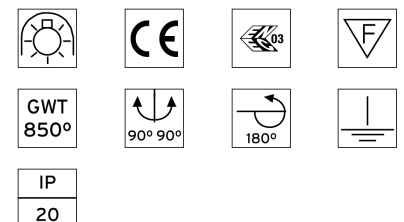

Pure I Spot Ceiling . Lamps



60.6395

QR-CBC 51

Lamp Watt:
20 W

Lamp category:
Halogen low voltage

Socket:
GX5.3

Lamp angle:
60 °

Color temperature (K):
3000 °K

Catalog reference:
60.6395

Lamp type:
QR-CBC 51



60.6355

QR-CBC 51

Lamp Watt:
35 W

Lamp category:
Halogen low voltage

Socket:
GX5.3

Lamp angle:
24 °

Color temperature (K):
3000 °K

Catalog reference:
60.6355

Lamp type:
QR-CBC 51



60.6356

QR-CBC 51

Lamp Watt:
35 W

Lamp category:
Halogen low voltage

Socket:
GX5.3

Lamp angle:
38 °

Color temperature (K):
3000 °K

Catalog reference:
60.6356

Lamp type:
QR-CBC 51



Pure I Spot Ceiling
designed by Knud Holscher

Spotlight to be installed on ceiling/wall. Electronic transformer integrated 220/240V – 12V, 50/60Hz. Dimmable from 10% to 100% of full output using built-in potentiometer

| | |
|--------------|-------|
| ● 09.1100.30 | White |
| ● 09.1100.02 | Grey |
| ● 09.1100.14 | Black |

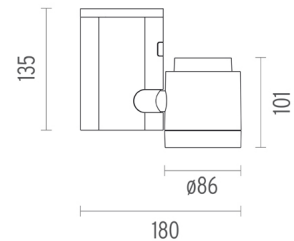

60.6357

QR-CBC 51

Lamp Watt:
35 W

Lamp category:
Halogen low voltage

Socket:
GX5.3

Lamp angle:
60 °

Color temperature (K):
3000 °K

Catalog reference:
60.6357

Lamp type:
QR-CBC 51



BU19

QR-CBC 51

Lamp Watt:
20 W

Lamp category:
Halogen low voltage

Socket:
GX5.3

Lamp angle:
38 °

Color temperature (K):
3000 °K

Catalog reference:
BU19

Lamp type:
QR-CBC 51



BU20

QR-CBC 51

Lamp Watt:
35 W

Lamp category:
Halogen low voltage

Socket:
GX5.3

Lamp angle:
38 °

Color temperature (K):
3000 °K

Catalog reference:
BU20

Lamp type:
QR-CBC 51

CERTIFICATIONS

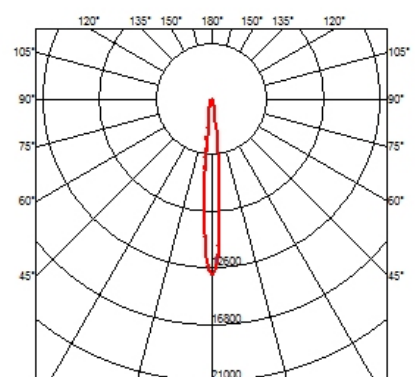
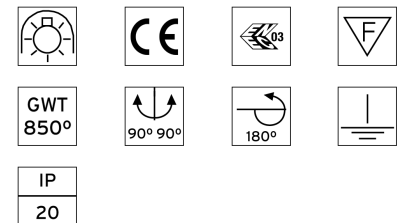

Pure I Spot Ceiling . Lamps



BU2I

QR-CBC 5I

Lamp Watt:
50 W

Lamp category:
Halogen low voltage

Socket:
GX5.3

Lamp angle:
60 °

Color temperature (K):
3000 °K

Catalog reference:
BU2I

Lamp type:
QR-CBC 5I



60.689I

LED QR-CBC 5I

Lamp Watt:
8 W

Lamp category:
LED

Socket:
GX5.3

Lamp angle:
24 °

Color temperature (K):
3000 °K

Catalog reference:
60.689I

Lamp type:
LED QR-CBC 5I



Pure I Spot Ceiling
designed by Knud Holscher

Spotlight to be installed on ceiling/
wall. Electronic transformer
integrated 220/240V – 12V, 50/60Hz.
Dimmable from 10% to 100% of full
output using built-in potentiometer

- 09.1100.30 White
- 09.1100.02 Grey
- 09.1100.14 Black

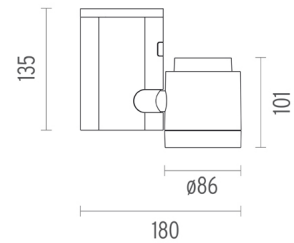

CERTIFICATIONS

