

PURE I SPOT TRACK

Number of heads	1
Mounting	Track mounting
Lamps description	HI PAR 51 GX10 20W
Voltage (V)	220/240
Environment	Indoor

OPTICAL

Light controller description	Bare lamp
Aiming	Adjustable
Light distribution symmetry	Symmetric
Beam angle	12° Spot, 25° Flood, 40° Wide Flood

ELECTRICAL

Control gear availability	Included
Control gear type	Electronic
Control gear mounting	Integral
Emergency	Without
Insulation class	Class I

PHYSICAL

Width (mm)	180
Spot diameter (mm)	86
Construction material	Aluminium
Weight (kg)	1,20



Pure I Spot Track
designed by Knud Holscher

Spotlight to be installed on 3-phase track. Electronic control gear 220/240V, 50/60Hz integrated

● 09.1001.30	White
● 09.1001.02	Grey
● 09.1001.14	Black

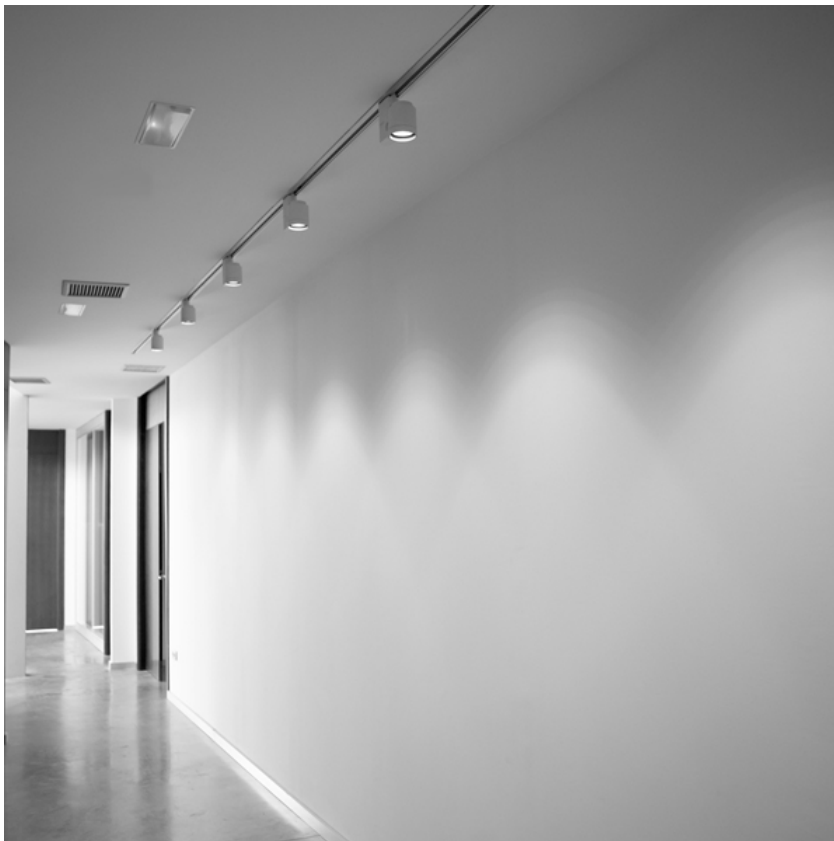
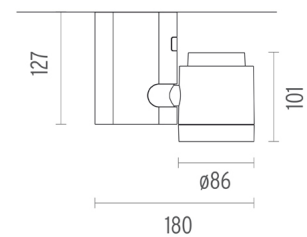

CERTIFICATIONS

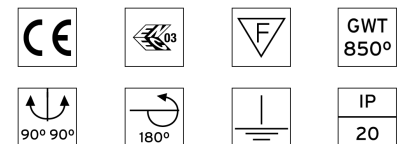

Pure I Spot Track . Accessories

Optical



08.8166.14

Holding ring



08.8163.68

Elliptical lens

Elliptical light distribution lens in 4 mm thick tempered glass.



08.8169.14

Honeycomb

"Honeycomb" anti-glare screen: in thin, blackpainted aluminium sheets.



Pure I Spot Track
designed by Knud Holscher

Spotlight to be installed on 3-phase track. Electronic control gear 220/240V, 50/60Hz integrated

- 09.1001.30 White
- 09.1001.02 Grey
- 09.1001.14 Black

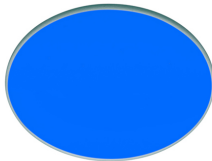

08.8160.64.OD

Blue filter

Blue filter

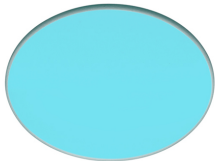

08.8160.65.OD

Sky blue filter

Sky blue filter

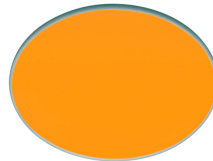

08.8160.66.OD

Amber filter

Amber filter

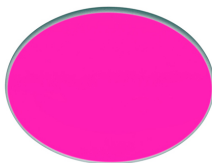
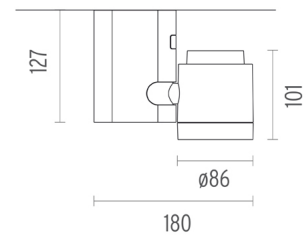

08.8160.67.OD

Red filter

Red filter



08.8160.98.OD

U.V. filter

U.V. filter



08.8160.68

I.R. filter

I.R. filter

CERTIFICATIONS

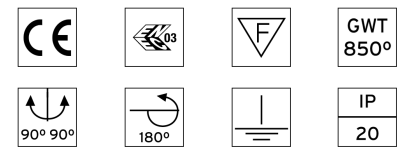

Pure I Spot Track . Accessories



08.8160.69

Hot Light

Hot Light

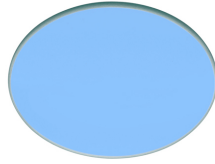

08.8160.CL

Cold light filter

Cold light filter

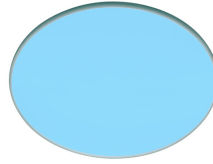

08.8160.DL

Daylight filter

Daylight filter



Pure I Spot Track

designed by Knud Holscher

Spotlight to be installed on 3-phase track. Electronic control gear 220/240V, 50/60Hz integrated

- 09.1001.30 White
- 09.1001.02 Grey
- 09.1001.14 Black



08.8160.ND

Neodimium



○ 08.8175.68

Flood lens

Flood lens made in press glass.



● 08.8232.30

● 08.8232.02

● 08.8232.14

Pure I Pro external ring accessory

Pure I Pro external ring accessory. Only for halogen and halide lamps, consult for LED version

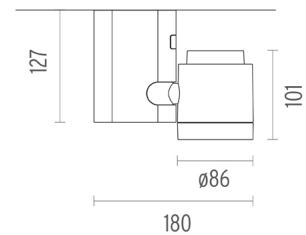

CERTIFICATIONS



Pure I Spot Track . Lamps



60.6576

HI PAR 51

Lamp Watt:
20 W

Lamp category:
Metal halide

Socket:
GX10

Lamp angle:
10 °

Color temperature (K):
3000 °K

Catalog reference:
60.6576

Lamp type:
HI PAR 51



60.6577

HI PAR 51

Lamp Watt:
20 W

Lamp category:
Metal halide

Socket:
GX10

Lamp angle:
25 °

Color temperature (K):
3000 °K

Catalog reference:
60.6577

Lamp type:
HI PAR 51



60.6578

HI PAR 51

Lamp Watt:
20 W

Lamp category:
Metal halide

Socket:
GX10

Lamp angle:
40 °

Color temperature (K):
3000 °K

Catalog reference:
60.6578

Lamp type:
HI PAR 51



Pure I Spot Track
designed by Knud Holscher

Spotlight to be installed on 3-phase track. Electronic control gear 220/240V, 50/60Hz integrated

● 09.1001.30	White
● 09.1001.02	Grey
● 09.1001.14	Black

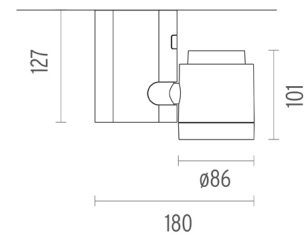

CERTIFICATIONS

