

LIGHT SHADOW FIXED NO TRIM 8 SPOTS OPTIC MEDIUM

| | |
|--------------------------------|--|
| Mounting | Ceiling recessed |
| Lamps description | Power LED 21,6W 2240 lm 3000K CRI 90 |
| Luminaire luminous flux | Extreme Cut-off. See reference number |
| Environment | Indoor |
| Notes | It requires an pre-installation frame, to be ordered separately. |

OPTICAL

| | |
|------------------------------------|------------|
| Aiming | Fixed |
| Light distribution symmetry | Symmetric |
| Beam angle | 23° Medium |

ELECTRICAL

| | |
|---------------------------------|------------|
| Transformer availability | Included |
| Transformer mounting | Remote |
| Transformer type | Electronic |
| Emergency | Without |
| Insulation class | Class II |

PHYSICAL

| | |
|----------------------------|------|
| Length (mm) | 280 |
| Recessed depth (mm) | 75 |
| Weight (kg) | 0,50 |



Light Shadow Fixed No Trim 8 Spots Optic Medium

designed by FLOS Architectural

Recessed integrated luminaire with 8 LED lighting spots. Remote power supply included.

| | | |
|--|---------------------|-------------------|
| | 03.9250.40 - 1686lm | White / White |
| | 03.9250.14 - 1686lm | Black / White |
| | 03.9252.40 - 1709lm | White / Chrome |
| | 03.9252.14 - 1709lm | Black / Chrome |
| | 03.9253.40 - 1678lm | White / Matt Gold |
| | 03.9253.14 - 1678lm | Black / Matt Gold |
| | 03.9251.40 - 1656lm | White / Black |
| | 03.9251.14 - 1656lm | Black / Black |

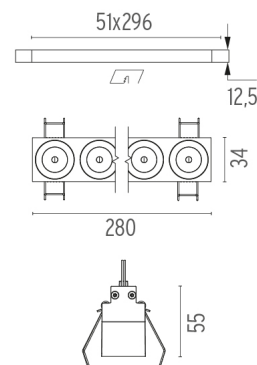

CERTIFICATIONS

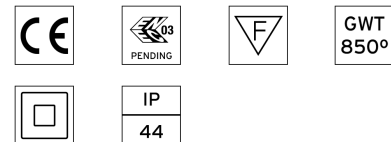

Light Shadow Fixed No Trim 8 Spots Optic Medium . Accessories

Mounting



○ 08.0512.00

**Pre-installation frame.
Fixed No Trim 8L**

○ 08.0052.90

**Accessory for mounting of
No Trim continuous line**

Accessory for mounting of No Trim continuous line. Each accessory allows connection between two No Trim pre-installation frames.



**Light Shadow Fixed No Trim 8
Spots Optic Medium**

designed by FLOS Architectural

Recessed integrated luminaire with 8 LED lighting spots. Remote power supply included.

- 03.9250.40 - 1686lm White / White
- 03.9250.14 - 1686lm Black / White
- 03.9252.40 - 1709lm White / Chrome
- 03.9252.14 - 1709lm Black / Chrome
- 03.9253.40 - 1678lm White / Matt Gold
- 03.9253.14 - 1678lm Black / Matt Gold
- 03.9251.40 - 1656lm White / Black
- 03.9251.14 - 1656lm Black / Black

Light Shadow Fixed No Trim 8 Spots Optic Medium . Lamps



Power LED

Lamp category:

LED

Socket:

Special base

Lamp type:

Power LED

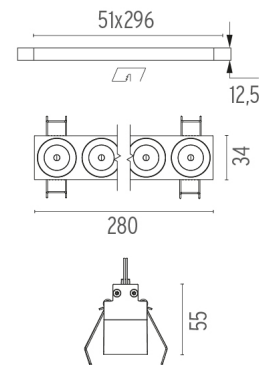

CERTIFICATIONS

