

LIGHT SHADOW FIXED NO TRIM 4 SPOTS OPTIC FLOOD

Mounting	Ceiling recessed
Lamps description	Power LED 10,8W 1120 lm 3000K CRI 90
Luminaire luminous flux	Extreme Cut-off. See reference number
Environment	Indoor
Notes	It requires an pre-installation frame, to be ordered separately.

OPTICAL

Aiming	Fixed
Light distribution symmetry	Symmetric
Beam angle	33° Flood

ELECTRICAL

Transformer availability	Included
Transformer mounting	Remote
Transformer type	Electronic
Emergency	Without
Insulation class	Class II

PHYSICAL

Length (mm)	140
Recessed depth (mm)	75
Weight (kg)	0,34



Light Shadow Fixed No Trim 4 Spots Optic Flood

designed by FLOS Architectural

Recessed integrated luminaire with 4 LED lighting spots. Remote power supply included.

- 03.9235.40 - 841lm White / White
- 03.9235.14 - 841lm Black / White
- ◐ 03.9237.40 - 860lm White / Chrome
- ◑ 03.9237.14 - 860lm Black / Chrome
- ◒ 03.9238.40 - 833lm White / Matt Gold
- ◓ 03.9238.14 - 833lm Black / Matt Gold
- ◔ 03.9236.40 - 817lm White / Black
- ◕ 03.9236.14 - 817lm Black / Black

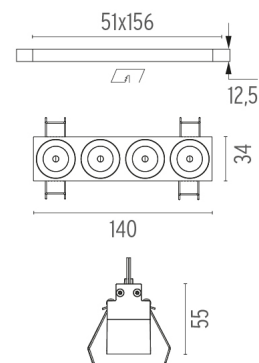

CERTIFICATIONS

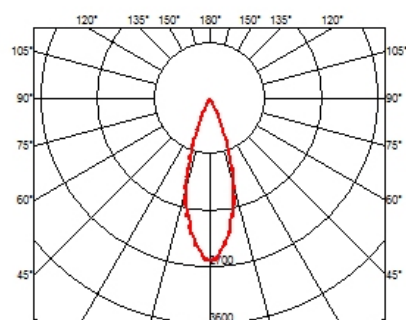
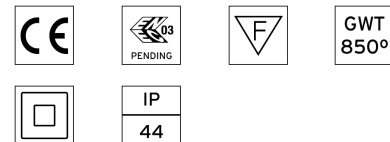

FLOS

Light Shadow Fixed No Trim 4 Spots Optic Flood . Accessories

Mounting



○ 08.0511.00

**Pre-installation frame.
Fixed No Trim 4L**

○ 08.0052.90

**Accessory for mounting of
No Trim continuous line**

Accessory for mounting of No Trim continuous line. Each accessory allows connection between two No Trim pre-installation frames.



**Light Shadow Fixed No Trim 4
Spots Optic Flood**

designed by FLOS Architectural

Recessed integrated luminaire with 4 LED lighting spots. Remote power supply included.

- 03.9235.40 - 841lm White / White
- 03.9235.14 - 841lm Black / White
- 03.9237.40 - 860lm White / Chrome
- 03.9237.14 - 860lm Black / Chrome
- 03.9238.40 - 833lm White / Matt Gold
- 03.9238.14 - 833lm Black / Matt Gold
- 03.9236.40 - 817lm White / Black
- 03.9236.14 - 817lm Black / Black

Light Shadow Fixed No Trim 4 Spots Optic Flood . Lamps



Power LED

Lamp category:

LED

Socket:

Special base

Lamp type:

Power LED

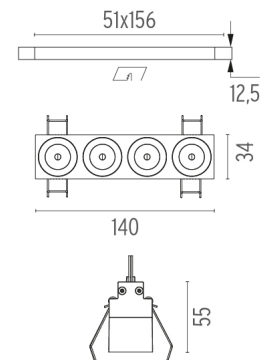

CERTIFICATIONS

