

LIGHT SHADOW ADJUSTABLE TRIM 2 SPOTS OPTIC SPOT

Mounting	Ceiling recessed
Lamps description	Power LED 5,4W 520 lm 2700K CRI 90
Luminaire luminous flux	Extreme Cut-off. See reference number
Environment	Indoor
Notes	Pre-installation frame not required.

OPTICAL

Aiming	Adjustable
Light distribution symmetry	Symmetric
Beam angle	10° Spot

ELECTRICAL

Transformer availability	Included
Transformer mounting	Remote
Transformer type	Electronic
Emergency	Without
Insulation class	Class II

PHYSICAL

Recessed depth (mm)	75
Weight (kg)	0,25



Light Shadow Adjustable Trim 2 Spots Optic Spot

designed by FLOS Architectural

Recessed integrated luminaire with 2 LED lighting spots. Remote power supply included.

- 03.8884.40 - 405lm White / White
- ◐ 03.8884.14 - 405lm Black / White
- ◑ 03.8886.40 - 408lm White / Chrome
- ◒ 03.8886.14 - 408lm Black / Chrome
- ◓ 03.8887.40 - 402lm White / Matt Gold
- ◔ 03.8887.14 - 402lm Black / Matt Gold
- ◕ 03.8885.40 - 396lm White / Black
- ◖ 03.8885.14 - 396lm Black / Black

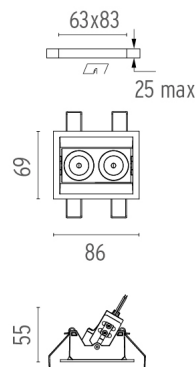
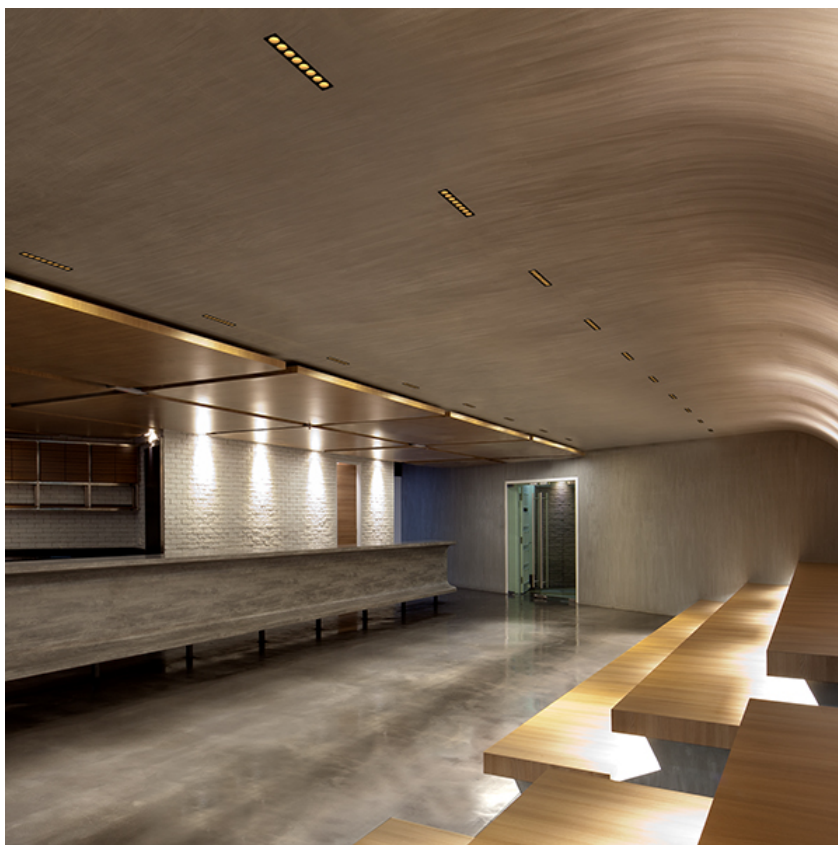

CERTIFICATIONS

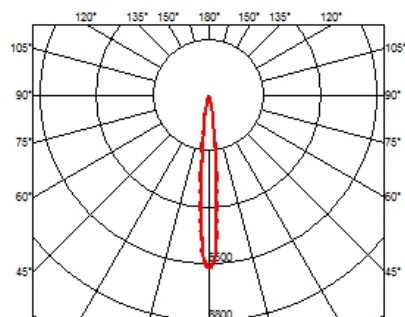
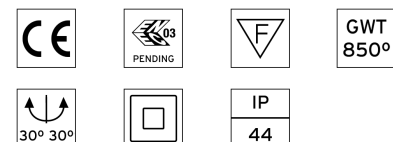

Light Shadow Adjustable Trim 2 Spots Optic Spot . Lamps



Power LED

Lamp category:
LED

Socket:
Special base

Lamp type:
Power LED



Light Shadow Adjustable Trim 2 Spots Optic Spot

designed by FLOS Architectural

Recessed integrated luminaire with 2
LED lighting spots. Remote power
supply included.

	03.8884.40 - 405lm	White / White
	03.8884.14 - 405lm	Black / White
	03.8886.40 - 408lm	White / Chrome
	03.8886.14 - 408lm	Black / Chrome
	03.8887.40 - 402lm	White / Matt Gold
	03.8887.14 - 402lm	Black / Matt Gold
	03.8885.40 - 396lm	White / Black
	03.8885.14 - 396lm	Black / Black

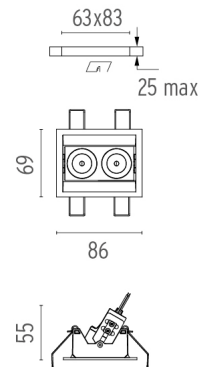

CERTIFICATIONS

