

## LIGHT TUBE Ø30 INDIRECT 1200 MM ON BOARD DIMMER

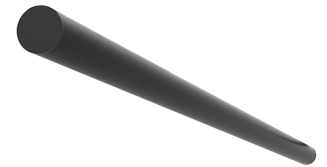

<b>Number of heads</b>	1
<b>Mounting</b>	Track mounting
<b>Lamps description</b>	Top LED 30W 2663 lm 3000K CRI 90
<b>Luminaire luminous flux</b>	See reference number
<b>Voltage (V)</b>	48
<b>Environment</b>	Indoor
<b>Notes</b>	System turning fastening elements 0°-90° with a magnetic connection and mechanic security lock for a transversally installation between two lines of the profile. The Light Tube are only fed by one of the ends and do not communicate current through the other end.



### Light Tube ø30 Indirect 1200 mm On Board Dimmer

designed by Vincent Van Duysen

Diffused LED light module to be installed in The Infra-Structure System.

	03.8116.40 - 1798lm	White
	03.8116.14 - 1798lm	Black

### OPTICAL

<b>Aiming</b>	Fixed
<b>Light distribution symmetry</b>	Symmetric
<b>Beam angle</b>	102°

### ELECTRICAL

<b>Transformer availability</b>	Separate item
<b>Transformer mounting</b>	Remote
<b>Transformer type</b>	Electronic dimmable
<b>Emergency</b>	Without

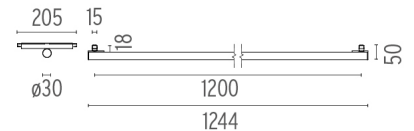
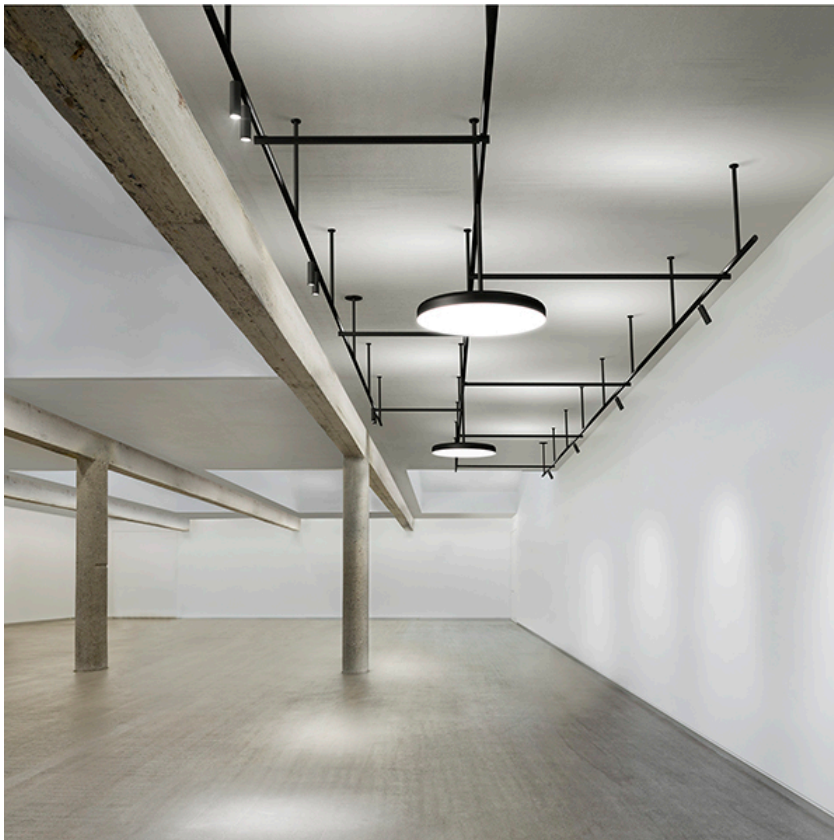

### CERTIFICATIONS



## Light Tube ø30 Indirect 1200 mm On Board Dimmer . Lamps



**Top LED**

**Lamp category:**

LED

**Socket:**

Special base

**Lamp type:**

Top LED

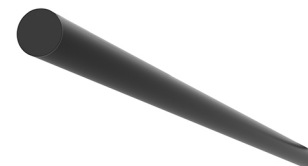

**Light Tube ø30 Indirect 1200 mm On Board Dimmer**

designed by Vincent Van Duysen

Diffused LED light module to be installed in The Infra-Structure System.

- 03.8116.40 - 1798lm    White
- 03.8116.14 - 1798lm    Black

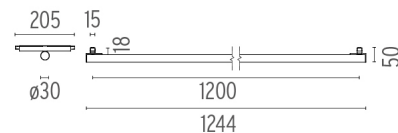

**CERTIFICATIONS**

