

## MINI GLO-BALL DALI VERSION

<b>Number of heads</b>	1
<b>Mounting</b>	Track mounting
<b>Lamps description</b>	Power LED 7W 880 lm 3000K CRI 80
<b>Luminaire luminous flux</b>	See reference number
<b>Voltage (V)</b>	24
<b>Environment</b>	Indoor
<b>Notes</b>	Maximum 14 spots for a single driver.



### OPTICAL

<b>Aiming</b>	Fixed
<b>Light distribution symmetry</b>	Symmetric

### Mini Glo-Ball Dali Version designed by FLOS Architectural

General lighting LED module to be installed in The Running Magnet 2.0 System. Built-in DC/DC electronic voltage converter.

### ELECTRICAL

<b>Transformer availability</b>	Separate item
<b>Transformer mounting</b>	Remote
<b>Transformer type</b>	Electronic dimmable dali
<b>Emergency</b>	Without
<b>Insulation class</b>	Class III

● 03.6261.14.DA - 446lm Black

### PHYSICAL

<b>Weight (kg)</b>	0,45
--------------------	------

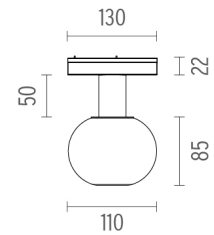

### CERTIFICATIONS



## Mini Glo-Ball Dali Version . Lamps



**Power LED**

**Lamp category:**  
LED

**Socket:**  
Special base

**Lamp type:**  
Power LED



**Mini Glo-Ball Dali Version**  
designed by FLOS Architectural

General lighting LED module to be installed in The Running Magnet 2.0 System. Built-in DC/DC electronic voltage converter.

● 03.6261.14.DA - 446lm Black

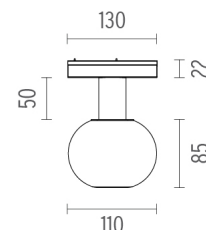

**CERTIFICATIONS**

