

COMPASS FIXED Ø110

Number of heads	1
Mounting	Ceiling recessed
Lamps description	QT-12 GY6.35 Max 50W
Bezel diameter	110
Voltage (V)	12
Environment	Indoor

OPTICAL

Light controller description	Protection glass
Reflector finish	Aluminum
Aiming	Fixed
Light distribution symmetry	Symmetric
Beam angle	53°

ELECTRICAL

Transformer availability	Separate item
Transformer mounting	Remote
Emergency	Without
Insulation class	Class III

PHYSICAL

Cutout shape	Round
Cutout diameter (mm)	102
Diameter (mm)	110
Recessed depth (mm)	107
Construction material	Die-cast aluminum
Weight (kg)	0,33



Compass Fixed Ø110
designed by FLOS Architectural

12V halogen lamp recessed downlight.
Remote transformer not included

03.3501.30	Matt white
03.3501.02	Grey
03.3501.14	Matt black

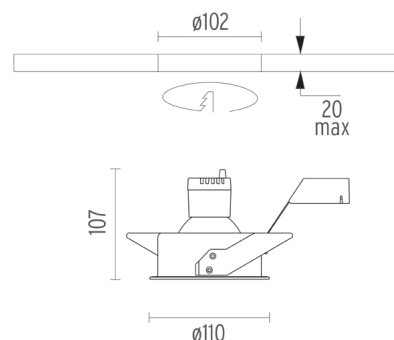

CERTIFICATIONS

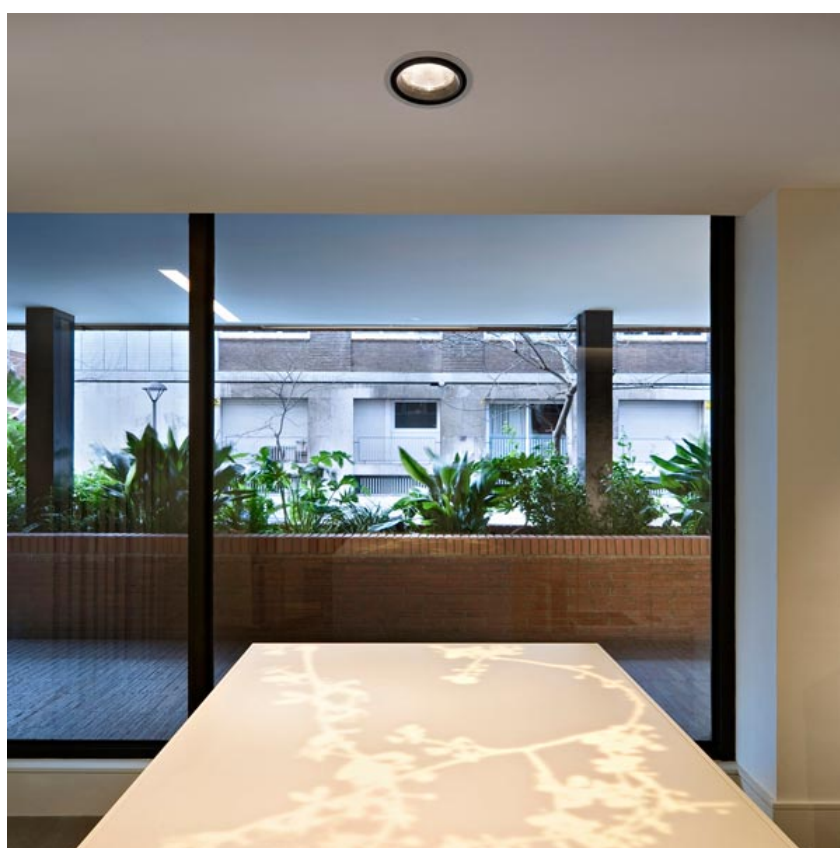

Compass Fixed Ø110 . Accessories

Optical



08.8015.53

Cut-off stainless steel cylinder

Cut-off stainless steel cylinder



Compass Fixed Ø110 designed by FLOS Architectural

12V halogen lamp recessed downlight.
Remote transformer not included

03.3501.30	Matt white
03.3501.02	Grey
03.3501.14	Matt black

Compass Fixed Ø110 . Lamps



60.6300

QT-12

Lamp Watt:
35 W

Lamp category:
Halogen low voltage

Socket:
GY6.35

Color temperature (K):
3000 °K

Catalog reference:
60.6300

Lamp type:
QT-12



60.6303

QT-12

Lamp Watt:
50 W

Lamp category:
Halogen low voltage

Socket:
GY6.35

Color temperature (K):
3000 °K

Catalog reference:
60.6303

Lamp type:
QT-12

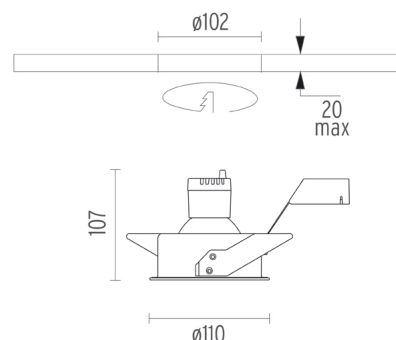

CERTIFICATIONS

