



E I C H H O L T Z

111017 WALL LAMP CLARIDGES SINGLE

ASSEMBLY INSTRUCTION

1

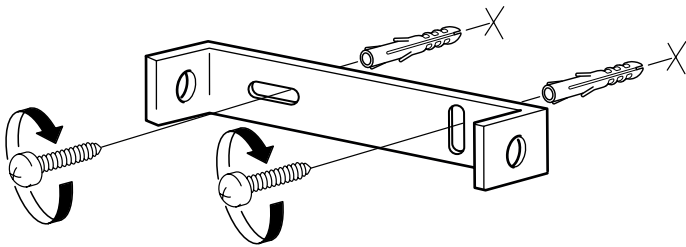

2

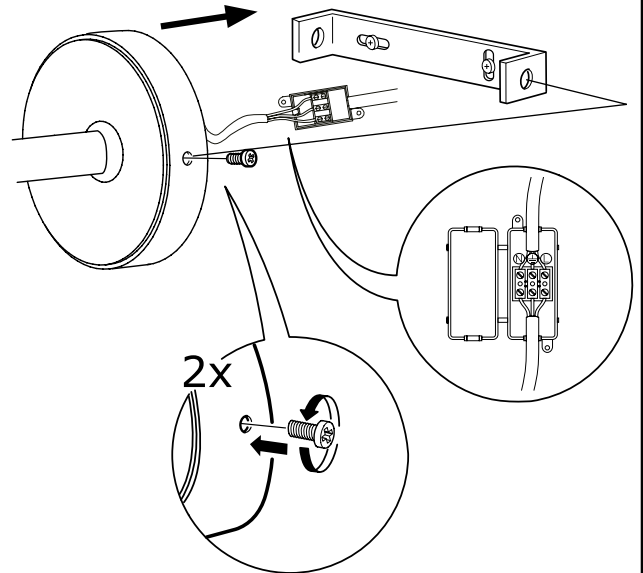

3

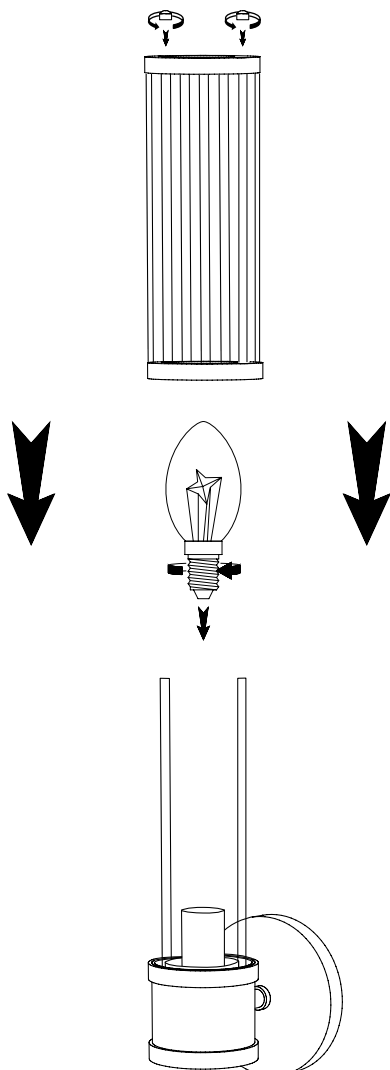

FINAL

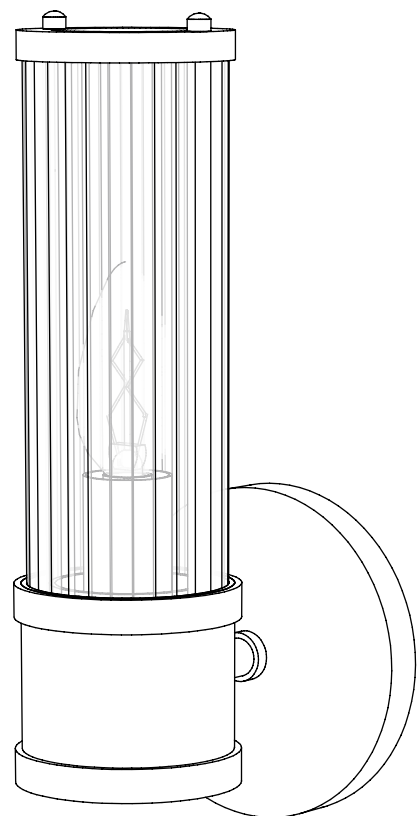

1. Fix the wall plate to the wall
2. Connect the power wires according to their colours, brown is the live wire, blue is the neutral wire, green/yellow is the earth wire. And place the lamp over the wall plate and fix it to the wall plate.
3. Place the bulbs and place the glass covers.