

**MAXISPY ON 95 DIM5**

DEEL  
PARTIE  
TEIL  
PART  
PARTE  
PARTE

# A

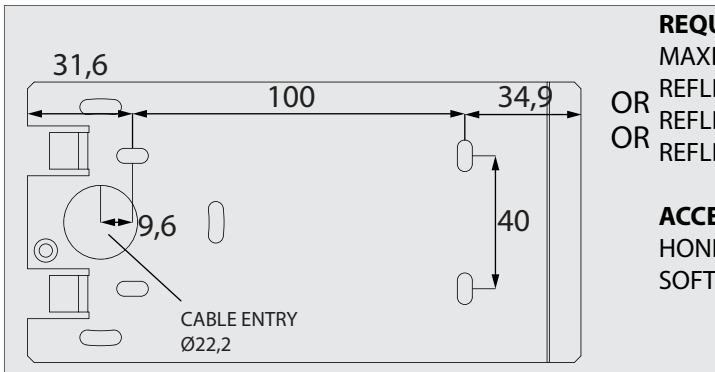
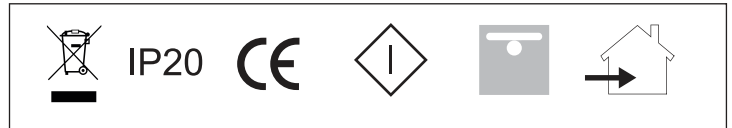
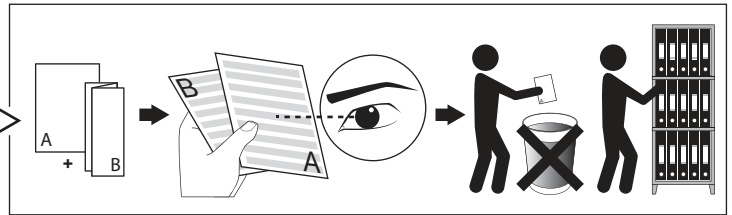
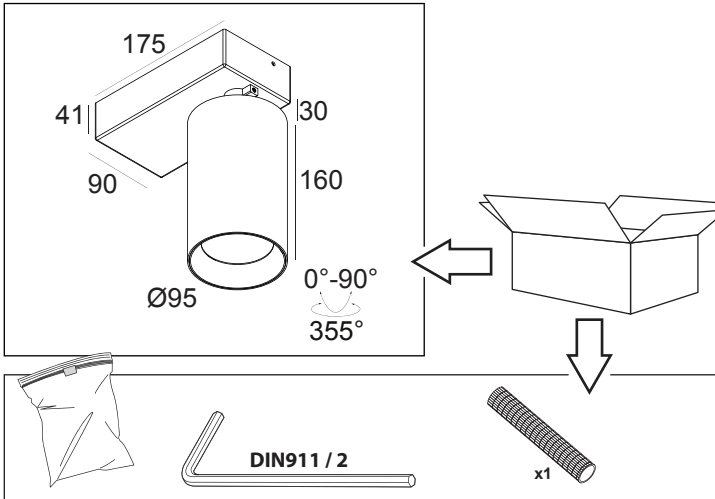

**REQUIREMENTS**

|                    |           |
|--------------------|-----------|
| MAXISPY ON 95 TUBE | 414 08 00 |
| REFLECTOR 20°      | 414 99 20 |
| REFLECTOR 38°      | 414 99 38 |
| REFLECTOR 50°      | 414 99 50 |

**ACCESSORIES**

|                   |           |
|-------------------|-----------|
| HONEYCOMB 74      | 414 04 01 |
| SOFTENING LENS 74 | 414 04 04 |

| DALI DIMMING   |          |
|----------------|----------|
| U              | 220-240V |
| P <sub>o</sub> | 43,9W    |
| I <sub>o</sub> | 1200mA   |

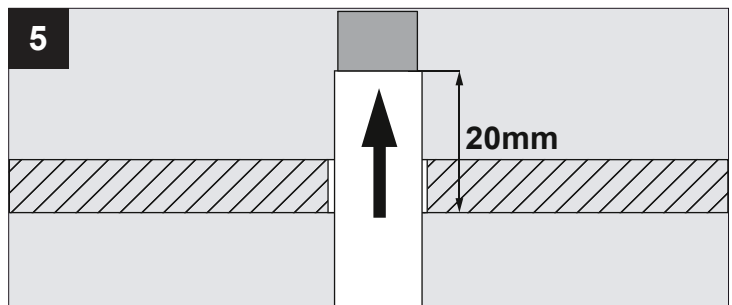
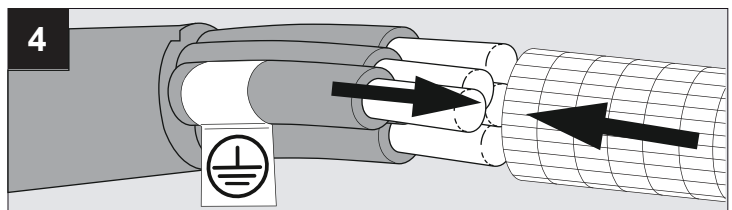
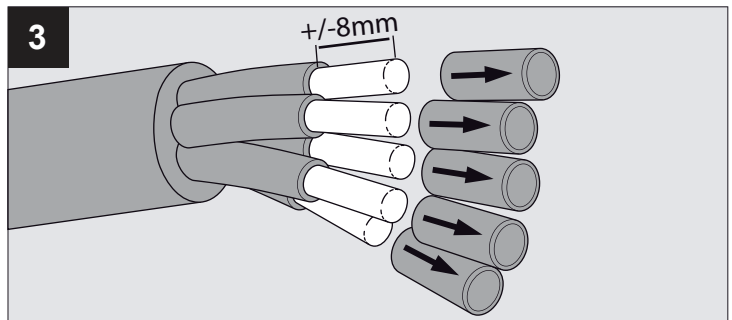
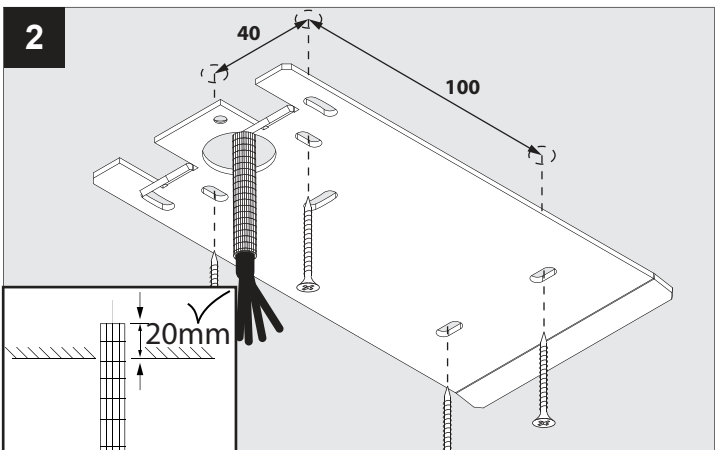
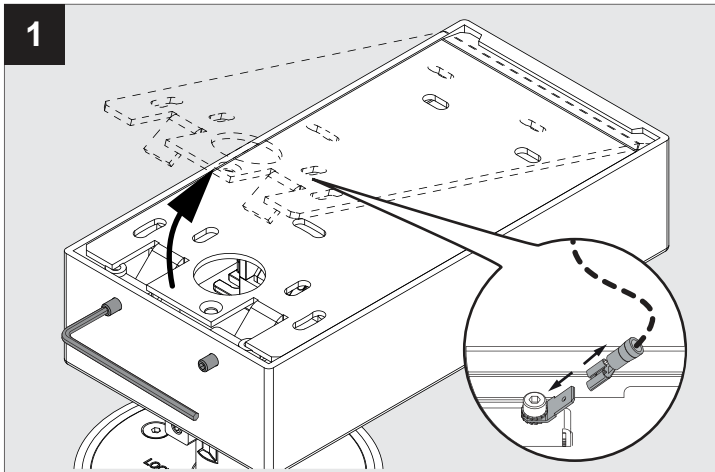
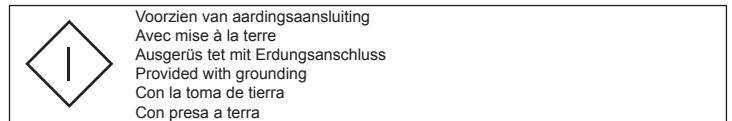
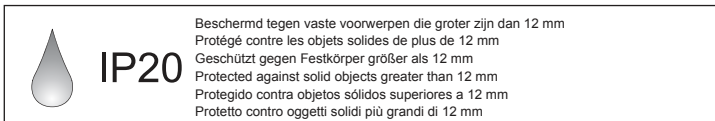

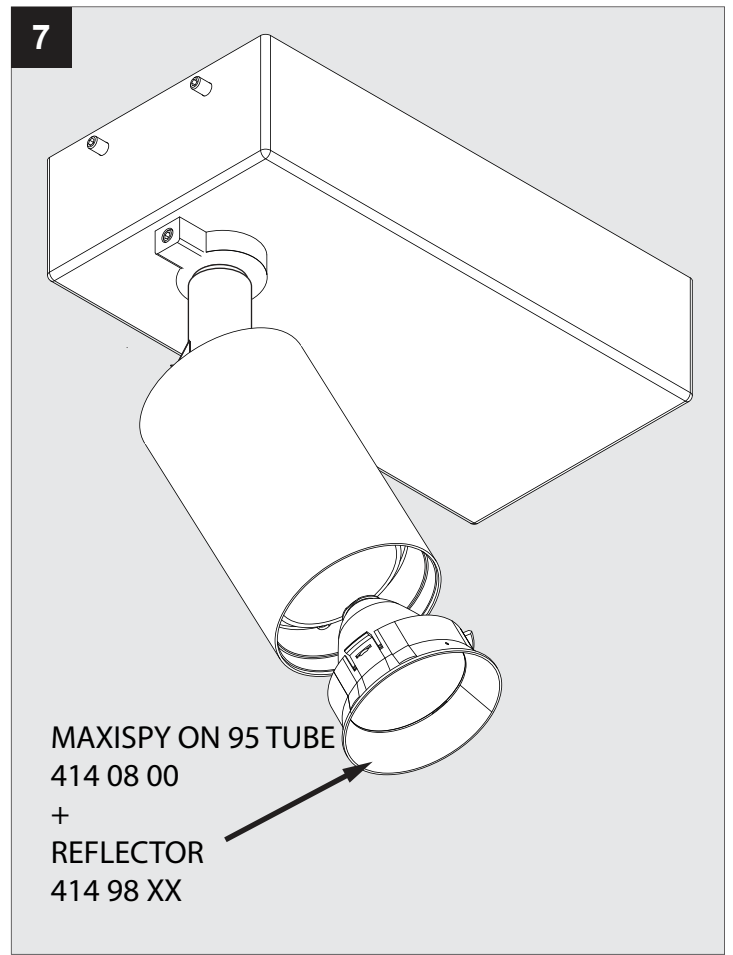
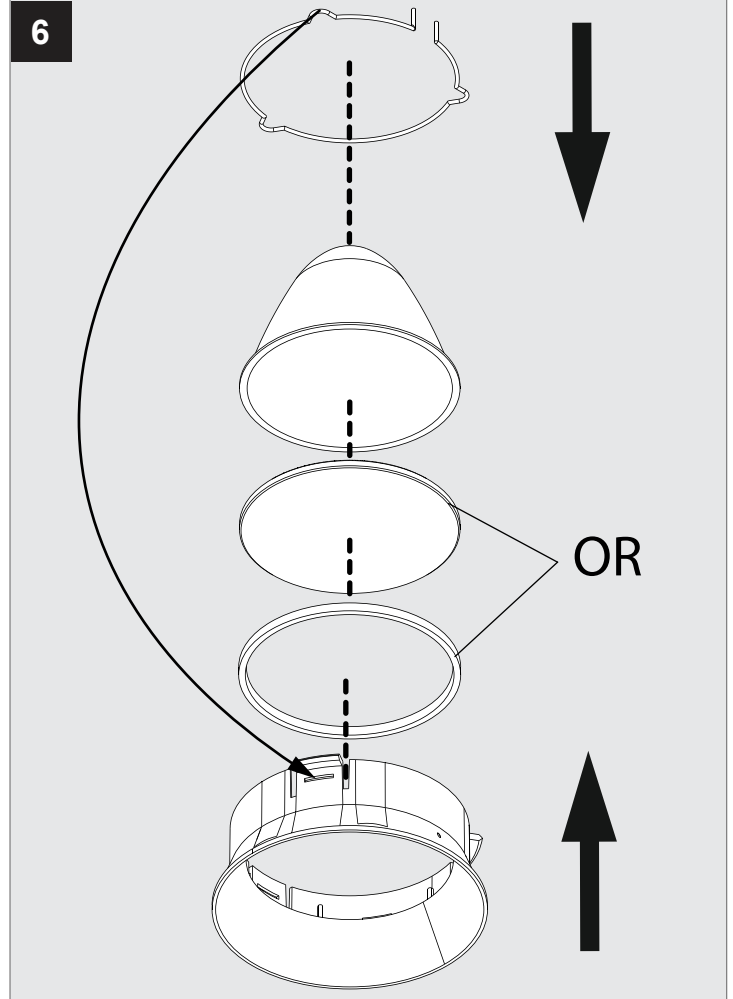
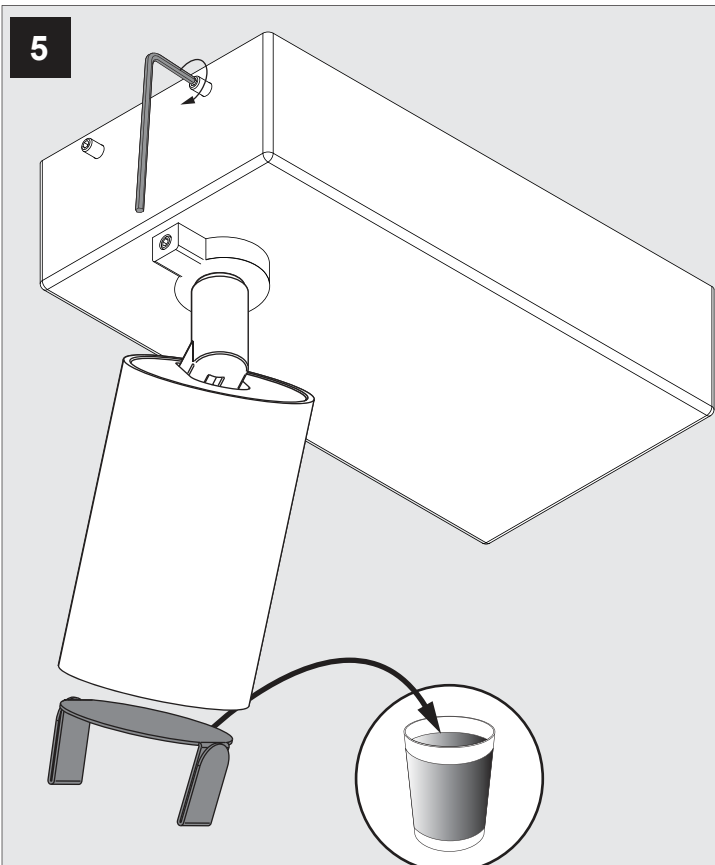
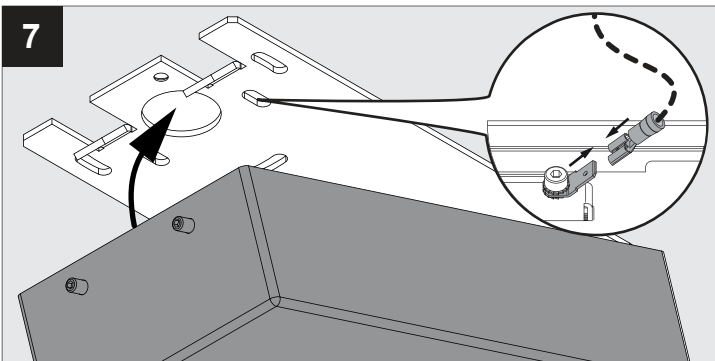
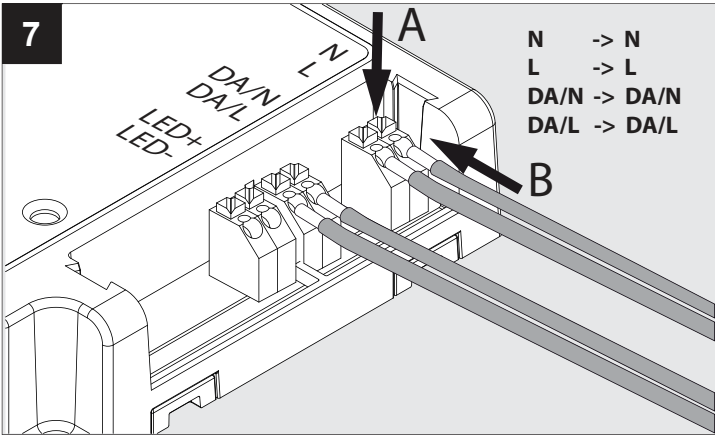
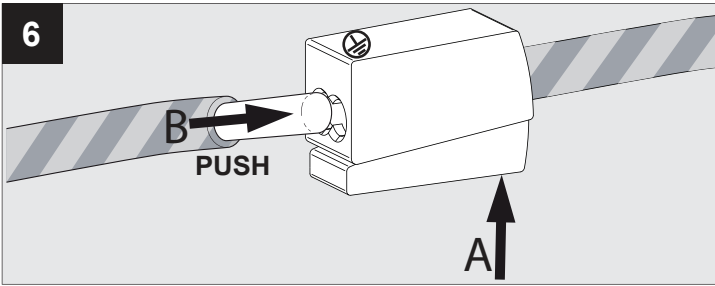

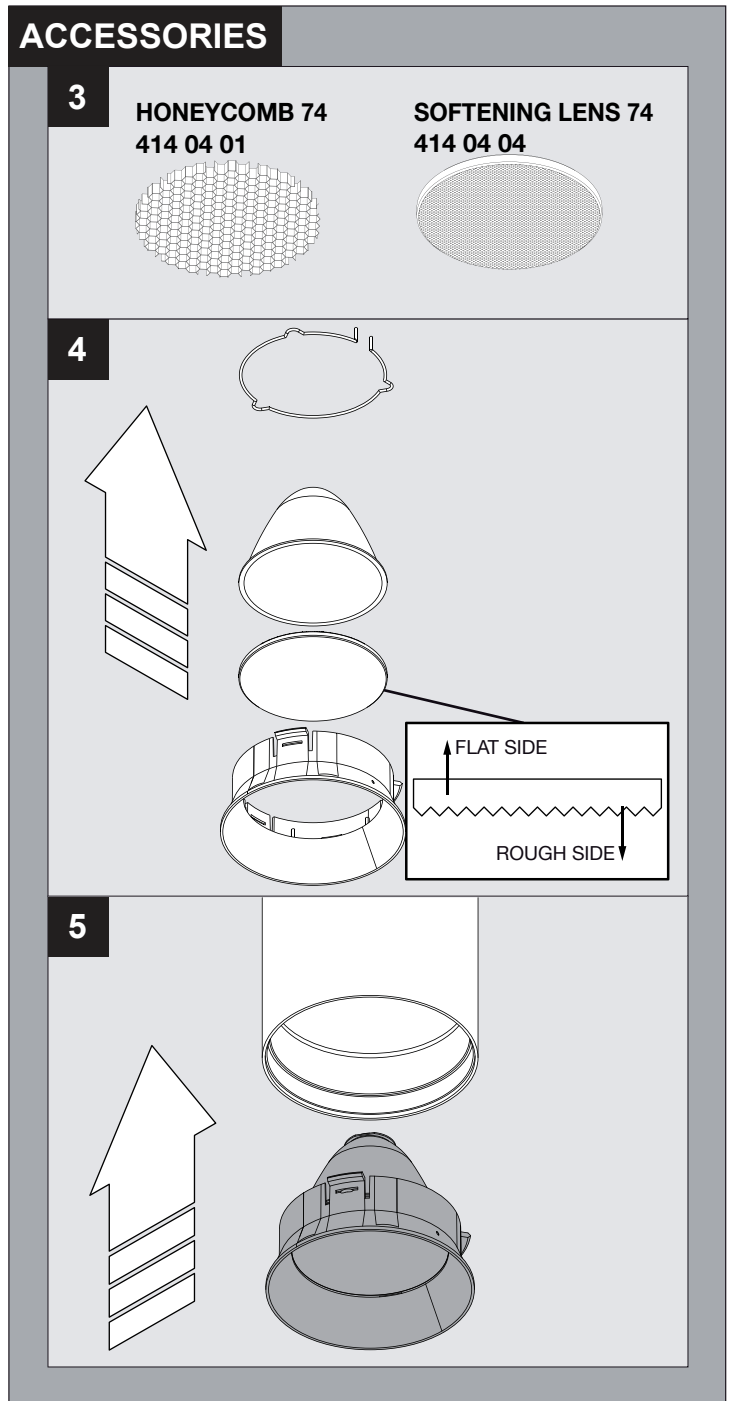
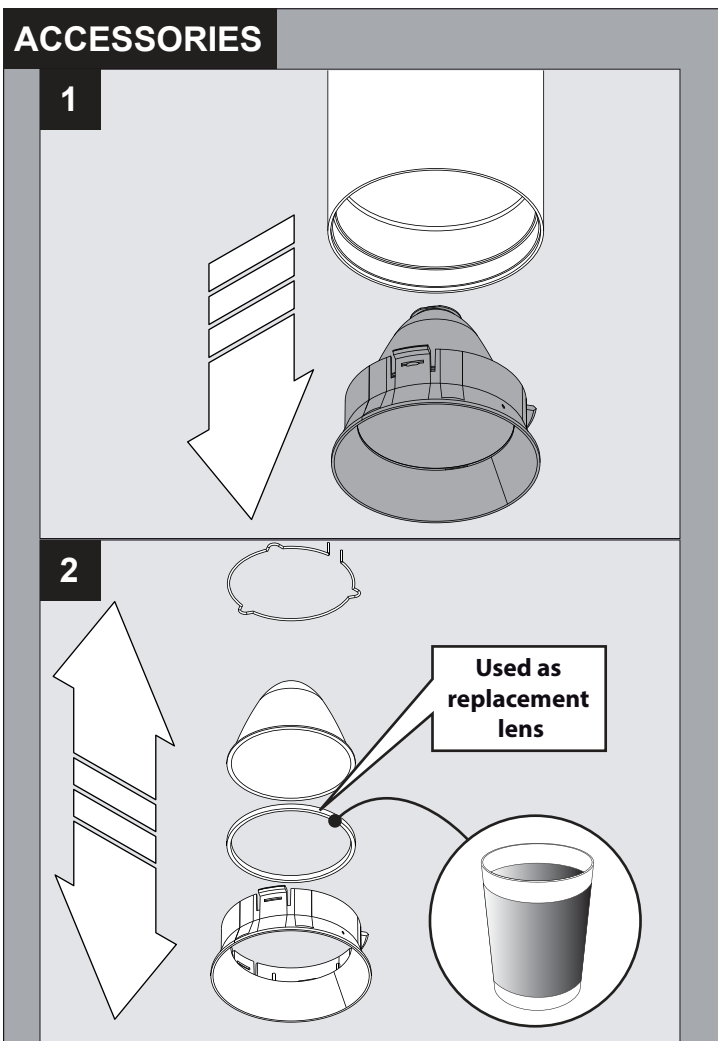
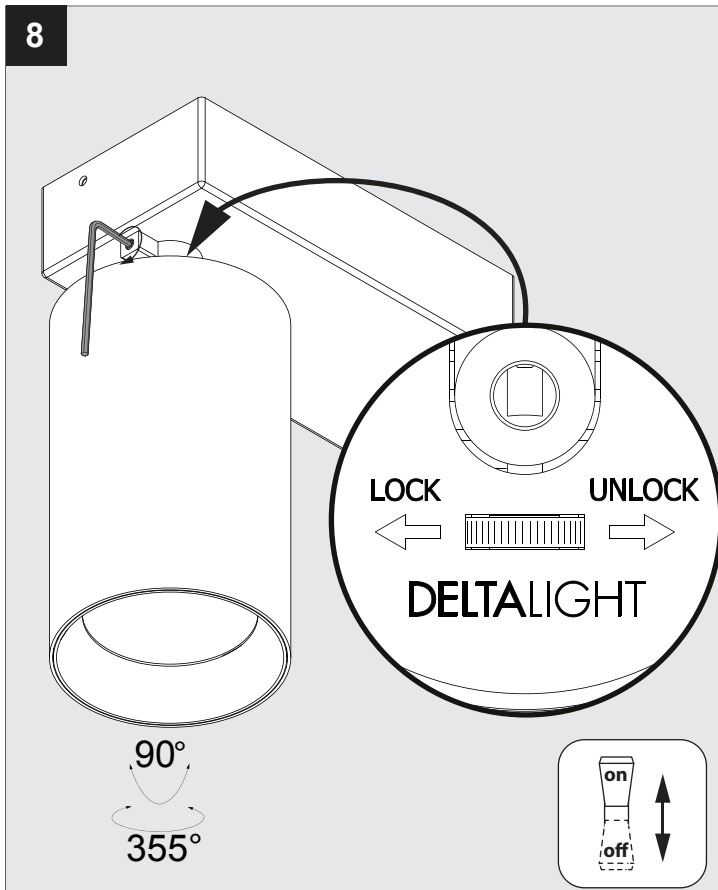

De verlichtingsbron van dit verlichtingstoestel zal enkel door de fabrikant of door de fabrikant aangestelde installateur vervangen worden.

La source lumière de cet appareil ne sera remplacée que par l'entreprise ou par un agent reconnu.

Das enthaltene Leuchtmittel sollte nur durch entsprechendes Fachpersonal ersetzt werden.

The light source contained in this luminaire shall only be replaced by the manufacturer or his service agent.

La fuente de iluminación que tiene esta luminaria sólo puede remplazarse por el fabricante o por un instalador autorizado.

La sorgente luminosa incorporata in questo apparecchio può essere sostituita solo dal produt tore, da un suo centro assistenza oppure da una persona in possesso della necessaria abilitazione.