

PINTOR 63 TRIMLESS BR

DEEL
PARTIE
TEIL
PART
PARTE
PARTE **A**

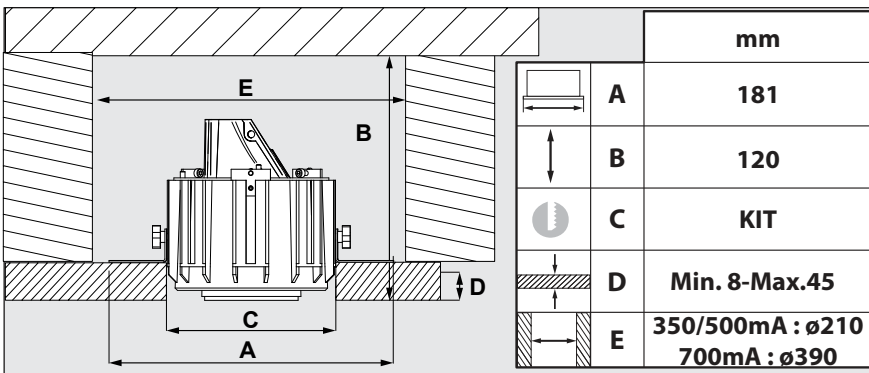
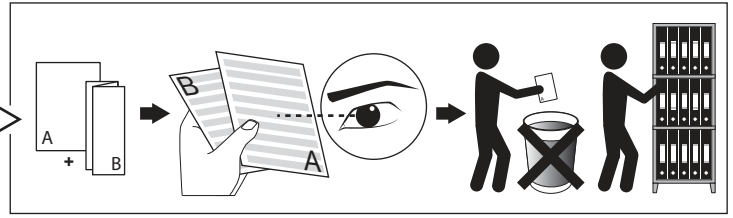
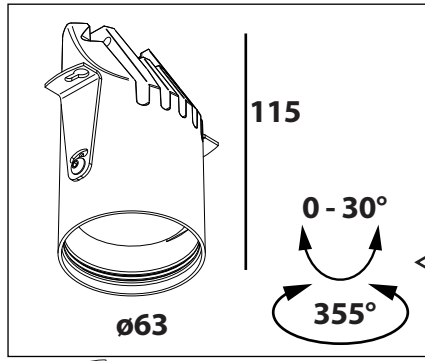

REQUIREMENTS

202 40 092

MOUNTING KIT
PINTOR 63 TRIMLESS
PINTOR 63 FRONTRING
SPY TUBE S

202 40 63
414 02 00

ACCESSORIES

413 03 01
413 03 02
413 03 03
413 03 04
413 03 05

HONEYCOMB 50
LINEAR SPREAD LENS 50
SPREAD LENS 50
SOFTENING LENS 50
GLASS SBL 50

Beschermtd tegen vaste voorwerpen die groter zijn dan 12 mm
Protégé contre les objets solides de plus de 12 mm
Geschützt gegen Festkörper größer als 12 mm
Protected against solid objects greater than 12 mm
Protegido contra objetos sólidos superiores a 12 mm
Protetto contro oggetti solidi più grandi di 12 mm

IP20
 IP23 Beschermtd tegen vaste voorwerpen die groter zijn dan 12 mm - Beschermtd tegen spreiwater
Protégé contre les objets solides de plus de 12 mm - Protégé contre les pulvérisations d'eau
Geschützt gegen Festkörper größer als 12 mm - Geschützt gegen Sprühwasser
Protected against solid objects greater than 12 mm - Protected against spraying water
Protegido contra objetos sólidos superiores a 12 mm - Protegido contra agua pulverizada
Protetto contro oggetti solidi più grandi di 12 mm - protetto contro gli spruzzi d'acqua

Enkel geschikt voor toestellen op zeer lage spanning (minder dan 50 V-AC / 120 V-DC)
Convient uniquement pour les produits à très basse tension (moins de 50 V-AC / 120 V-DC)
Geeignet für Güter mit sehr niedriger Spannung (unter 50 V-AC / 120 V-DC)
Only suited for goods at very low voltage (below 50 V-AC / 120 V-DC)
Se recomienda únicamente para aquellos productos de tensión muy baja (menos de 50 V-AC / 120 V-DC)
Vale unicamente per i prodotti a tensione molto bassa (inferiore a 50 V-AC / 120 V-DC)

Toestel niet geschikt om te worden afgedekt met thermische isolatie.
Luminaire non appropriées pour recouvrement d'un matériau isolant thermique.
Das Gerät/Die Leuchte darf nicht abgedeckt werden mit thermischer Isolation.
Luminaire not suitable for covering with insulating material.
Luminaria no apta para cubrir con material aislante.
Apparecchio non adatto per essere coperto da materiale isolante.

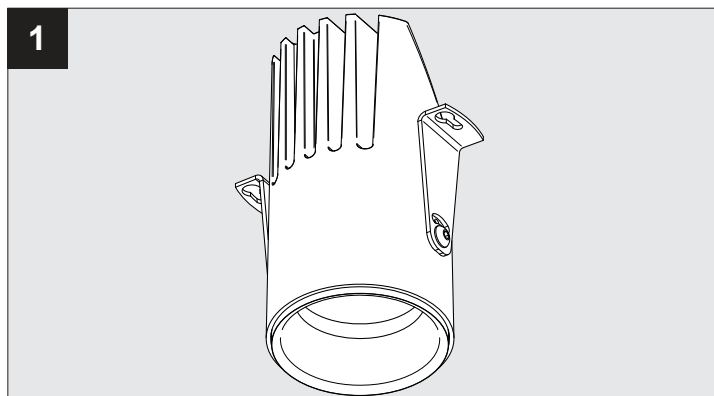

I _o	350mA	OR	500mA	OR	700mA
P _o	7,1W		10,4W		15W
U _i Typical	20,2V-DC		20,7V-DC		21,4V-DC

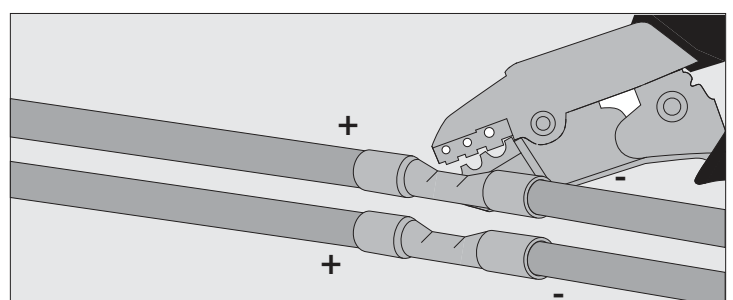
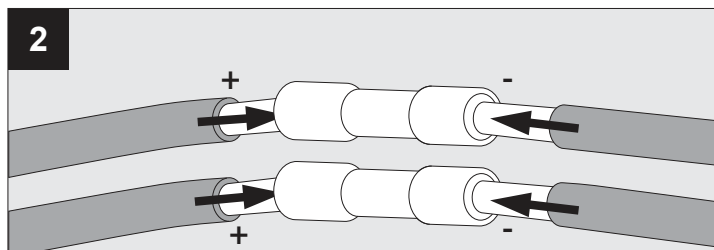

ELECTRICAL CONNECTION

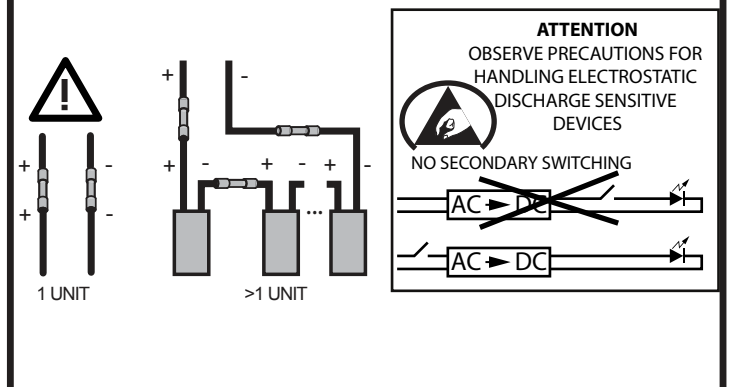

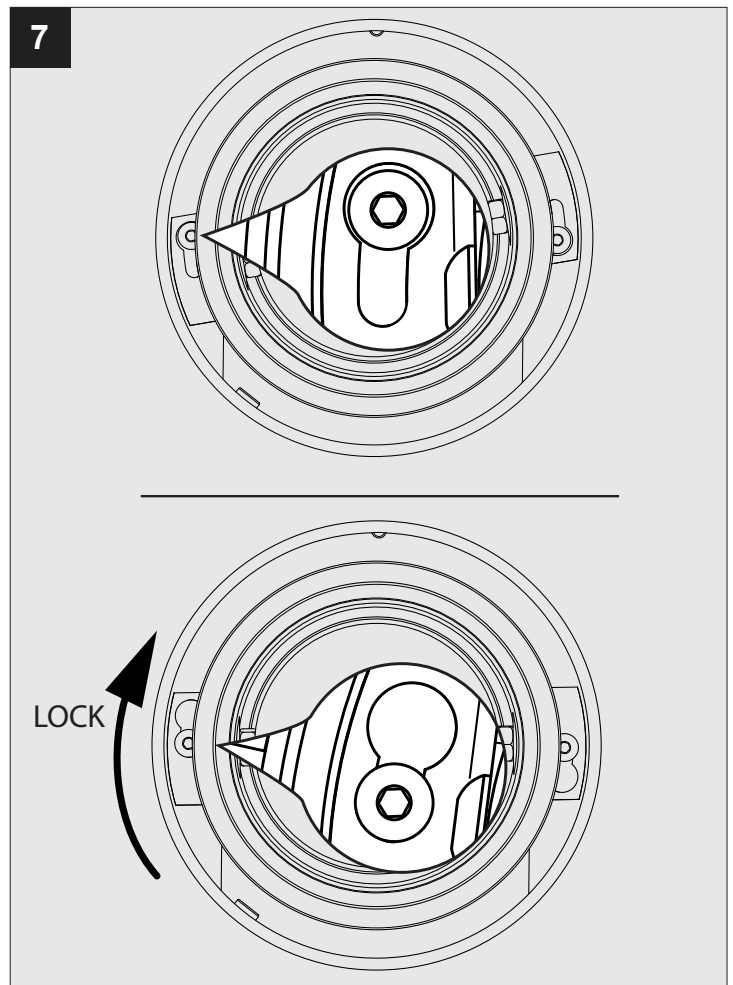
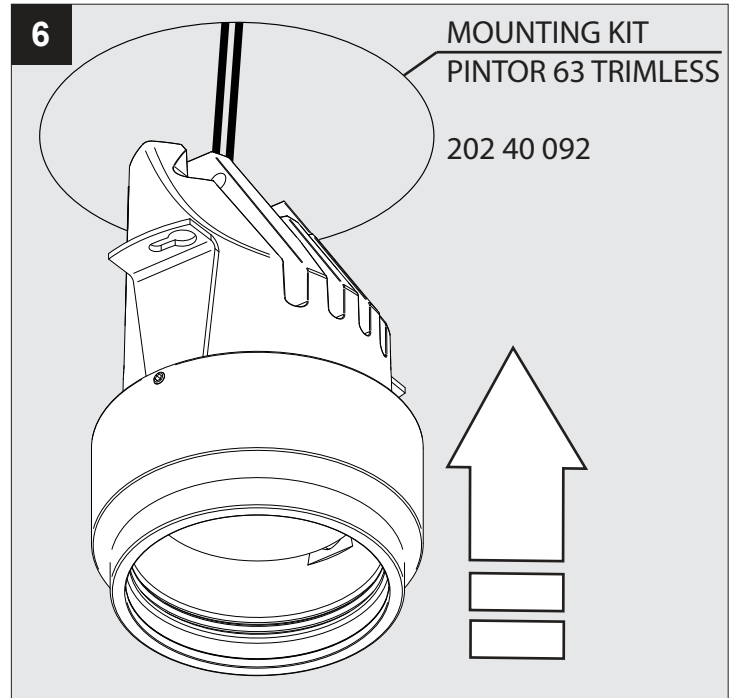
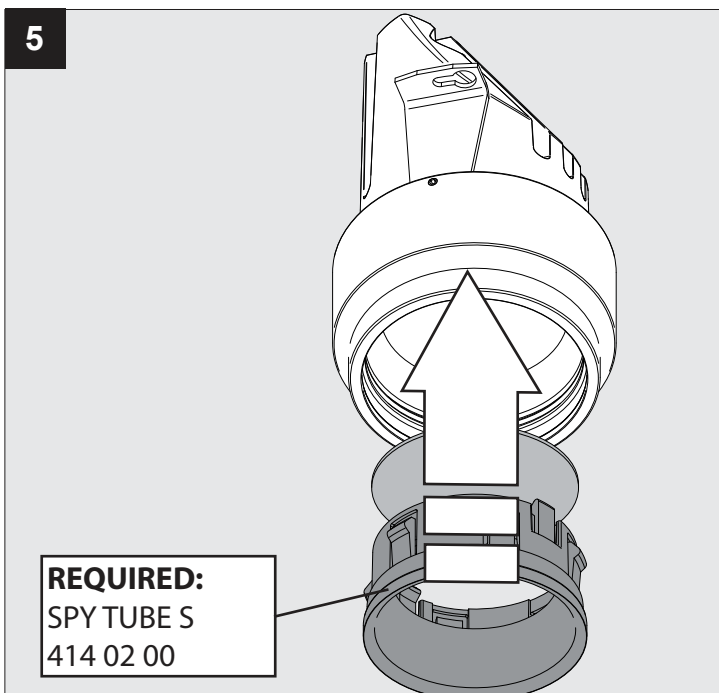
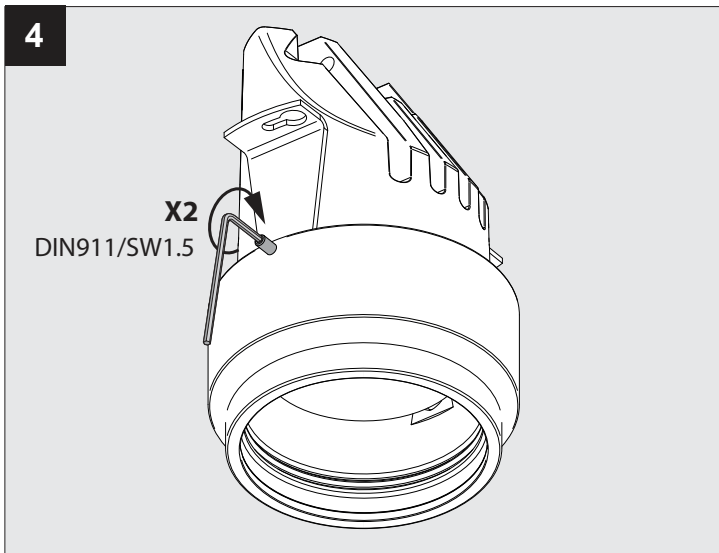
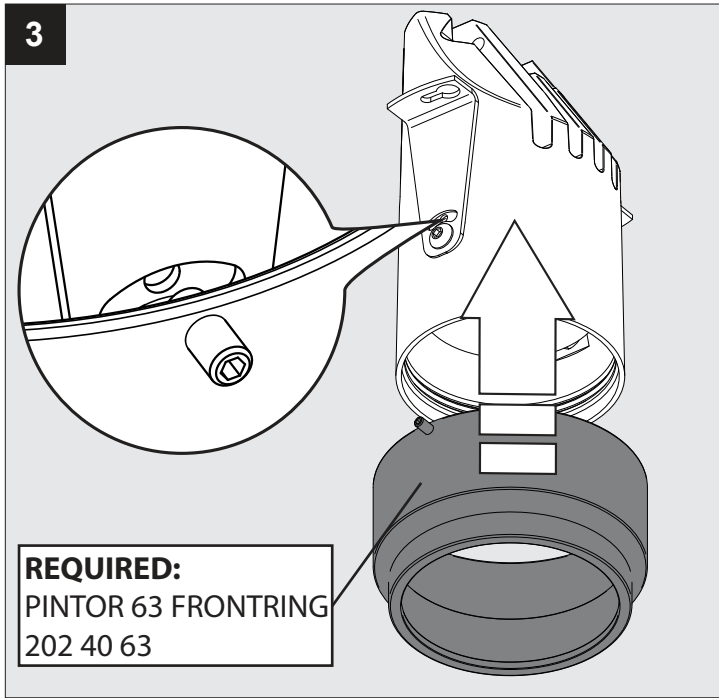

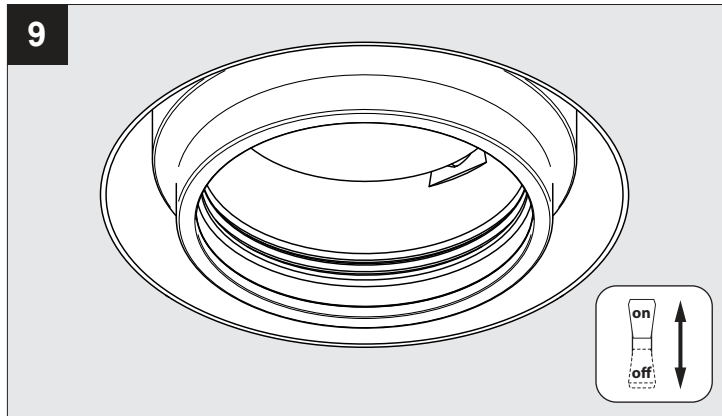
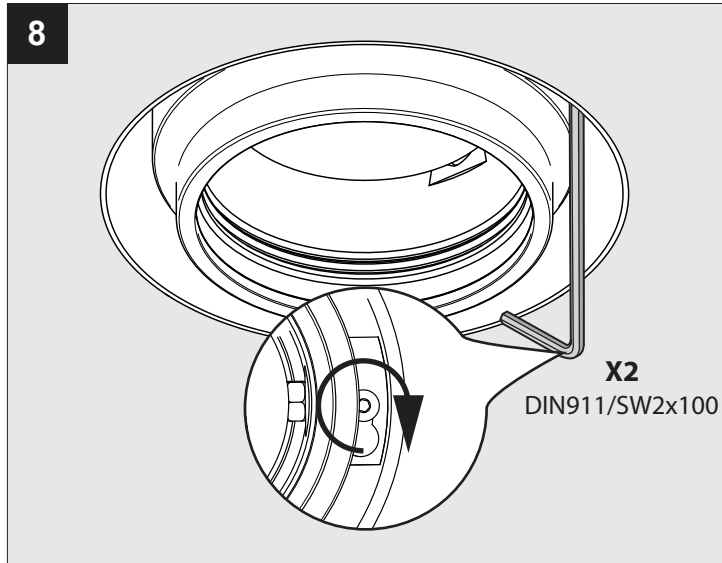

De verlichtingsbron van dit verlichtingstoestel zal enkel door de fabrikant of door de fabrikant aangestelde installateur vervangen worden.

La source lumière de cet appareil ne sera remplacée que par l'entrepreneur ou par un agent reconnu.

Das enthaltene Leuchtmittel sollte nur durch entsprechendes Fachpersonal ersetzt werden.

The light source contained in this luminaire shall only be replaced by the manufacturer or his service agent.

La fuente de iluminación que tiene esta luminaria sólo puede remplazarse por el fabricante o por un instalador autorizado.

La sorgente luminosa incorporata in questo apparecchio può essere sostituita solo dal produttore, da un suo centro assistenza oppure da una persona in possesso della necessaria abilitazione.

ACCESSORIES

