

BEGA**89 875.1**

Wall luminaire for indoor use



Project · Reference number

Date

Product data sheet

Application

Wall luminaire · indoor luminaire made of hand-blown opal glass, with metal housing.
The light aperture can be adjusted infinitely by rotating the shield around its longitudinal axis.
Light aperture 120°; adjustable.

Product description

Die-cast aluminium and aluminium housing, finish white enamel
Hand-blown opal glass
2 mounting holes \varnothing 6 mm
Elongated holes · 100 mm spacing
Connecting terminal 2.5[□]
Earth conductor connection
Replacement of lamp without tools.
Built-in toggle switch
Lampholder G 24 q-2
Electronic ballast (EEI=A2 BAT)
220-240 V \sim 0/50-60 Hz
DC 176-264 V
DC Start \geq 198 V
Safety class I
 – Safety mark
 – Conformity mark
Weight: 1.2 kg

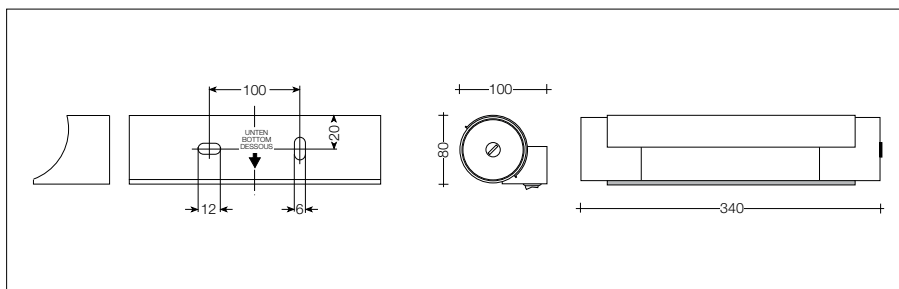
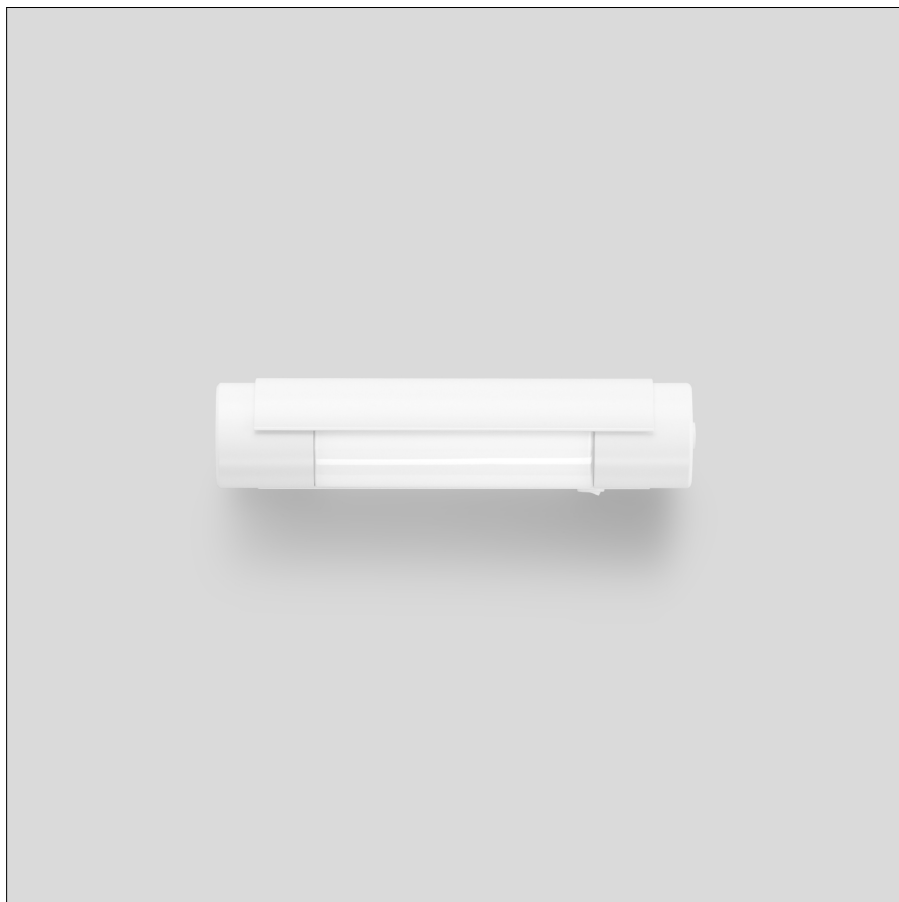

Lamp

Compact fluorescent lamp
TC-DEL 18 W · G 24 q-2

Osram: Dulux D/E 18 W 1200 lm
Philips: PL-C 18 W/4p 1200 lm

Please note the lamp manufacturers' operating instructions.

Article No. 89 875.1

Finish options

- Enamel, white
- Stainless steel

Code number **.1**
Code number **.2**