

**BEGA****84 815**

Surface-mounted luminaire



Project · Reference number

Date

## Product data sheet

### Application

LED luminaire for glare-free illumination of floor surfaces from an extremely low mounting height. For the illumination of forecourts, gateways and ways in private and public facilities.

### Product description

Luminaire made of aluminium alloy,  
aluminium and stainless steel  
Clear safety glass  
Silicone gasket  
Luminaire with mounting plate for bolting onto a foundation or an anchorage unit  
2 inner screw cable glands complete with cone-thrust collar, gaskets and dummy plugs, suitable for through-wiring of mains supply cable of  $\varnothing$  9 - 15 mm max.  $5 \times 2.5^{\square}$   
Connecting terminal and earth conductor terminal  $2.5^{\square}$   
LED power supply unit  
220-240 V  $\sim$  0/50-60 Hz  
DC 176-276 V  
DALI controllable  
A basic isolation exists between power cable and control line  
Safety class I  
Protection class IP 67  
Dust-tight and protection against temporary immersion  
Impact strength IK09  
Protection against mechanical impacts < 10 joule  
 – Safety mark  
 – Conformity mark  
Weight: 2.6 kg

### Lamp

Module connected wattage	16.4 W
Luminaire connected wattage	19.5 W
Rated temperature	$t_a = 25^{\circ}\text{C}$
Ambient temperature	$t_{a, \text{max}} = 45^{\circ}\text{C}$

On request we can offer you modifications for environments with higher temperatures as a customized product.

### 84 815 K4

Module designation	LED-0799/840
Colour temperature	4000 K
Colour rendering index	CRI > 80
Module luminous flux	2250 lm
Luminaire luminous flux	712 lm
Luminaire luminous efficiency	36,5 lm/W

### 84 815 K3

Module designation	LED-0799/830
Colour temperature	3000 K
Colour rendering index	CRI > 80
Module luminous flux	2250 lm
Luminaire luminous flux	712 lm
Luminaire luminous efficiency	36,5 lm/W

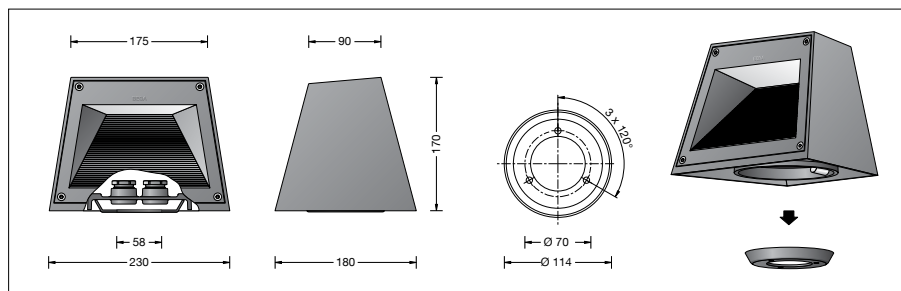

### Lifetime of the LED

Ambient temperature  $t_a = 15^{\circ}\text{C}$   
– at 50,000 h: L90 B10  
– at 322,000 h: L70 B50

Ambient temperature  $t_a = 25^{\circ}\text{C}$   
– at 50,000 h: L80 B10  
– at 174,000 h: L70 B50

max. ambient temperature  $t_a = 45^{\circ}\text{C}$   
– at 50,000 h: L70 B50  
– at 57,000 h: L70 B50

### Inrush current

Inrush current: 21 A / 18.2  $\mu\text{s}$   
Maximum number of luminaires of this type per miniature circuit breaker:

B10A:	50 luminaires
B16A:	50 luminaires
C10A:	50 luminaires
C16A:	50 luminaires

### Article No. 84 815

LED colour temperature optionally 4000 K or 3000 K  
4000 K – Article number + **K4**  
3000 K – Article number + **K3**

Colour graphite or silver  
graphite – article number  
silver – article number + **A**

### Accessory

**70 894** Anchorage unit  
Anchorage unit with mounting flange made of galvanised steel.  
Total length 400 mm.  
3 stainless steel mounting screws M 6.  
Pitch circle  $\varnothing$  70 mm.

For the accessories a separate instructions for use can be provided upon request.