

BEGA**84 258**

Surface floodlight



Project · Reference number

Date

Product data sheet

Application

LED surface floodlight with mounting box and outrigger arm for installation on ceilings and walls. With asymmetrical light distribution for illuminating wall-, ceiling-, ground surfaces or advertising boards.

Product description

Luminaire made of aluminium alloy, aluminium and stainless steel
 BEGA Unidure® coating technology
 Safety glass
 Reflector made of pure anodised aluminium
 Rotation range surface floodlight 350°
 Swivel range of outrigger arm:
 Joint mounting box 0°-180° in steps of 22,5°
 Joint surface floodlight: -60°/+120° infinitely
 Mounting plate with 3 fixing holes \varnothing 5.3 mm
 Angle 120° · Pitch circle \varnothing 52 mm
 1 cable entry for mains supply cable up to \varnothing 10,5 mm max. $3 \times 1,5^{\square}$
 Connection terminal 2.5 $^{\square}$
 Earth conductor connection
 LED power supply unit
 220-240 V \sim 0/50-60 Hz
 DC 176-280 V
 BEGA Thermal Switch®
 Temporary thermal shutdown to protect temperature-sensitive components
 Safety class I
 Protection class IP 65
 Dust-tight and protection against water jets
 Impact strength IK07
 Protection against mechanical impacts < 2 joule
 – Safety mark
 – Conformity mark
 Weight: 2.0 kg

Lamp

| | |
|-----------------------------|--|
| Module connected wattage | 11.5 W |
| Luminaire connected wattage | 13.5 W |
| Rated temperature | $t_a = 25^{\circ}\text{C}$ |
| Ambient temperature | $t_{a\text{max}} = 45^{\circ}\text{C}$ |

On request we can offer you modifications for environments with higher temperatures as a customized product.

84 258 K3

| | |
|-------------------------------|--------------|
| Module designation | LED-0590/930 |
| Colour temperature | 3000 K |
| Colour rendering index | CRI > 90 |
| Module luminous flux | 1515 lm |
| Luminaire luminous flux | 1146 lm |
| Luminaire luminous efficiency | 84,9 lm/W |

84 258 K4

| | |
|-------------------------------|--------------|
| Module designation | LED-0590/940 |
| Colour temperature | 4000 K |
| Colour rendering index | CRI > 90 |
| Module luminous flux | 1570 lm |
| Luminaire luminous flux | 1188 lm |
| Luminaire luminous efficiency | 88 lm/W |

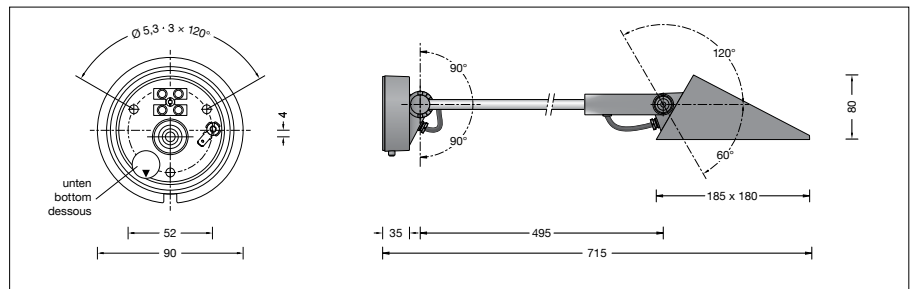
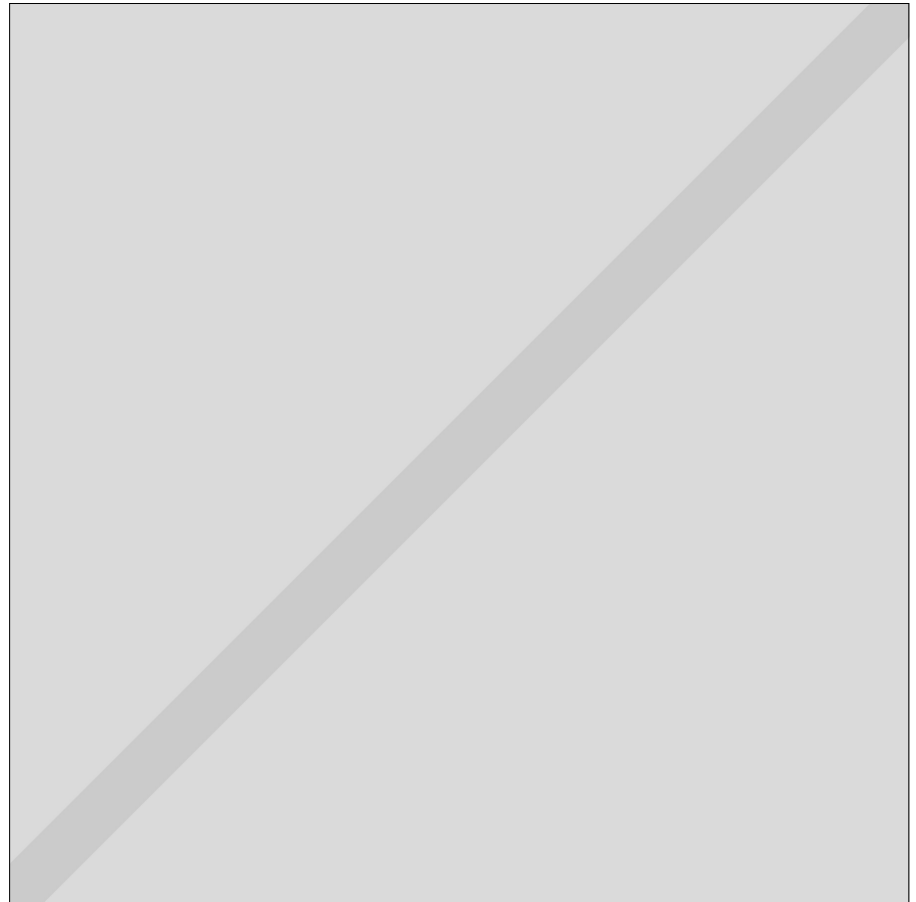

Service life · Ambient temperature

Rated temperature $t_a = 25^{\circ}\text{C}$
 LED psu: > 50,000h
 LED module: > 200,000h (L 80 B 50)
 100,000h (L 90 B 50)

Ambient temperature $t_{a\text{max}} = 45^{\circ}\text{C}$ (100 %)
 LED psu: 50,000h
 LED module: 98,000h (L 80 B 50)
 100,000h (L 70 B 50)

Inrush current

Inrush current: 20 A / 80 μs
 Maximum number of luminaires of this type per miniature circuit breaker:
 B 10 A: 35 luminaires
 B 16 A: 56 luminaires
 C 10 A: 58 luminaires
 C 16 A: 94 luminaires

Article No. 84 258

LED colour temperature optionally 4000 K or 3000 K
 4000 K – Article number + **K4**
 3000 K – Article number + **K3**

Colour graphite or silver
 graphite – article number
 silver – article number + **A**

Light technique

Luminaire data for the light planning program DIALux for outdoor lighting, street lighting and indoor lighting as well as luminaire data in EULUMDAT- and IES-format you will find on the BEGA web page www.bega.com.

Light distribution

