

BEGA**77 930**

Pole top luminaire



Project · Reference number

Date

Product data sheet

Application

LED pole top luminaire with asymmetrical flat beam light distribution.
The asymmetrical and flat beam light distribution is suitable especially for the illumination of streets according to DIN EN 13201.
For mounting heights 3000 - 6000 mm.

Product description

Luminaire made of aluminium alloy,
aluminium and stainless steel
Clear safety glass
Silicone gasket
Reflector made of pure anodised aluminium
For pole top ø 76 mm
Slip fitter insert depth 135 mm
Connecting cable X05BQ-F 5 G 1[□]
Cable length 6 m
LED power supply unit
220-240 V ~ 0/50-60 Hz
DC 176-264 V
During DC operation the LED power is reduced to 50 %
DALI controllable
A basic isolation exists between power cable and control line
BEGA Thermal Control®
Temporary thermal regulation to protect temperature-sensitive components without switching off the luminaire
Safety class I
Protection class IP 66
Dust-tight and protection against strong water jets
Impact strength IK08
Protection against mechanical impacts < 5 joule
 – Safety mark
 – Conformity mark
Horizontal wind catching area: 0.13 m²
Weight: 13.0 kg

Inrush current

Inrush current: 5 A / 100 µs
Maximum number of luminaires of this type per miniature circuit breaker:
B 10A: 27 luminaires
B 16A: 44 luminaires
C 10A: 27 luminaires
C 16A: 44 luminaires

Lamp

| | |
|-----------------------------|-----------------------------------|
| Module connected wattage | 23.2 W |
| Luminaire connected wattage | 26 W |
| Rated temperature | $t_a = 25\text{ °C}$ |
| Ambient temperature | $t_{a\text{ max}} = 55\text{ °C}$ |

77 930 K4

| | |
|-------------------------------|-----------------|
| Module designation | 2x LED-0403/840 |
| Colour temperature | 4000 K |
| Colour rendering index | CRI > 80 |
| Module luminous flux | 4640 lm |
| Luminaire luminous flux | 3670 lm |
| Luminaire luminous efficiency | 141,2 lm/W |

77 930 K3

| | |
|-------------------------------|-----------------|
| Module designation | 2x LED-0403/830 |
| Colour temperature | 3000 K |
| Colour rendering index | CRI > 80 |
| Module luminous flux | 4510 lm |
| Luminaire luminous flux | 3567 lm |
| Luminaire luminous efficiency | 137,2 lm/W |

Light distribution

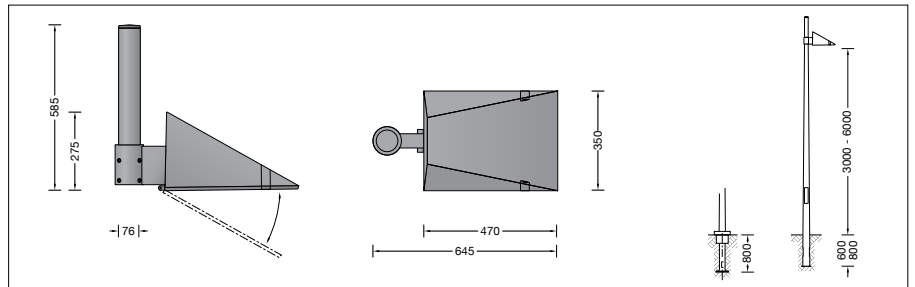
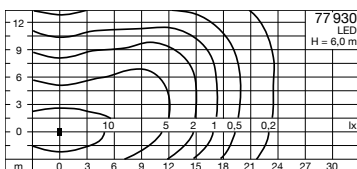

Service life of the LED

Ambient temperature $t_a = 25\text{ °C}$
– at > 500,000h: L70B50

max. ambient temperature $t_a = 55\text{ °C}$
– at 179,000h: L70B50

Light technique

Luminaire data for the light planning program
DIALux for outdoor lighting, street lighting and indoor lighting as well as luminaire data in EULUMDAT- and IES-format you will find on the BEGA web page www.bega.com.

Article No. 77 930

LED colour temperature optionally 4000 K or 3000 K
4000 K – Article number + **K4**
3000 K – Article number + **K3**

Colour graphite or silver
graphite – article number
silver – article number + **A**

Accessories

For this luminaire we recommend the following BEGA luminaire poles:

Tapered aluminium poles,
lacquered with access door and C-clamp

| | |
|-------------------------------------|-----------|
| 70918 Pole with anch.section | H 3000 mm |
| 70913 Pole with anch.section | H 3500 mm |
| 70914 Pole with anch.section | H 4000 mm |
| 70725 Pole with anch.section | H 4500 mm |
| 70915 Pole with anch.section | H 5000 mm |
| 70916 Pole with anch.section | H 6000 mm |

For this luminaire additional accessories are available – see BEGA web page www.bega.com.