

BEGA**77 929**

Pole top luminaire



Project · Reference number

Date

Product data sheet

Application

LED pole top luminaire with asymmetrical flat beam light distribution.
The asymmetrical and flat beam light distribution is suitable especially for the illumination of streets according to DIN EN 13201.
For mounting heights 3000 - 6000 mm.

Product description

Luminaire made of aluminium alloy,
aluminium and stainless steel
BEGA Unidure® coating technology
Safety glass with optical structure
Silicone gasket
Reflector made of pure anodised aluminium
For pole top \varnothing 76 mm
Slip fitter insert depth 135 mm
Connecting cable X05BQ-F 5 G 1[□]
Cable length 6 m
LED power supply unit
220-240 V \sim 0/50-60 Hz
DC 176-276 V
DALI controllable
A basic isolation exists between power cable
and control line
BEGA Thermal Control®
Temporary thermal regulation to protect
temperature-sensitive components without
switching off the luminaire
Safety class I
Protection class IP 66
Dust-tight and protection against strong water
jets
Impact strength IK08
Protection against mechanical
impacts < 5 joule
 – Safety mark
 – Conformity mark
Horizontal wind catching area: 0.13 m²
Weight: 8.4 kg

Lamp

Module connected wattage 15.6 W
Luminaire connected wattage 18.5 W
Rated temperature $t_a = 25\text{ }^\circ\text{C}$
Ambient temperature $t_{a\text{max}} = 55\text{ }^\circ\text{C}$

77 929 K4

Module designation 2x LED-0316/840
Colour temperature 4000 K
Colour rendering index CRI > 80
Module luminous flux 3090 lm
Luminaire luminous flux 2444 lm
Luminaire luminous efficiency 132,1 lm/W

77 929 K3

Module designation 2x LED-0316/830
Colour temperature 3000 K
Colour rendering index CRI > 80
Module luminous flux 3000 lm
Luminaire luminous flux 2374 lm
Luminaire luminous efficiency 128,3 lm/W

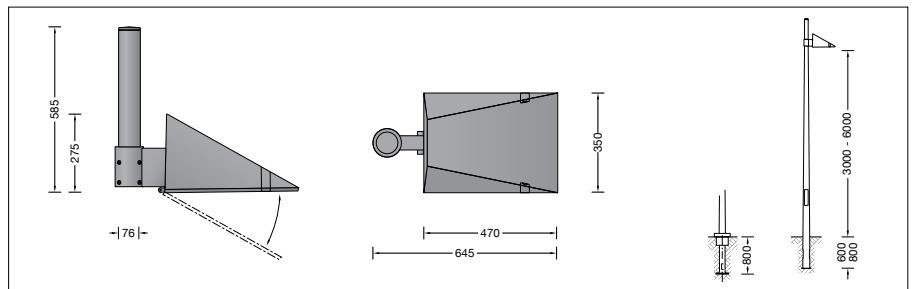

Service life · Ambient temperature

Rated temperature $t_a = 25\text{ }^\circ\text{C}$
LED psu: > 50,000h
LED module: > 200,000h (L80B50)
100,000h (L90B50)

Ambient temperature $t_{a\text{max}} = 55\text{ }^\circ\text{C}$ (100 %)
LED psu: 50,000h
LED module: 146,000h (L80B50)

Article No. 77 929

LED colour temperature optionally 4000K
or 3000K
4000 K – Article number + **K4**
3000 K – Article number + **K3**

Colour graphite or silver
graphite – article number
silver – article number + **A**

Accessories

For this luminaire we recommend the following
BEGA luminaire poles:

Tapered aluminium poles,
lacquered with access door and C-clamp

70918	Pole with anch.section	H 3000 mm
70913	Pole with anch.section	H 3500 mm
70914	Pole with anch.section	H 4000 mm
70725	Pole with anch.section	H 4500 mm
70915	Pole with anch.section	H 5000 mm
70916	Pole with anch.section	H 6000 mm

Light distribution

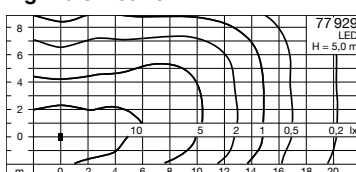

Light technique

Luminaire data for the light planning program
DIALux for outdoor lighting, street lighting and
indoor lighting as well as luminaire data in
EULUMDAT- and IES-format you will find on the
BEGA web page www.bega.com.

Inrush current

Inrush current: 12 A / 24.2 μs
Maximum number of luminaires of this
type per miniature circuit breaker:

B 10A:	50 luminaires
B 16A:	50 luminaires
C 10A:	50 luminaires
C 16A:	50 luminaires

For this luminaire additional accessories are
available – see BEGA web page www.bega.com.