

BEGA**77 630**

Surface-mounted luminaire

IP 67

Project · Reference number

Date

Product data sheet**Application**

LED surface-mounted luminaire for illuminating vertical surfaces.
For the illumination of facades and building parts or details of landscape architecture.
The used LED technique offers durability and optimal light output with low power consumption at the same time.

Product description

Luminaire made of aluminium alloy, aluminium and stainless steel
Clear safety glass
Silicone gasket
Reflector made of pure anodised aluminium
Luminaire with mounting plate for bolting onto a foundation or an anchorage unit
Mounting plate with 3 fixing holes \varnothing 6.5 mm
Angle 120° · Pitch circle \varnothing 70 mm
2 inner screw cable glands complete with cone-thrust collar, gaskets and dummy plugs, suitable for through-wiring of mains supply cable of \varnothing 9 - 15 mm max. 5×2.5^2
Connecting terminal and earth conductor terminal 2.5^2
LED power supply unit
220-240 V \approx 0/50-60 Hz
DC 170-280 V
DALI controllable
A basic isolation exists between power cable and control line
Safety class I
Protection class IP 67
Dust-tight and protection against temporary immersion
CE – Conformity mark
Weight: 2.7 kg

Inrush current

Inrush current: 5 A / 50 μ s
Maximum number of luminaires of this type per miniature circuit breaker:
B 10 A: 30 luminaires
B 16 A: 50 luminaires
C 10 A: 52 luminaires
C 16 A: 85 luminaires

Lamp

Module connected wattage 17.9 W
Luminaire connected wattage 20.8 W
Rated temperature $t_a = 25^\circ\text{C}$
Ambient temperature $t_{a\text{max}} = 35^\circ\text{C}$

77 630

Module designation LED-0313/940
Colour temperature 4000 K
Colour rendering index $R_a > 90$
Module luminous flux 2825 lm
Luminaire luminous flux* 2258 lm
Luminaire luminous efficiency* 108,6 lm/W

77 630 K3

Module designation LED-0313/930
Colour temperature 3000 K
Colour rendering index $R_a > 90$
Module luminous flux 2740 lm
Luminaire luminous flux* 2190 lm
Luminaire luminous efficiency* 105,3 lm/W

* preliminary data

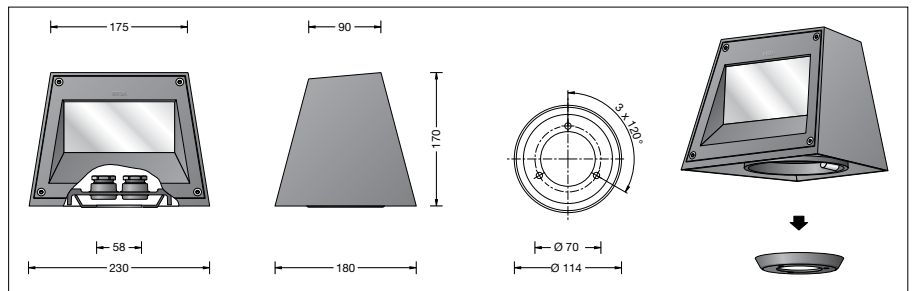
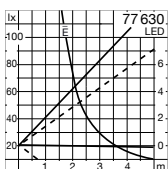
Light distribution**Lifetime of the LED**

Ambient temperature $t_a = 15^\circ\text{C}$
– at 50,000 h: L 90 B 10
– at > 500,000 h: L 70 B 50

Ambient temperature $t_a = 25^\circ\text{C}$
– at 50,000 h: L 90 B 10
– at 414,000 h: L 70 B 50

max. ambient temperature $t_a = 35^\circ\text{C}$
– at 50,000 h: L 80 B 10
– at 222,000 h: L 70 B 50

Article No. 77 630

Colour temperature 4000 K.
Also available with 3000 K on request.
4000 K – article number
3000 K – article number + **K3**

Colour graphite or silver
graphite – article number
silver – article number + **A**

Accessory

70 894 Anchorage unit
Anchorage unit with mounting flange made of galvanised steel.
Total length 400 mm.
3 stainless steel mounting screws M 6.
Pitch circle \varnothing 70 mm.

See the separate instructions for use.