

BEGA

77 552

Floodlight



Project · Reference number

Date



Product data sheet

Application

LED floodlight for broad spread light distribution. Floodlight with mounting box and outrigger arm for installation on ceilings and walls in interior and exterior application. The adjustability of the outrigger arm allows a variety of burning positions with which most diverse lighting tasks can be solved.

Product description

Luminaire made of aluminium alloy, aluminium and stainless steel
 Safety glass with optical structure
 Silicone gasket
 Reflector made of pure anodised aluminium
 Adjustment range:
 Joint - mounting box: ± 75° in steps of 15°
 Swivel joint - outrigger arm: ± 165°
 Floodlight housing: +120° / -75° infinitely adjustable
 Mounting box with 2 fixing holes
 ø 6.3 mm · 48 x 160 mm spacing
 2 cable entries for through-wiring of mains supply cable ø 7-10.5 mm, max. 5G1.5[□]
 Connection terminal 2.5[□]
 Earth conductor connection
 LED power supply unit
 220-240 V ~ 0/50-60 Hz
 DC 176-280 V
 DALI controllable
 A basic isolation exists between power cable and control line
 Safety class I
 Protection class IP 65
 Dust-tight and protection against water jets
 Impact strength IK07
 Protection against mechanical impacts < 2 joule
 - Safety mark
 - Conformity mark
 Wind catching area: 0.04 m²
 Weight: 2.4 kg

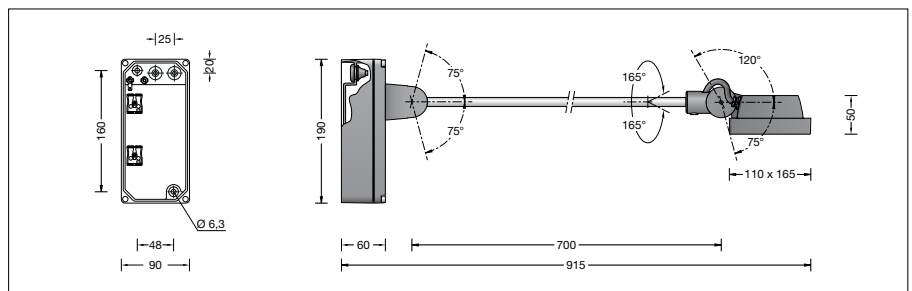

Lamp

Module connected wattage 17.9 W
 Luminaire connected wattage 21 W
 Rated temperature $t_a = 25\text{ °C}$
 Ambient temperature $t_{a\text{max}} = 50\text{ °C}$

On request we can offer you modifications for environments with higher temperatures as a customized product.

Inrush current

Inrush current: 5 A / 50 µs
 Maximum number of luminaires of this type per miniature circuit breaker:
 B 10A: 31 luminaires
 B 16A: 50 luminaires
 C 10A: 52 luminaires
 C 16A: 85 luminaires

Light technique

Broad spread light distribution.
 Half beam angle 76/89°
 Luminaire data for the light planning program DIALux for outdoor lighting, street lighting and indoor lighting, as well as luminaire data in EULUMDAT and IES format are available on the BEGA website at www.bega.com.

Article No. 77 552

LED colour temperature optionally 4000 K or 3000 K
 4000 K – Article number + **K4**
 3000 K – Article number + **K3**
 Colour optionally graphite, white or silver
 Graphite – Article number
 White – Article number + **W**
 Silver – Article number + **A**

Accessories

70 500 Shield
 The attachable shield screens the light upwards or downwards.

A separate instructions for use can be provided upon request.

77 552 K4

Module designation LED-0313/940
 Colour temperature 4000 K
 Colour rendering index CRI > 90
 Module luminous flux 2825 lm
 Luminaire luminous flux 2298 lm
 Luminaire luminous efficiency 109,4 lm/W

77 552 K3

Module designation LED-0313/930
 Colour temperature 3000 K
 Colour rendering index CRI > 90
 Module luminous flux 2740 lm
 Luminaire luminous flux 2286 lm
 Luminaire luminous efficiency 108,9 lm/W

Lifetime of the LED

Ambient temperature $t_a = 25\text{ °C}$
 – at > 500,000h: L 70 B 50

max. ambient temperature $t_a = 50\text{ °C}$
 – at 143,000h: L 70 B 50

Light distribution

