

BEGA**50 604.5**

Wall luminaire for indoor use



Project · Reference number

Date



Product data sheet

Application

LED wall luminaire · indoor luminaire with integrated power supply unit for many lighting tasks in interior applications.

The light emits upwards and downwards.

Product description

Luminaire made of aluminium alloy, velvet black enamel finish
 Safety glass
 Reflectors made of anodised pure aluminium
 2 elongated fixing holes
 Width 5 mm · 76,5 mm spacing
 1 cable entry for mains supply cable up to \varnothing 10,5 mm max. $5 \times 1,5^{\square}$
 Connecting terminal $2,5^{\square}$ with plug connection
 Earth conductor connection
 Connecting terminals for digital control
 LED power supply unit
 220-240 V \sim 0/50-60 Hz
 DALI controllable
 A basic isolation exists between power cable and control line
 Safety class I
 – Safety mark
 – Conformity mark
 Weight: 2,6 kg

Inrush current

Inrush current: 5 A / 50 μ s
 Maximum number of luminaires of this type per miniature circuit breaker:
 B 10A: 31 luminaires
 B 16A: 50 luminaires
 C 10A: 52 luminaires
 C 16A: 85 luminaires

Lamp

Module connected wattage	24.1 W
Luminaire connected wattage	28.3 W
Rated temperature	$t_a = 25^{\circ}\text{C}$
Ambient temperature	$t_{a\text{max}} = 35^{\circ}\text{C}$

50 604.5 K3

Module designation	2x LED-0800/930
Colour temperature	3000 K
Colour rendering index	CRI > 90
Module luminous flux	3350 lm
Luminaire luminous flux	2520 lm
Luminaire luminous efficiency	89 lm/W

50 604.5 K4

Module designation	2x LED-0800/940
Colour temperature	4000 K
Colour rendering index	CRI > 90
Module luminous flux	3400 lm
Luminaire luminous flux	2556 lm
Luminaire luminous efficiency	90,3 lm/W

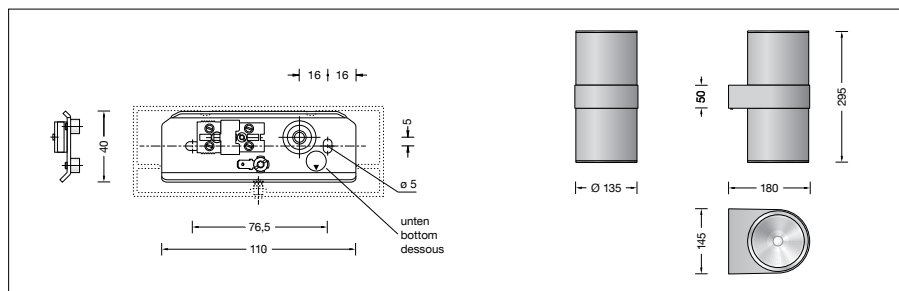

Service life of the LED

Ambient temperature $t_a = 25^{\circ}\text{C}$
 – at 390,000h: L70B50

max. ambient temperature $t_a = 35^{\circ}\text{C}$
 – at 350,000h: L70B50

Light technique

Luminaire data for the light planning program DIALux for outdoor lighting, street lighting and indoor lighting as well as luminaire data in EULUMDAT- and IES-format you will find on the BEGA web page www.bega.com.

Article No. 50 604.5

LED colour temperature optionally 3000 K or 4000 K
 3000 K – Article number + **K3**
 4000 K – Article number + **K4**

Optional finishes

- Velvet white enamel finish Code number **.1**
- Velvet black enamel finish Code number **.5**