

BEGA**33 049**

Recessed luminaire



Project · Reference number

Date

Product data sheet

Application

LED luminaire with asymmetrical flat beam light distribution for installation in walls or stairs.

Product description

Luminaire made of aluminium alloy, aluminium and stainless steel
 Safety glass with optical structure
 Reflector made of pure anodised aluminium
 Fixing is achieved by using two adjustable wedge-shaped claws
 Required recessed opening 306 x 60 mm
 Recessed depth 70 mm
 2 cable entries for through-wiring of mains supply cable \varnothing 7-10.5 mm
 Connection terminal 2.5²
 Earth conductor connection
 LED power supply unit
 220-240 V \sim 0/50-60 Hz
 DC 170-280 V
 Safety class I
 Protection class IP 65
 Dust-tight and protection against water jets
 Impact strength IK08
 Protection against mechanical impacts < 5 joule
 – Safety mark
 – Conformity mark
 Weight: 0.95 kg

Inrush current

Inrush current: 27 A / 250 μ s
 Maximum number of luminaires of this type per miniature circuit breaker:
 B 10A: 17 luminaires
 B 16A: 27 luminaires
 C 10A: 28 luminaires
 C 16A: 46 luminaires

Lamp

Module connected wattage	8.2 W
Luminaire connected wattage	11 W
Rated temperature	$t_a = 25^\circ\text{C}$
Ambient temperature	$t_{a\text{max}} = 35^\circ\text{C}$

On request we can offer you modifications for environments with higher temperatures as a customized product.

33 049 K3

Module designation	LED-0545/830
Colour temperature	3000 K
Colour rendering index	CRI > 80
Module luminous flux	1130 lm
Luminaire luminous flux	621 lm
Luminaire luminous efficiency	56,5 lm/W

33 049 K4

Module designation	LED-0545/840
Colour temperature	4000 K
Colour rendering index	CRI > 80
Module luminous flux	1130 lm
Luminaire luminous flux	621 lm
Luminaire luminous efficiency	56,5 lm/W

Light distribution

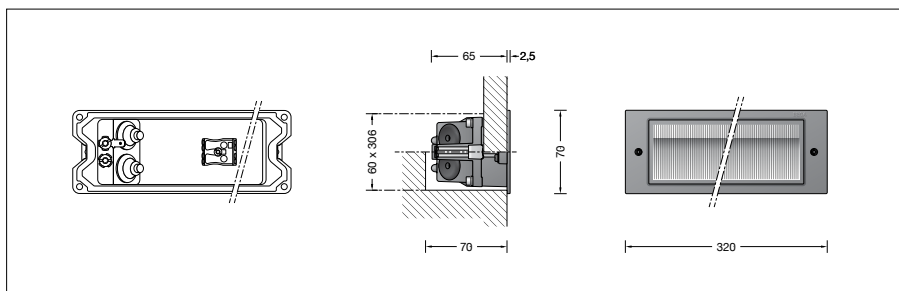
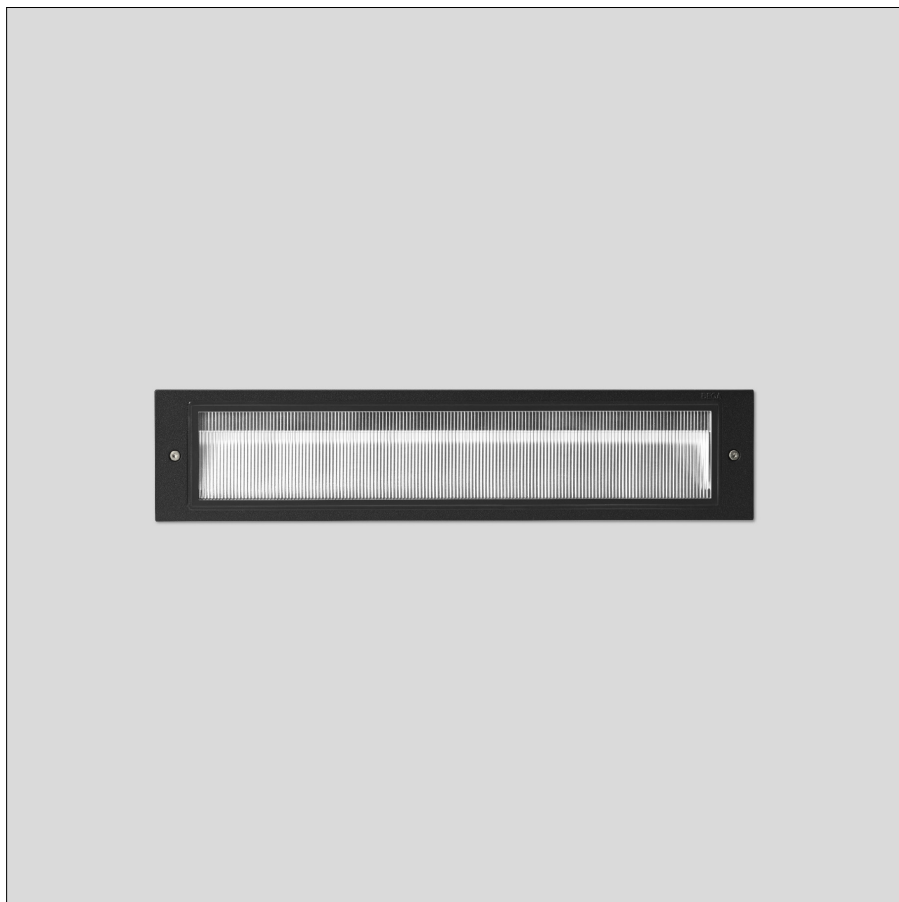
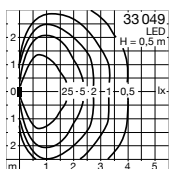

Service life · Ambient temperature

Ambient temperature $t_a = 25^\circ\text{C}$	
LED psu:	> 50,000 h
LED module:	151,000 h (L 80 B 50) 100,000 h (L 80 B 50)

Ambient temperature $t_a = 35^\circ\text{C}$	
LED psu:	50,000 h
LED module:	82,000 h (L 80 B 50) 100,000 h (L 70 B 50)

Article No. 33 049

LED colour temperature optionally 3000 K or 4000 K
 3000 K – Article number + **K3**
 4000 K – Article number + **K4**

Colour graphite or silver
 graphite – article number
 silver – article number + **A**

Accessories

10 426 Installation housing
13 521 Installation housing for installation in insulated façades (EWIS)

10 026 Plaster frame
13 505 Plaster frame flush

A separate instructions for use can be provided upon request.