

BEGA**33 023**

Recessed luminaire



Project · Reference number

Date

Product data sheet

Application

LED luminaire with asymmetrical flat beam light distribution for installation in walls or stairs.

Product description

Luminaire made of aluminium alloy, aluminium and stainless steel
 Safety glass with optical structure
 Silicone gasket
 Reflector made of pure anodised aluminium
 Fixing is achieved by using two adjustable wedge-shaped claws
 Required recessed opening 155 x 60 mm
 Recessed depth 70 mm
 2 cable entries for through-wiring of mains supply cable \varnothing 7-10,5 mm
 Connection terminal 2.5[□]
 Earth conductor connection
 LED power supply unit
 220-240 V \sim 0/50-60 Hz
 DC 176-264 V
 Safety class I
 Protection class IP 65
 Dust-tight and protection against water jets
 Impact strength IK08
 Protection against mechanical impacts < 5 joule
 – Safety mark
 – Conformity mark
 Weight: 0.55 kg

Lamp

Module connected wattage	4.1 W
Luminaire connected wattage	5.2 W
Rated temperature	$t_a = 25$ °C
Ambient temperature	$t_{a \max} = 40$ °C
When installed in heat-insulating material	$t_{a \max} = 30$ °C

On request we can offer you modifications for environments with higher temperatures as a customized product.

33 023 K3

Module designation	LED-0525/830
Colour temperature	3000 K
Colour rendering index	CRI > 80
Module luminous flux	565 lm
Luminaire luminous flux	301 lm
Luminaire luminous efficiency	57,9 lm/W

33 023 K4

Module designation	LED-0525/840
Colour temperature	4000 K
Colour rendering index	CRI > 80
Module luminous flux	565 lm
Luminaire luminous flux	301 lm
Luminaire luminous efficiency	57,9 lm/W

Light distribution

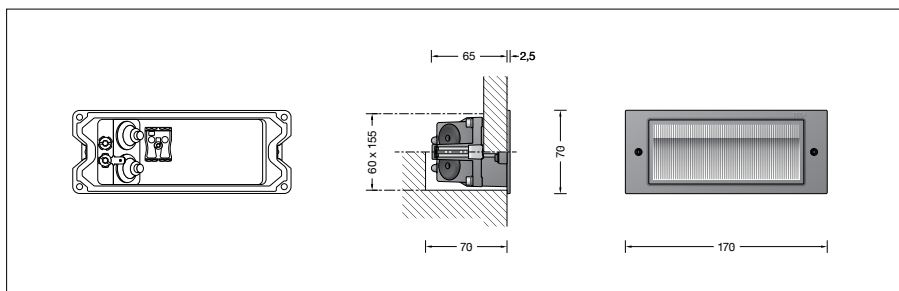
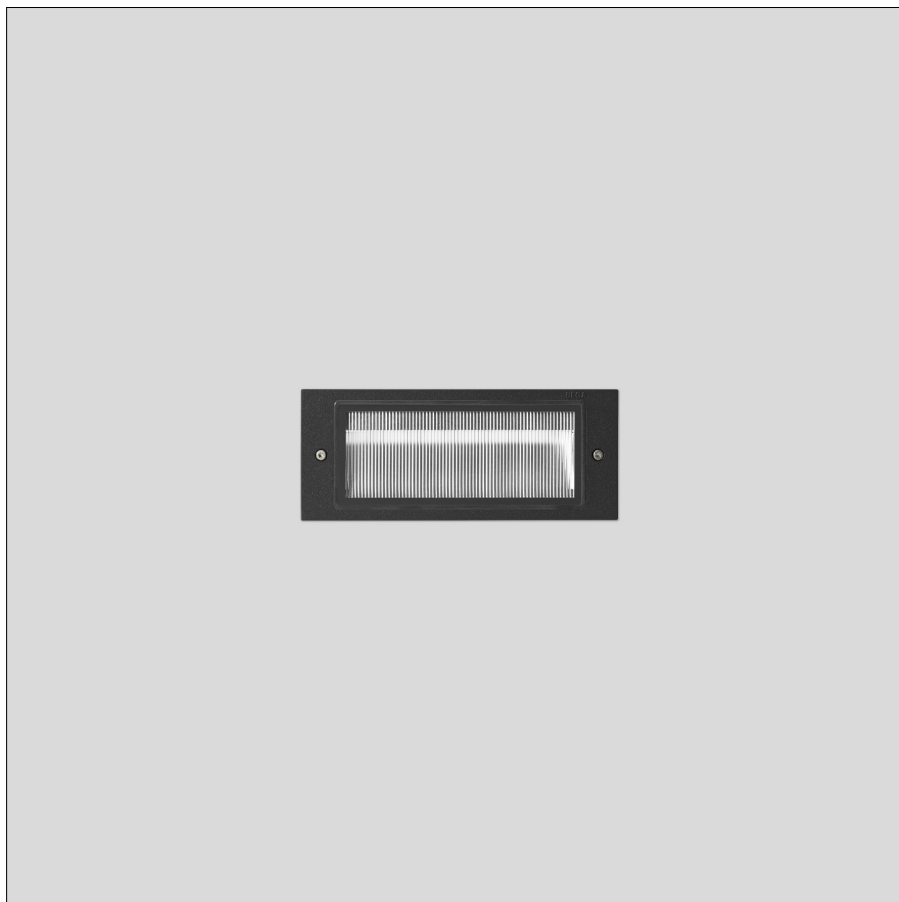
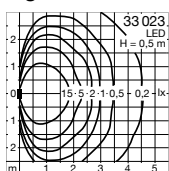

Service life · Ambient temperature

Ambient temperature $t_a = 25$ °C	
LED psu:	> 50,000 h
LED module:	175,000 h (L 80 B 50)
	100,000 h (L 90 B 50)

Ambient temperature $t_a = 40$ °C	
LED psu:	50,000 h
LED module:	70,000 h (L 80 B 50)
	100,000 h (L 70 B 50)

Inrush current

Inrush current: 7 A / 112 μ s
 Maximum number of luminaires of this type per miniature circuit breaker:
 B 10A: 38 luminaires
 B 16A: 61 luminaires
 C 10A: 64 luminaires
 C 16A: 102 luminaires

Article No. 33 023

LED colour temperature optionally 3000 K or 4000 K
 3000 K – Article number + **K3**
 4000 K – Article number + **K4**

Colour graphite or silver
 graphite – article number
 silver – article number + **A**

Accessories

10 424 Installation housing
13 519 Installation housing for installation in insulated façades (EWIS)

10 024 Plaster frame

13 503 Plaster frame flush

A separate instructions for use can be provided upon request.