

BEGA**33 018**

Recessed luminaire



Project · Reference number

Date

Product data sheet

Application

Shielded LED luminaire for walls and stairs.

Product description

Luminaire made of aluminium alloy,
aluminium and stainless steel
Safety glass, white
Silicone gasket
Fixing is achieved by using two adjustable
wedge-shaped claws
Required recessed opening 245 x 60 mm
Recessed depth 70 mm
2 cable entries for through-wiring of mains
supply cable \varnothing 7-10.5 mm
Connection terminal 2.5[□]
Earth conductor connection
LED power supply unit
220-240 V \sim 0/50-60 Hz
DC 198-264 V
Safety class I
Protection class IP 65
Dust-tight and protection against water jets
Impact strength IK09
Protection against mechanical
impacts < 10 joule
 – Safety mark
CE – Conformity mark
Weight: 0.8 kg

Lamp

Module connected wattage	2.7 W
Luminaire connected wattage	4.5 W
Rated temperature	$t_a = 25$ °C
Ambient temperature	$t_{a \max} = 45$ °C
When installed in heat-insulating material	$t_{a \max} = 40$ °C

On request we can offer you modifications for
environments with higher temperatures as a
customized product.

33 018 K3

Module designation	LED-0642/830
Colour temperature	3000 K
Colour rendering index	CRI > 80
Module luminous flux	405 lm
Luminaire luminous flux	44 lm
Luminaire luminous efficiency	9,8 lm/W

33 018 K4

Module designation	LED-0642/840
Colour temperature	4000 K
Colour rendering index	CRI > 80
Module luminous flux	445 lm
Luminaire luminous flux	48 lm
Luminaire luminous efficiency	10,7 lm/W

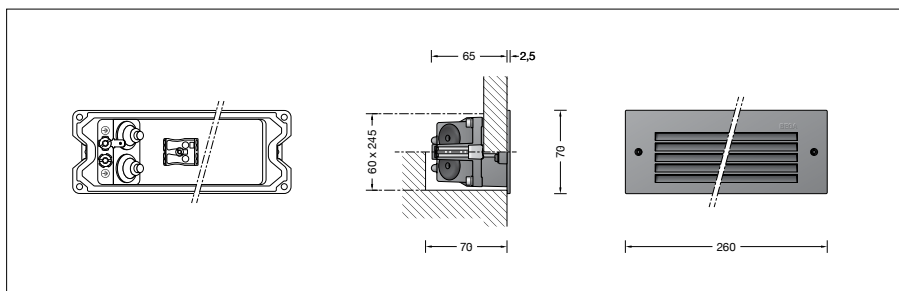
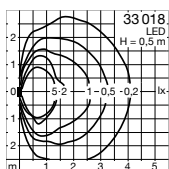
Light distribution**Service life · Ambient temperature**

Rated temperature $t_a = 25$ °C	
LED psu:	> 50,000 h
LED module:	130,000 h (L80 B50)
Ambient temperature $t_{a \max} = 45$ °C (100 %)	
LED psu:	50,000 h
LED module:	115,000 h (L80 B50)

Inrush current

Inrush current: 27 A / 250 μ s
Maximum number of luminaires of this
type per miniature circuit breaker:
B10A: 17 luminaires
B16A: 27 luminaires
C10A: 28 luminaires
C16A: 45 luminaires

Article No. 33 018

LED colour temperature optionally 3000 K
or 4000 K
3000 K – Article number + **K3**
4000 K – Article number + **K4**

Colour graphite or silver
graphite – article number
silver – article number + **A**

Accessories

10 425 Installation housing
13 520 Installation housing for installation in
insulated façades (EWIS)

10 025 Plaster frame
13 504 Plaster frame flush

A separate instructions for use can be provided
upon request.