

BEGA**31 472**

Wall luminaire



Project · Reference number

Date

Product data sheet

Application

Wall luminaire made of copper and opal glass.
For many lighting tasks on or in buildings.
Ideal for places where a soft and uniform light
distribution is required.

Product description

Luminaire made of copper and stainless steel
Opal glass with screw neck
Mounting plate with 2 fixing
holes \varnothing 5.5 mm · 70 mm spacing
1 cable entry for mains supply cable
up to \varnothing 10,5 mm max. $3 \times 1,5^{\square}$
Connecting terminal 2.5^{\square}
with plug connection
Earth conductor connection
Lampholder E 27
Safety class I
Protection class IP 44
Protected against granular foreign bodies
> 1 mm and splash water
 – Safety mark
CE – Conformity mark
Weight: 1.6 kg

Copper

The luminaire parts made of solid copper are
delivered with the metal's natural surface colour.
Time and weather factors create the natural
patina characteristic for copper.

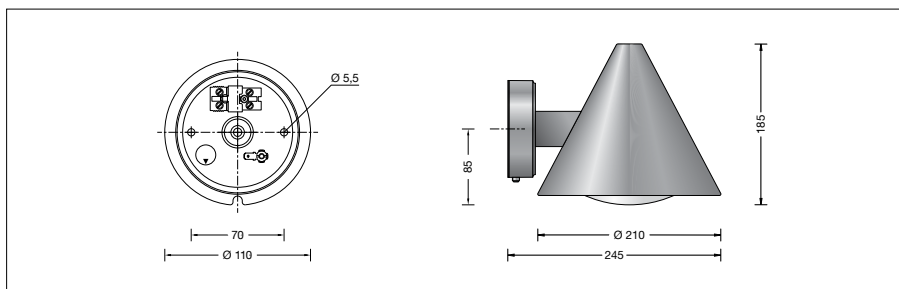

Lamp

Luminaire with lampholder E 27
Lamp output max. 60 W

For this luminaire we recommend the following
BEGA LED lamps:

13 510 LED 7 W · 805 lm · 2700 K

13 548 LED 7 W · 805 lm · 2700 K
dimmmable

13 584 LED 7 W · 805 lm · 3000 K

13 586 LED 7 W · 805 lm · 3000 K
dimmmable

Detailed technical and lighting data for the
lamps can be found in the data sheets on our
website.