

BEGA**24 371**

Wall luminaire

IP 64

Project · Reference number

Date

Product data sheet**Application**

LED wall luminaire with two-sided light distribution opening.
Fully glare free light for lighting wall surfaces.
For interior or exterior lighting design.

Product description

Luminaire made of aluminium alloy,
aluminium and stainless steel
Clear safety glass
Silicone gasket
2 mounting holes \varnothing 4.3 mm
Distance apart 84 mm
2 cable entries for through-wiring of mains
supply cable \varnothing 7-10.5 mm,
max. 3 G 1.5[□]
Connection terminal 2.5[□]
Earth conductor connection
LED power supply unit
220-240 V \sim 0/50-60 Hz
DC 198-280 V
Safety class I
Protection class IP 64
Dust-tight and protection against splash water
Impact strength IK07
Protection against mechanical
impacts < 2 joule
CE – Conformity mark
Weight: 1.3 kg

Inrush current

Inrush current: 5 A / 50 μ s
Maximum number of luminaires of this
type per miniature circuit breaker:
B 10A: 30 luminaires
B 16A: 50 luminaires
C 10A: 52 luminaires
C 16A: 80 luminaires

Lamp

Module connected wattage	16.4 W
Luminaire connected wattage	19.6 W
Rated temperature	$t_a = 25$ °C
Ambient temperature	$t_{a \max} = 30$ °C

On request we can offer you modifications for
environments with higher temperatures as a
customized product.

24 371 K3

Module designation	2x LED-0650/830
Colour temperature	3000 K
Colour rendering index	CRI > 80
Module luminous flux	2260 lm
Luminaire luminous flux	803 lm
Luminaire luminous efficiency	41 lm/W

Service life of the LED

Ambient temperature $t_a = 25$ °C
– at 179,000h: L70B50
max. ambient temperature $t_a = 30$ °C
– at 134,000h: L70B50

Light technique

Luminaire data for the light planning program
DIALux for outdoor lighting, street lighting and
indoor lighting as well as luminaire data in
EULUMDAT- and IES-format you will find on the
BEGA web page www.bega.com.

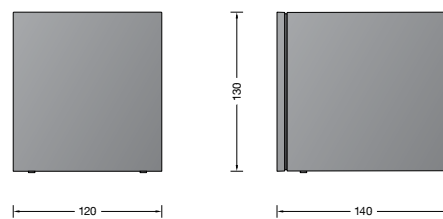
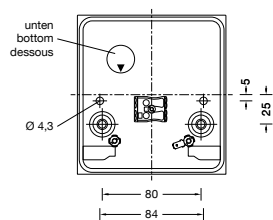
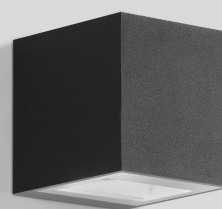
**Light distribution**