

**BEGA****24 352**

Wall luminaire



Project · Reference number

Date

## Product data sheet

### Application

LED wall luminaire with asymmetrical light distribution.  
For lighting ceiling, wall and ground surfaces.  
The asymmetrical light distribution is particularly suitable for the spatial illumination of surfaces.

### Product description

Luminaire made of aluminium alloy, aluminium and stainless steel  
Clear safety glass  
Reflector made of pure anodised aluminium  
Swivel range around the horizontal axis  
+90° to -30° in increments of 10°  
Mounting plate with 3 fixing holes  $\varnothing$  5.5 mm  
Angle 120° · Pitch circle  $\varnothing$  85 mm  
2 cable entries for through-wiring of mains supply cable  $\varnothing$  7-10.5 mm, max. 5G1.5<sup>□</sup>  
Connecting terminal 2.5<sup>□</sup> with plug connection  
Earth conductor connection  
LED power supply unit  
220-240 V  $\sim$  0/50-60 Hz  
DC 176-280 V  
During DC operation the LED power is reduced to 15 %  
DALI controllable  
A basic isolation exists between power cable and control line  
Safety class I  
Protection class IP 65  
Dust-tight and protection against water jets  
 – Safety mark  
 – Conformity mark  
Weight: 7.2 kg

### Lamp

|                             |                                      |
|-----------------------------|--------------------------------------|
| Module connected wattage    | 98.3 W                               |
| Luminaire connected wattage | 108 W                                |
| Rated temperature           | $t_a = 25^\circ\text{C}$             |
| Ambient temperature         | $t_{a\text{max}} = 40^\circ\text{C}$ |

### 24 352 K3

|                               |              |
|-------------------------------|--------------|
| Module designation            | LED-1003/830 |
| Colour temperature            | 3000 K       |
| Colour rendering index        | CRI > 80     |
| Module luminous flux          | 13760 lm     |
| Luminaire luminous flux       | 10526 lm     |
| Luminaire luminous efficiency | 97,5 lm/W    |

### 24 352 K4

|                               |              |
|-------------------------------|--------------|
| Module designation            | LED-1003/840 |
| Colour temperature            | 4000 K       |
| Colour rendering index        | CRI > 80     |
| Module luminous flux          | 13760 lm     |
| Luminaire luminous flux       | 10526 lm     |
| Luminaire luminous efficiency | 97,5 lm/W    |

### Light distribution

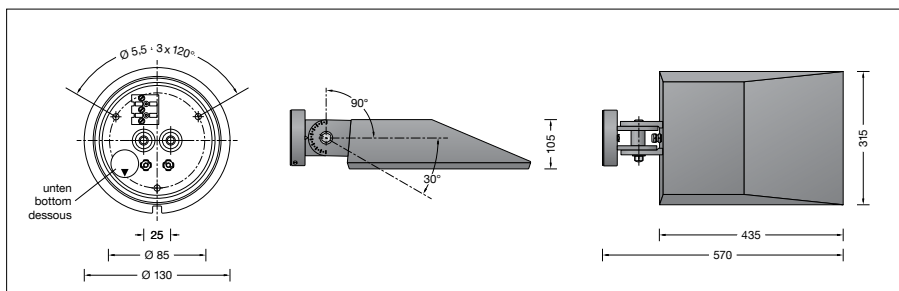
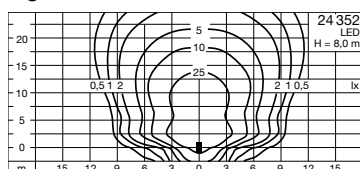

### Service life · Ambient temperature

|  |  |
|--|--|
| Rated temperature $t_a = 25^\circ\text{C}$ |  |
| LED psu:                                   | > 50,000 h                                 |
| LED module:                                | 157,000 h (L80 B50)<br>100,000 h (L80 B50) |

|  |  |
|--|--|
| Ambient temperature $t_{a\text{max}} = 40^\circ\text{C}$ (100 %) |  |
| LED psu:   | 50,000 h                                 |
| LED module:  | 63,000 h (L80 B50)<br>95,000 h (L70 B50) |

|   |          |
|---|----------|
| Ambient temperature $t_{a\text{max}} = 50^\circ\text{C}$ (55 %) |          |
| LED psu:  | 50,000 h |
| LED module:   | 50,000 h |

BEGA Thermal Control® protects temperature-sensitive luminaire components by temporarily limiting the nominal power at high temperatures.

### Light technique

Luminaire data for the light planning program DIALux for outdoor lighting, street lighting and indoor lighting as well as luminaire data in EULUMDAT- and IES-format you will find on the BEGA web page [www.bega.com](http://www.bega.com).

### Article No. 24 352

LED colour temperature optionally 3000 K or 4000 K  
3000 K – Article number + **K3**  
4000 K – Article number + **K4**

Colour graphite or silver  
graphite – article number  
silver – article number + **A**

### Inrush current

Inrush current: 50 A / 209  $\mu\text{s}$   
Maximum number of luminaires of this type per miniature circuit breaker:  
B 10 A: 6 luminaires  
B 16 A: 10 luminaires  
C 10 A: 10 luminaires  
C 16 A: 16 luminaires