

BEGA**12 119.1**

Recessed ceiling luminaire for indoor use



Project · Reference number

Date

Product data sheet

Application

LED recessed ceiling luminaire with adjustable light distribution. A remote power supply unit is required to operate this luminaire. If this luminaire should be integrated into a LCN or Zigbee controlled building management system we recommend our BEGA Control light control system.

Product description

Recessed LED luminaire without power supply unit
Luminaire housing made of aluminium alloy
Metal cover ring
Finish white enamel
Safety glass with optical structure
Silicone gasket
Reflector
Luminaire housing with 2 fixing claws and guide screws
Recessed opening \varnothing 128 mm
Recessed depth required 110 mm
1 connecting cable with strain relief and plug connector system for BEGA power supply unit, on/off or DALI
Safety class III 
CE – Conformity mark
Weight: 0.6 kg

Lamp

Module connected wattage	5.7 W
Luminaire connected wattage	8 W
Rated temperature	$t_a = 25 \text{ }^\circ\text{C}$
Ambient temperature	$t_{a \text{ max}} = 40 \text{ }^\circ\text{C}$

12 119.1 K3

Module designation	LED-0438/930
Colour temperature	3000 K
Colour rendering index	CRI > 90
Module luminous flux	750 lm
Luminaire luminous flux	437 lm
Luminaire luminous efficiency	54,6 lm/W

12 119.1 K4

Module designation	LED-0438/940
Colour temperature	4000 K
Colour rendering index	CRI > 90
Module luminous flux	825 lm
Luminaire luminous flux	481 lm
Luminaire luminous efficiency	60,1 lm/W

Lifetime of the LED

Ambient temperature $t_a = 25 \text{ }^\circ\text{C}$
– at 200,000h: L70B50

max. ambient temperature $t_a = 40 \text{ }^\circ\text{C}$
– at 200,000h: L70B50

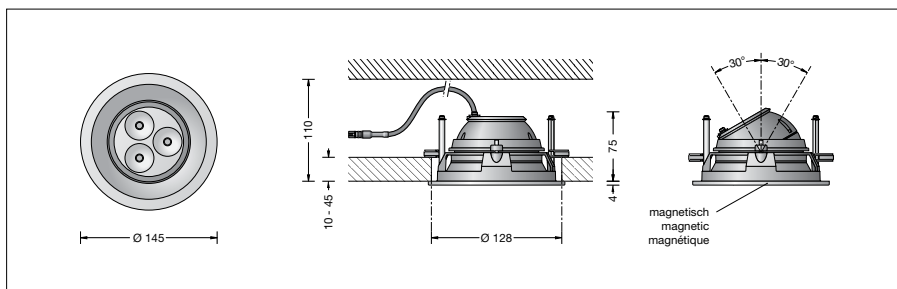

Light technique

Recessed luminaire with adjustable optical system.
Optical system 0-30° swivel-mounted and $\pm 180^\circ$ infinitely rotatable.
Narrow beam rotationally symmetrical light distribution. Half beam angle 24°
By changing the diffuser lense it is possible to alter the symmetrical light distribution into a wide beam or flat beam light distribution.
For wide beam light distribution:
Diffuser lens **10043**, half beam angle 38°
For flat beam light distribution:
Diffuser lens **10014**, half beam angle 20°/53°
Light cone $\pm 90^\circ$ rotatable.

Article No. 12 119.1

LED colour temperature optionally 3000 K or 4000 K
3000 K – Article number + **K3**
4000 K – Article number + **K4**

Accessories

Power supply units for LED luminaires 220-240 V · 0/50-60 Hz with strain relief and plug connector system.

13 144 Power supply unit on/off
13 169 Power supply unit DALI

The power supply units are only suitable for the operation of one LED luminaire.

10 441 Installation housing

10 043 Exchangeable lens wide beam
10 014 Exchangeable lens flat beam

For the accessories a separate instructions for use can be provided upon request.