

**BEGA****12 118.1**

Recessed ceiling luminaire for indoor use



Project · Reference number

Date

## Product data sheet

### Application

LED recessed ceiling luminaire with adjustable light distribution. A remote power supply unit is required to operate this luminaire. If this luminaire should be integrated into a LCN or Zigbee controlled building management system we recommend our BEGA Control light control system.

### Product description

Recessed LED luminaire without power supply unit  
Luminaire housing made of aluminium alloy  
Metal cover ring  
Finish white enamel  
Safety glass with optical structure  
Silicone gasket  
Reflector  
Luminaire housing with 2 fixing claws and guide screws  
Recessed opening  $\varnothing$  97 mm  
Recessed depth required 100 mm  
1 connecting cable with strain relief and plug connector system for BEGA power supply unit, on/off or DALI  
Safety class III   
Impact strength IK06  
Protection against mechanical impacts < 1 joule  
**CE** – Conformity mark  
Weight: 0.35 kg

### Lamp

Module connected wattage	3 W
Luminaire connected wattage	4.6 W
Rated temperature	$t_a = 25^\circ\text{C}$
Ambient temperature	$t_{a\text{max}} = 45^\circ\text{C}$
When installed in heat-insulating material	$t_{a\text{max}} = 35^\circ\text{C}$

### 12 118.1 K3

Module designation	LED-0444/930
Colour temperature	3000 K
Colour rendering index	CRI > 90
Module luminous flux	445 lm
Luminaire luminous flux	306 lm
Luminaire luminous efficiency	66,5 lm/W

### 12 118.1 K4

Module designation	LED-0444/940
Colour temperature	4000 K
Colour rendering index	CRI > 90
Module luminous flux	460 lm
Luminaire luminous flux	316 lm
Luminaire luminous efficiency	68,7 lm/W

### Service life of the LED

Ambient temperature  $t_a = 25^\circ\text{C}$   
– at 423,000h: L70B50

max. ambient temperature  $t_a = 45^\circ\text{C}$   
– at 226,000h: L70B50

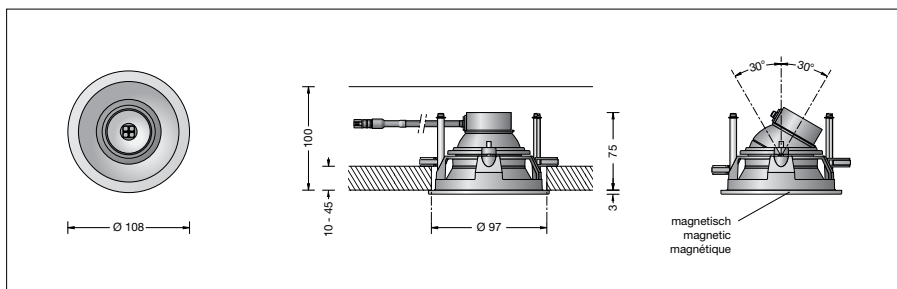

### Light technique

Recessed luminaire with adjustable optical system.  
Optical system 0-30° swivel-mounted and  $\pm 180^\circ$  infinitely rotatable.  
Narrow beam rotationally symmetrical light distribution. Half beam angle 30°  
For special lighting applications, it is possible to alter the symmetrical light cone to create wide beam or flat beam light distribution by changing the cover glass.  
For wide beam light distribution:  
Diffuser lens **10042**, half beam angle 45°  
For flat beam light distribution:  
Diffuser lens **10013**, half beam angle 32°/60°  
Light cone  $\pm 90^\circ$  rotatable.

### Article No. 12 118.1

LED colour temperature optionally 3000 K or 4000 K  
3000 K – Article number + **K3**  
4000 K – Article number + **K4**

### Accessories

Power supply units for LED luminaires 220-240 V · 0/50-60 Hz with strain relief and plug connector system.

**13 144** Power supply unit on/off  
**13 169** Power supply unit DALI

The power supply units are only suitable for the operation of one LED luminaire.

**10 440** Installation housing

**10 042** Exchangeable lens wide beam  
**10 013** Exchangeable lens flat beam

For the accessories a separate instructions for use can be provided upon request.