

- PENDANTS: one
- MOUNTING: pearl chrome metal mounting plate 114mm (4.5") in diameter
- LAMPING: 1w LED
- INSTALLATION: threaded on - wall or ceiling mount
- MATERIALS: blown glass, copper mesh, electrical components, metal mounting plate
- WEIGHT: approximately 0.7kg (1.5lb)
- TRANSFORMERS: integral (transformer housed within junction box). Transformers included

**DESCRIPTION**

The 'sp' designation in this variation on the 76 refers to it being surface-mounted, with a mounting plate large enough to cover a standard North American junction box. This surface light has a paintable 114mm (4.5") in diameter mounting plate designed to be mounted on walls as well as ceilings.

A vacuum is introduced to a strata composed of hot white and clear glass with copper mesh between. The vacuum causes the white layer to pull away through the embedded mesh, leaving numerous tendrils of white glass suspended within an interstitial space as it goes.

**NOTES**

- + Purchase replacement lamps online at [www.bocci.ca/lamps](http://www.bocci.ca/lamps)
- + Unless otherwise specified, a single class 2 transformer will be sent for every 15 LED fixtures
- + Requires transformers to be remote mounted.

US Patent # D817,524 S  
 EU Design Patent # 002840975-0004-0007

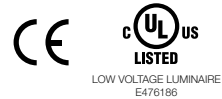

Made in Vancouver, Canada

Vancouver	Berlin
<a href="mailto:sales@bocci.ca">sales@bocci.ca</a>	<a href="mailto:europa@bocci.ca">europa@bocci.ca</a>
<a href="http://www.bocci.ca">www.bocci.ca</a>	<a href="http://www.bocci.ca">www.bocci.ca</a>

approx 0.7kg (1.5lb)

SURFACE LIGHT - PRINTABLE LARGE PLATE

**76sp** Design by Omer Arbel  
 PRODUCT SPECIFICATION



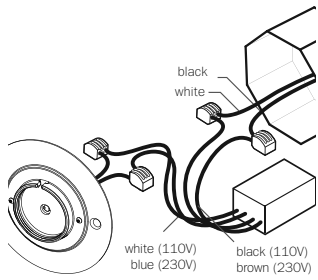

1

The 76sp can be directly mounted to a junction box.

Connect the black wire to black and white wire to white wire.

Join transformer wiring to cover plate wiring using connectors provided.

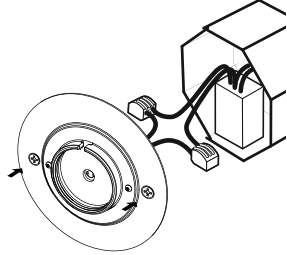

2

Tuck the transformer and wiring into the octagonal box. Lining up the fastener holes. Affix surface mounted plate with fasteners provided.

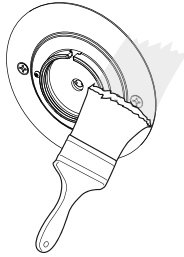

3

Paint over the cover plate to match the wall finish.

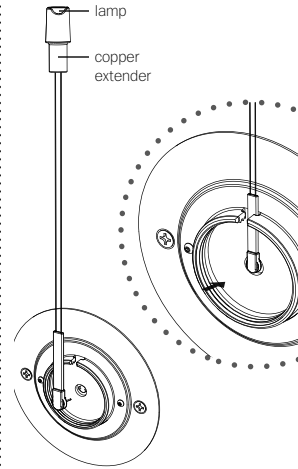

4

Bocci 1w LED lamp included.

Insert LED lamp into flexible copper extender.

Push the flexible copper extender wires through the open slot on the sconce plate and plug end into the sconce socket.

Purchase replacement lamps online at [www.bocci.ca/lamps](http://www.bocci.ca/lamps)

Note: when using a dimmer use only low voltage electronic dimmers to ensure the fixture works properly.

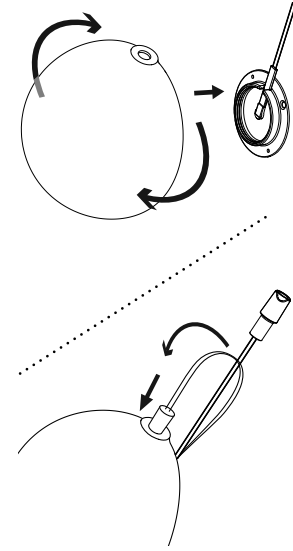

5

Hold lamp wires against the wall to ensure they do not interfere with spinning glass.

Gently thread glass hemisphere onto cover plate. Do not over tighten.

Bend the insulated wires and insert the lamp into the small hole in the pendant. Ensure that the lamp does not touch the inner glass bubble.

Note: when using a dimmer use only low voltage electronic dimmer.

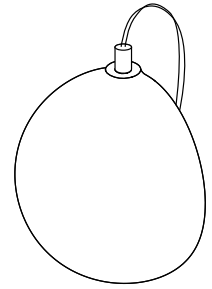

6

Clean fingerprints from glass surfaces.

Turn fixture on.

For additional assistance, please contact Bocci:

Vancouver  
sales@bocci.ca  
[www.bocci.ca](http://www.bocci.ca)

Berlin  
europe@bocci.ca  
[www.bocci.ca](http://www.bocci.ca)

US Patent Pending

EU Design Patent # 002840975-0004-0007

Made in Vancouver, Canada



76sp

Design by Omer Arbel  
PRODUCT INSTALLATION INSTRUCTIONS

© 2018, Bocci Design and Manufacturing Inc. All rights reserved. Any inquiries should be directed to: [info@bocci.ca](mailto:info@bocci.ca)

**BOCCI**