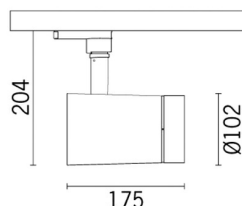

Last information update: May 2018

**small body - Neutral White - DALI - spot optic****Product code**

P626

**Technical description**

Adjustable spotlight with adapter for installation on mains voltage track for high-performance LED with monochromatic Neutral White (4,000K) emission. DALI ballast built-into product. The fitting is made of die-cast aluminium and thermoplastic material. It enables 360° rotation around the vertical axis and 90° inclination with respect to the horizontal plane. It is provided with mechanical locks for orientation, for both rotations, which are applied by using the same tool on two screws, one in lateral position to the rod and one on the track adapter. Passive cooling system. Spotlight able to house up to two flat accessories at the same time. One further external component can be applied, either directional flaps or anti-glare screen. All the external accessories can be rotated by 360° with respect to the longitudinal axis of the spotlight.

**Installation**

Mounted on electrified track on dedicated base

**Dimension (mm)**

Ø102x204

**Colour**

White (01) | Black (04)

**Weight (Kg)**

1.28

**Mounting**

three circuit track

**Wiring**

DALI components contained within the fitting

Complies with EN60598-1 and pertinent regulations

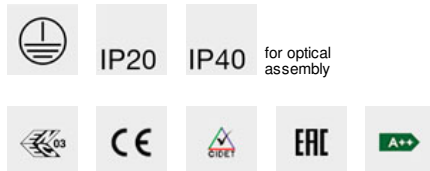
**Product configuration: P626****Product characteristics**

Total lighting output [Lm]: 2208  
 Total power [W]: 24  
 Luminous efficacy [Lm/W]: 92  
 Number of optical assemblies: 1

Total luminous flux at or above an angle of 90° [Lm]: 0  
 Emergency luminous flux [Lm]: /  
 Voltage [V]: -

**Optical assembly Characteristics Type 1**

Light Output Ratio (L.O.R.) [%]: 74  
 Lamp code: LED  
 ZVEI Code: LED  
 Nominal power [W]: 24  
 Nominal luminous [Lm]: 3000  
 Lamp maximum intensity [cd]: /  
 Beam angle [°]: 12°

Number of lamps for optical assembly: 1  
 Socket: /  
 Ballast losses [W]: 0  
 Colour temperature [K]: 4000  
 CRI: 80  
 Wavelength [Nm]: /  
 MacAdam Step: 2

**Polar**

