

## Front Light

Design iGuzzini

iGuzzini

Last information update: May 2018

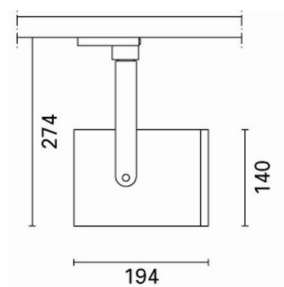

### Spotlight - Large body - LED Warm White - Electronic ballast - Spot Optic

#### Product code

MK85

#### Technical description

Adjustable spotlight with adapter for installation on a mains voltage track. Luminaire made of die-cast aluminium. Spotlight double adjustability allows a 360° rotation about the vertical axis and 90° tilting relative to the horizontal plane. Mechanical aiming locks both for rotation about the vertical axis and tilting relative to the horizontal plane. Equipped with ballast. The luminaire comes complete with LED unit with spot optic in a neutral white tone.

#### Installation

On an electrified track

#### Dimension (mm)

Ø140x194

#### Colour

White (01) | Black (04) | Grey/Black (74)

#### Weight (Kg)

2

#### Mounting

three circuit track

#### Wiring

Electronic components housed in the luminaire

Complies with EN60598-1 and pertinent regulations



IP20

IP40

for optical assembly



CE



EAC



#### Product configuration: MK85

#### Product characteristics

Total lighting output [Lm]: 3983  
Total power [W]: 35.5  
Luminous efficacy [Lm/W]: 112.2  
Life Time: > 50,000h - L80 - B10 (Ta 25°C)

Total luminous flux at or above an angle of 90° [Lm]: 0  
Emergency luminous flux [Lm]: /  
Voltage [V]: -  
Number of optical assemblies: 1

#### Optical assembly Characteristics Type 1

Light Output Ratio (L.O.R.) [%]: 79  
Lamp code: LED  
ZVEI Code: LED  
Nominal power [W]: 33  
Nominal luminous [Lm]: 5050  
Lamp maximum intensity [cd]: /  
Beam angle [°]: 16°

Number of lamps for optical assembly: 1  
Socket: /  
Ballast losses [W]: 2.5  
Colour temperature [K]: 3000  
CRI: 80  
Wavelength [Nm]: /  
MacAdam Step: 2

**Polar**

