

September 2012

Metro - Projector 100 W PAR 30S**Product code:**

4878

Technical description:

Projector for interiors made up of reinforced-plastic cradle, lamp-holding ring and diecast-aluminium lamp-holding cover. Application to electrified track by three-phase adaptor. The mechanical locking system to point the light is placed at one end of the cradle and permits changing the inclination of the projector by about 100° perpendicularly to the horizontal axis. The projector can also be rotated by about 340° around the vertical axis. Several accessories may be installed by a special ring to be ordered separately. IP40 for optical assembly with optional glass diffusers.

Installation:

Fitted to electrified track through a three-phase adaptor.

Dimension:

134x234mm

Colour:

White (01)|Grey/Black (74)

Weight [Kg]:

0,49

Mounting:

Three circuit track

Wiring:

Mains voltage.

Notes:

For the photometric data of the fitting refer to the photometric data of the light sources used.

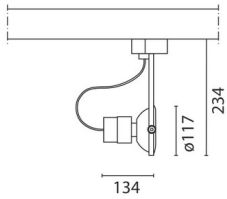

Complies with EN605981 and pertinent regulations

