

September 2012

**Trimmer - Projector with electronic control gear 40° 150W HIT**

**Product code:**

2725

**Technical description:**

Luminaire for 1x150W HIT discharge lamp. Made up of power supply box, adapter for mains voltage electrified tracks, support arm and optical assembly. The power supply box is composed of a diecast aluminium bearing base with the electrical components for discharge lamps, moulded polycarbonate cover with 850° NF C20 paint finish, aluminium mechanical fixing system with screw and helicoidal spring for correct positioning. The support arm is made up of two diecast aluminium elements joined with M3 screws and houses the power supply cable for the lamp. The diecast aluminium optical assembly is joined to the lower end of the arm with M5 screws on conic steel washers. It can be inclined by 100° with screw locking device and rotated by 340° about the vertical axis with continuous friction and screw locking device. 99.85% superpure aluminium optics with polishing and sandblasting finish and PPS multigrooves.

**Installation:**

On iGuzzini mains voltage electrified tracks. Compatible with Erco, Nokia, Staff and Hoffmaister tracks.

**Dimension:**

328x300mm

**Colour:**

White (01)|Black (04)|Grey (15)

**Mounting:**

Three circuit track

**Wiring:**

Electrical components for discharge lamps contained inside the box integrated to the luminaire.

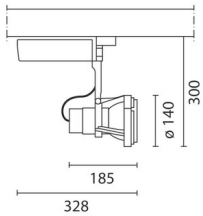

Complies with EN605981 and pertinent regulations

