

September 2012

Trimmer - Spotlight w/dimmable electronic transformer 50W 12 V QR 111

Product code:
2721

Technical description:

Luminaire for 1x50W QR 111 low voltage halogen lamp. Made up of dimmable electronic transformer, adapter for mains voltage electrified tracks, support arm and optical assembly. The support arm is made up of two diecast aluminium elements joined with M3 screws and houses the power supply cable for the lamp. The diecast aluminium optical assembly is joined to the lower end of the arm with M5 screws on conic steel washers. It can be inclined by 100° with screw locking device and rotated by 340° about the vertical axis with continuous friction and screw locking device.

Installation:

On iGuzzini mains voltage electrified tracks.

Dimension:

103x266mm

Colour:

White (01)|Black (04)|Grey (15)

Mounting:

Three circuit track

Wiring:

Dimmable electronic transformer.

Notes:

For the photometric data of the luminaire refer to the photometric characteristics of the light sources used.

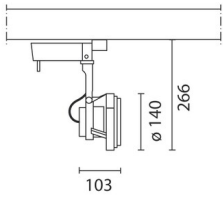

Complies with EN605981 and pertinent regulations

